

Householder Planning Application

Application No.

Date received

Fee paid £

Receipt No.

320070486P

Town and Country Planning Act 1990

You may use this form to apply for planning permission to alter or extend your house or erect a building within the boundary. For any other Planning Application use form P1.

Please read the notes overleaf and then answer all the following questions:

Question 1

Your Name and Address

Mr & Mrs K Davidson
Edencroft
Hesketh Lane
Chipping
Postcode PR3 2TH
Tel. No: 01993 61257

Question 1a

The Name and Address of any person acting for you

AC Architectural Consultancy
Hazelwells Building
Station Road
Bamber Bridge
Preston
PR5 6TT

01772 336570

Question 2

Describe the proposed work and state the location if different from your address

Extension and refurbishment of existing dwelling

Postcode

Question 3

Please state the main proposed external materials (for example, brick walls, colour, make, type) and show them on your detailed plan.

Walls - render to match existing Roof - slate to match existing

Question 4

Do you intend to demolish any buildings?
If YES, please show them on your detailed plan.

Please state Yes or No

No

Question 5

Do you intend to construct any new access to a road or back street or alter an existing one? If YES, please show it on your detailed plan.

No

Question 6

Are there any trees on the site?
If YES, please show them on the detailed plan.

No

Question 7

Are any trees to be felled?
If YES, please show which on the detailed plan.

No

Question 8

Please read and sign the following statements.

I wish to apply for planning permission for the development described in this application and the accompanying plans and enclose the fee of £135

Signed

Andrew Cross (Applicant/Agent)

Date 10.05.07

Certificate under Article 7 Town and Country Planning (General Development Procedure) Order 1995
Certificate A

I certify that on the day 21 days before the date of the accompanying application nobody, except the applicant was the owner of any part of the land to which the application relates.

None of the land to which the application relates is, or is part of, an agricultural holding

10.05.07

EDENCROFT, HESKETH LANE, CHIPPING

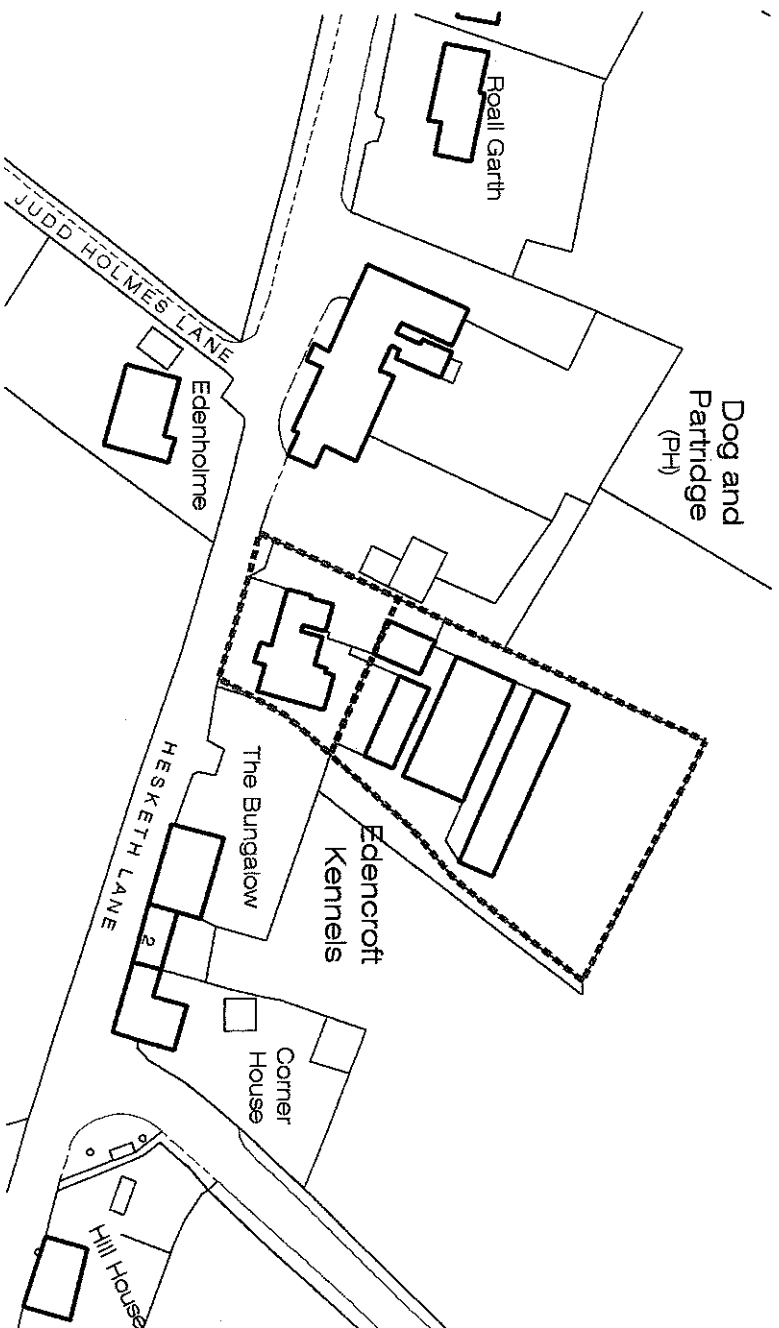

LOCATION PLAN 1:1250

32007070023