

This Drawing is the property of H.I.M. Associates. It must not be reproduced in part or whole nor the design used without written consent.

KEY:

- + 146.87 EXISTING LEVELS
- + 147.10 PROPOSED LEVELS
-  FILLED AREAS OVER PIPES

NOTES:

1. LEVELS SHOWN ON THIS DRAWING ARE IN METRES AND RELATE TO A LOCAL DATUM.
2. THIS DRAWING IS TO BE READ IN CONJUNCTION WITH DRAWINGS P2153/17/18/25/27/28 AND 29.

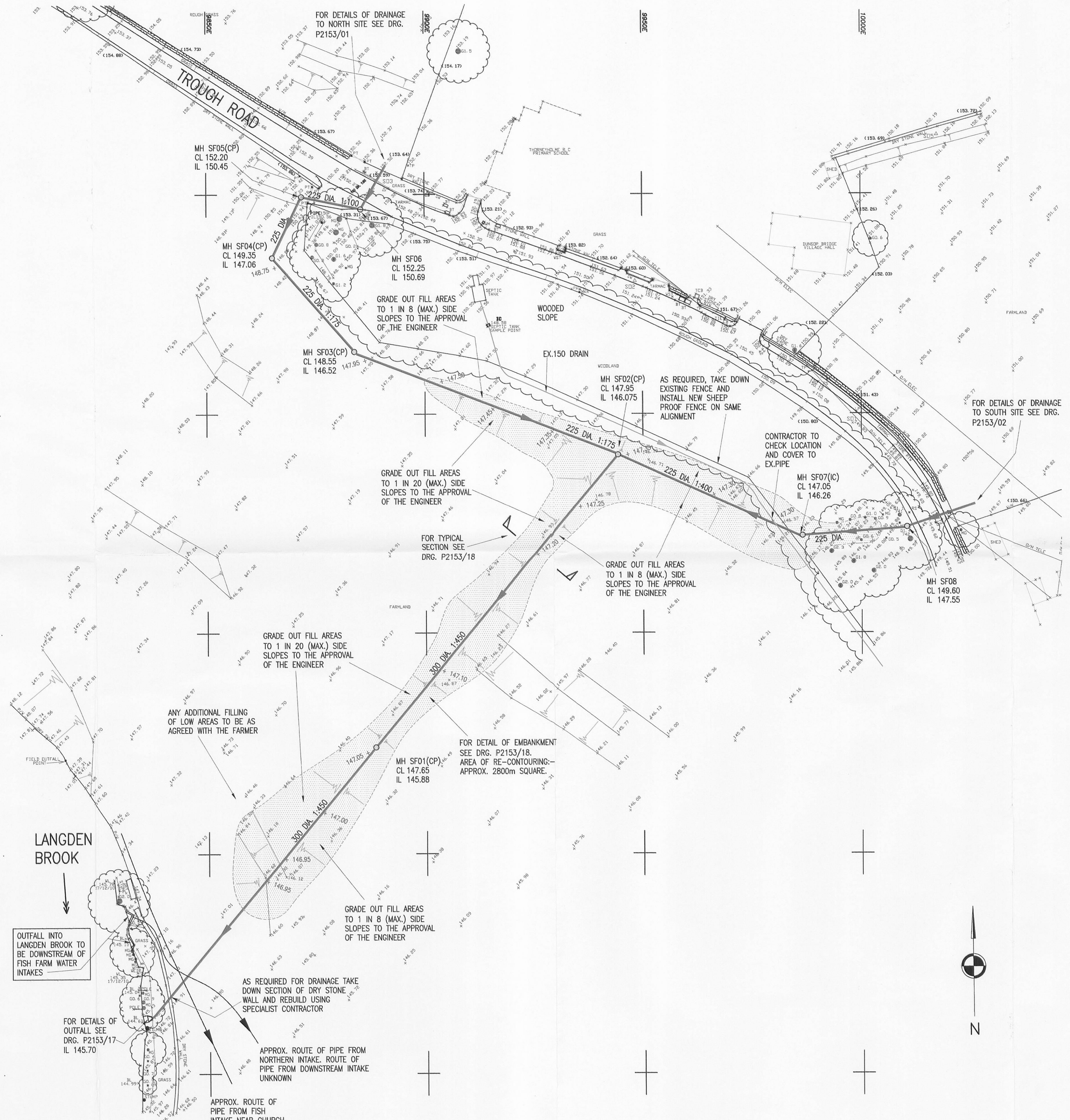

320110947P

B	ISSUED FOR CONSTRUCTION. INVERTS AMENDED, 2 MHS, PROPOSED LEVELS, EXTENT OF FILL BOUNDARY ADDED.	DM OCT 11	RD OCT 11
	A	ISSUED FOR COSTING	RD AUG 11 DM AUG 11
REV.	DETAILS	DRAWN DATE	CHECKED DATE
DRAWING RECORD			

H.I.M. ASSOCIATES
 CIVIL & STRUCTURAL ENGINEERS
 136-138 Victoria Road
 Walton-le-Dale
 PRESTON PR5 4AU
 Tel 01772 498007 Fax 01772 498008
 E-mail engineer@himconsult.co.uk
 Website himconsult.co.uk

JOB TITLE
**DUKE OF LANCASTER
 DUNSOP BRIDGE**

DRAWING TITLE
**PROPOSED DRAINAGE LAYOUT
 TROUGH ROAD TO OUTFALL:
 GRAVITY OPTION**

SCALE 1:500 @ A1 DRAWN BY RD DATE JAN 11

JOB / DRAWING NUMBER P2153/24 REVISION AA