

RE-ORIENT,
TENNIS CO

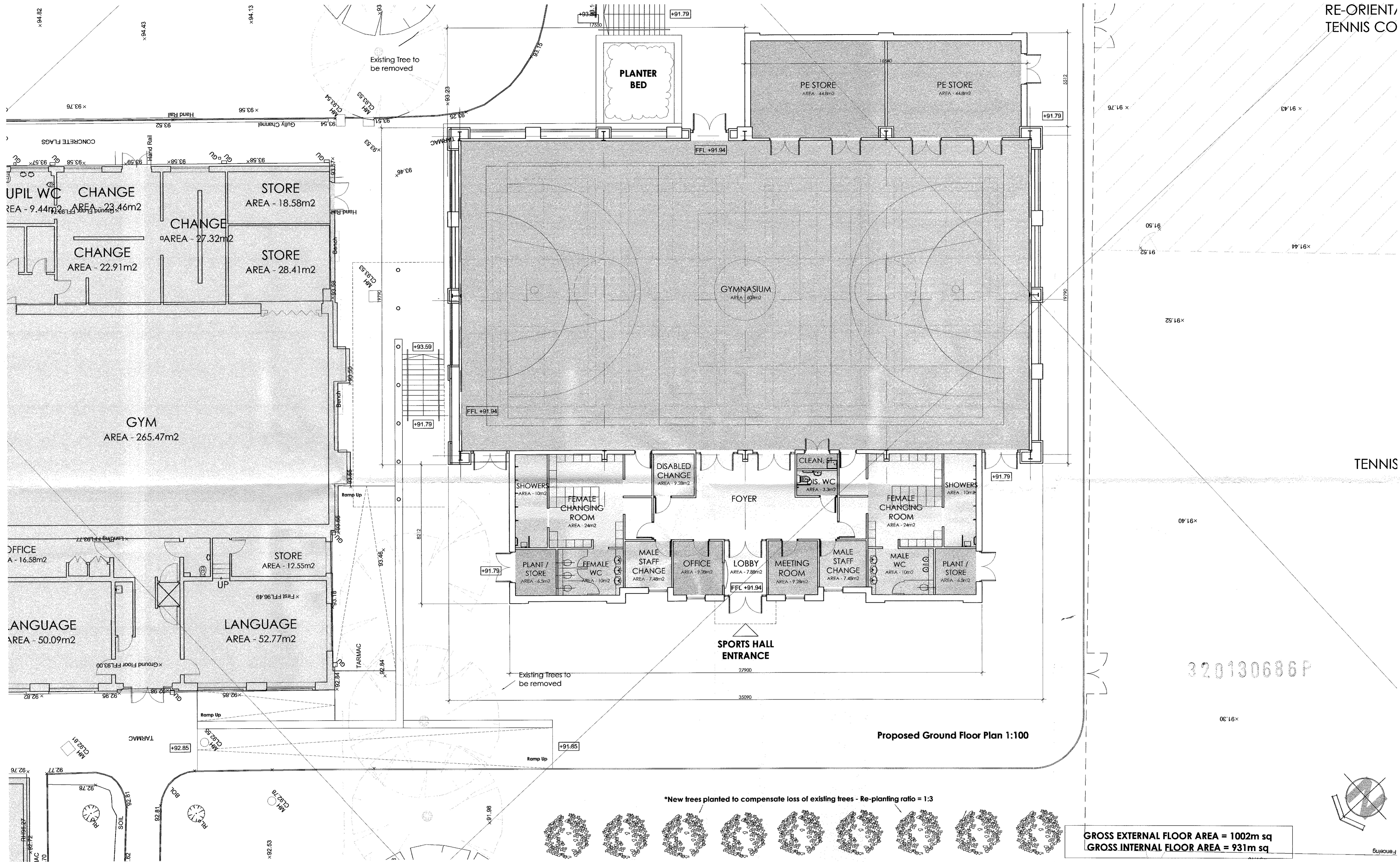

Proposed Ground Floor Plan 1:100

*New trees planted to compensate loss of existing trees - Re-planting ratio = 1:3

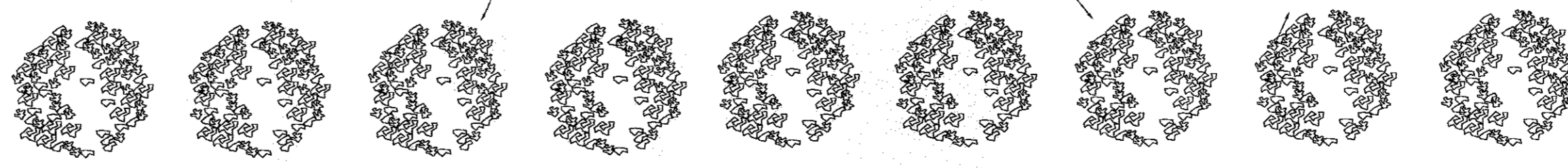

GROSS EXTERNAL FLOOR AREA = 1002m sq
GROSS INTERNAL FLOOR AREA = 931m sq

Rev.	Dimensions added	Initials	Date	Rev.	Initials	Date
A	Dimensions added	DB	27.03.12			
B	Building moved 7.7m to the South East	FM	206.12			

Initials	Date	Notes
		1. This drawing is subject to copyright and is not to be reproduced in part or whole without approval.
		2. Do not scale this drawing - Check all dimensions on site.
		Checked by:

Notes:
1. This drawing is subject to copyright and is not to be reproduced in part or whole without approval.
2. Do not scale this drawing - Check all dimensions on site.
Checked by:

Project Clitheroe Royal Grammar School - Chatburn Road	Client School Governors
Dwg Title PROPOSED GROUND FLOOR PLAN	Drawn DB
Date DEC 2011	Dwg No. 7999
Scale 1:100	Rev. L115 B
CASSIDY + ASHTON Architects Building Surveyors Planners Designers www.cassidyashton.co.uk coabs@cassidyashton.co.uk	
7 East Cliff Preston Lancashire PR1 3JE Tel: 01772 258356 Fax: 01772 825000 1 Regency Chambers Jubilee Way Bury Greater Manchester M9 0SP Tel: 0161 762 5800 Fax: 0161 762 5801 Cheah's House Corsey Lane Wigan WA9 0SP Tel: 0151 4236914 Fax: 0151 4236915	