



RIBBLE VALLEY
BOROUGH COUNCIL

320130959P

For office use only

Application No.

Date received

Fee paid £

Receipt No:

Council Offices, Church Walk, Clitheroe, Lancashire. BB7 2RA Tel: 01200 425111 www.ribblevalley.gov.uk

Application for listed building consent for alterations, extension or demolition of a listed building.
Planning (Listed Buildings and Conservation Areas) Act 1990

You can complete and submit this form electronically via the Planning Portal by visiting www.planningportal.gov.uk/apply

Publication of applications on planning authority websites

Please note that the information provided on this application form and in supporting documents may be published on the authority's website. If you require any further clarification, please contact the Authority's planning department.

Please complete using block capitals and black ink.

It is important that you read the accompanying guidance notes as incorrect completion will delay the processing of your application.

1. Applicant Name and Address

Title: First name:

Last name:

Company (optional):

Unit: House number: House suffix:

House name:

Address 1:

Address 2:

Address 3:

Town:

County:

Country:

Postcode:

2. Agent Name and Address

Title: First name:

Last name:

Company (optional):

Unit: House number: House suffix:

House name:

Address 1:

Address 2:

Address 3:

Town:

County:

Country:

Postcode:

3. Description of Proposed Work

Please describe the proposals to alter, extend or demolish the listed building(s):

Roof - storm damaged in 1990s - repaired to avoid further damage to property.

Damp course - installed as required ie house
lamp - D.P.C. has kept property free of damp
for 21 years. - re. surveyor,

retrospective

3. Description of Proposed Work (continued)

Has the work already started without consent?

☒ Yes ☐ No

If Yes, please state when the work was started (DD/MM/YYYY):

Dump Course
23/7/92.

Roof 1990s.

(date must be pre-application submission)

Has the work been completed without consent?

☒ Yes ☐ No

If Yes, please state the date when the work was completed (DD/MM/YYYY):

23/7/92. Dump Course.
1990s Roof.

(date must be pre-application submission)

5. Related Proposals

Are there any current applications, previous proposals or demolitions for the site?

☒ Yes ☐ No

If Yes please describe and include the planning application reference number(s), if known:

Description	Reference number
replacement windows.	3/2013/0919/

7. Neighbour and Community Consultation

Have you consulted your neighbours or the local community about the proposal?

☐ Yes ☒ No

If Yes, please provide details:

4. Site Address Details

Please provide the full postal address of the application site.

Unit:

House number:

38

House suffix:

House name:

Address 1: Higher Rd.

Address 2:

Address 3:

Town:

Longridge

County:

Lancashire

Postcode (optional):

PR3 3SX

Description of location or a grid reference. (must be completed if postcode is not known):

Easting:

Northing:

Description:

6. Pre-application Advice

Has assistance or prior advice been sought from the local authority about this application?

☒ Yes ☐ No

If Yes, please complete the following information about the advice you were given. (This will help the authority to deal with this application more efficiently).

Please tick if the full contact details are not known, and then complete as much as possible:

Officer name:

A DOWD

Reference:

Date (DD/MM/YYYY):

(must be pre-application submission)

04/Nov

Details of pre-application advice received?

2013.

8. Authority Employee / Member

With respect to the Authority, I am:

Do any of these statements apply to you?

- (a) a member of staff
(b) an elected member
(c) related to a member of staff
(d) related to an elected member

☐ Yes ☒ No

If Yes, please provide details of the name, relationship and role

9. Materials

Please provide a description of existing and proposed materials and finishes to be used in the building (demolition excluded):

	Existing (where applicable)	Proposed	Not applicable	Don't Know
External walls			<input type="checkbox"/>	<input type="checkbox"/>
Roof covering	Storm damaged, impervious, had to be repaired.	—	<input type="checkbox"/>	<input type="checkbox"/>
Chimney			<input type="checkbox"/>	<input type="checkbox"/>
Windows			<input type="checkbox"/>	<input type="checkbox"/>
External doors			<input type="checkbox"/>	<input type="checkbox"/>
Ceilings			<input type="checkbox"/>	<input type="checkbox"/>
Internal walls			<input type="checkbox"/>	<input type="checkbox"/>
Floors			<input type="checkbox"/>	<input type="checkbox"/>
Internal doors			<input type="checkbox"/>	<input type="checkbox"/>
Rainwater goods			<input type="checkbox"/>	<input type="checkbox"/>
Boundary treatments (e.g. fences, walls)			<input type="checkbox"/>	<input type="checkbox"/>
Vehicle access and hard standing			<input type="checkbox"/>	<input type="checkbox"/>
Lighting			<input type="checkbox"/>	<input type="checkbox"/>
Others (add description)	Damp course, electro osmosis	—	<input type="checkbox"/>	<input type="checkbox"/>

Are you supplying additional information on submitted drawings or plans?

☒ Yes

☐ No

If Yes, please state plan(s)/drawing(s) references:

10. Demolition

Does the proposal include the partial or total demolition of a listed building?

☐ Yes

☒ No

If Yes, which of the following does the proposal involve?

a) Total demolition of the listed building: ☐ Yes ☐ No

b) Demolition of a building within the curtilage of the listed building: ☐ Yes ☐ No

c) Demolition of a part of the listed building: ☐ Yes ☐ No

If the answer to c) is Yes:

i) What is the total volume of the listed building?(cubic metres)

ii) What is the volume of the part to be demolished?(cubic metres)

iii) What was the (approximate) date of the erection of the part to be removed? (MM/YYYY) (date must be pre-application submission)

Please provide a brief description of the building or part of the building you are proposing to demolish:

Why is it necessary to demolish or extend (as applicable) all or part of the building(s) and or structure(s)?

12. Listed Building Grading

Please state the grading (if known) of the building in the list of Buildings of Special Architectural or Historic interest? (Note: only one box must be ticked)

Grade I ☐

Ecclesiastical Grade I ☐

Grade II* ☒

Ecclesiastical Grade II* ☐

Grade II ☒

Ecclesiastical Grade II ☐

Don't know ☐

11. Listed Building Alterations

Do the proposed works include alterations to a listed building?

☒ Yes

☐ No

If Yes, do the proposed works include: (you must answer each of the questions)

a) Works to the interior of the building? ☒ Yes ☐ No

b) Works to the exterior of the building? ☒ Yes ☐ No

c) Works to any structure or object fixed to the property (or buildings within its curtilage) internally or externally? ☐ Yes ☒ No

d) Stripping out of any internal wall, ceiling or floor finishes (e.g. plaster, floorboards)? ☐ Yes ☒ No

If the answer to any of these questions is Yes, please provide plans, drawings, photographs sufficient to identify the location, extent and character of the items to be removed, and the proposal for their replacement, including any new means of structural support and state references for the plan(s)/drawing(s)

13. Immunity From Listing

Has a Certificate of Immunity from Listing been sought in respect of this building?

☐ Yes

☐ No

☒ Don't know

If Yes, please provide the result of the application:

14. Ownership Certificates

One Certificate A, B, C, or D, must be completed with this application form

CERTIFICATE OF OWNERSHIP - CERTIFICATE A

Regulation 6 of the Planning (Listed Buildings and Conservation Areas) Regulations 1990

certify/ The applicant certifies that on the day 21 days before the date of this application nobody except myself/ the applicant was the owner* of any part of the land or building to which the application relates.

* "owner" is a person with a freehold interest or leasehold interest with at least 7 years left to run.

Signed - Applicant:

Or signed - Agent:

Date DD/MM/YYYY):

E M Pollock

19/11/2013

CERTIFICATE OF OWNERSHIP - CERTIFICATE B

Regulation 6 of the Planning (Listed Buildings and Conservation Areas) Regulations 1990

certify/ The applicant certifies that I have/ the applicant has given the requisite notice to everyone else (as listed below) who, on the day 21 days before the date of this application, was the owner* of any part of the land or building to which this application relates

* "owner" is a person with a freehold interest or leasehold interest with at least 7 years left to run.

Name of Owner	Address	Date Notice Served

Signed - Applicant:

Or signed - Agent:

Date DD/MM/YYYY):

CERTIFICATE OF OWNERSHIP - CERTIFICATE C

Regulation 6 of the Planning (Listed Buildings and Conservation Areas) Regulations 1990

certify/ The applicant certifies that:

- Neither Certificate A or B can be issued for this application
- All reasonable steps have been taken to find out the names and addresses of the other owners* of the land or building, or of a part of it, but I have/ the applicant has been unable to do so.

* "owner" is a person with a freehold interest or leasehold interest with at least 7 years left to run.

The steps taken were:

Name of Owner	Address	Date Notice Served

Notice of the application has been published in the following newspaper (circulating in the area where the land is situated):

On the following date (which must not be earlier than 21 days before the date of the application):

Signed - Applicant:

Or signed - Agent:

Date DD/MM/YYYY):

14. Ownership Certificates (continued)

CERTIFICATE OF OWNERSHIP - CERTIFICATE D

Regulation 6 of the Planning (Listed Buildings and Conservation Areas) Regulations 1990

I certify/ The applicant certifies that:

- Certificate A cannot be issued for this application
- All reasonable steps have been taken to find out the names and addresses of everyone else who, on the day 21 days before the date of this application, was the owner* of any part of the land to which this application relates, but I have/ the applicant has been unable to do so.

* "owner" is a person with a freehold interest or leasehold interest with at least 7 years left to run.

The steps taken were:

Notice of the application has been published in the following newspaper (circulating in the area where the land is situated):

On the following date (which must not be earlier than 21 days before the date of the application):

Signed - Applicant:

Or signed - Agent:

Date DD/MM/YYYY

15. Planning Application Requirements - Checklist

Please read the following checklist to make sure you have sent all the information in support of your proposal. Failure to submit all information required will result in your application being deemed invalid. It will not be considered valid until all information required by the Local Planning Authority has been submitted.

The original and 3 copies of a completed and dated application form: ☐

The original and 3 copies of a plan which identifies the land to which the application relates and drawn to an identified scale and showing the direction of North: ☐

The original and 3 copies of other plans and drawings or information necessary to describe the subject of the application: ☐

The original and 3 copies of the completed dated Ownership Certificate (A, B, C, or D - as applicable): ☐

The original and 3 copies of a design and access statement, if required (see help text and guidance notes for details): ☐

16. Declaration

I/we hereby apply for planning permission/consent as described in this form and the accompanying plans/drawings and additional information. I/we confirm that, to the best of my/our knowledge, any facts stated are true and accurate and any opinions given are the genuine opinions of the person(s) giving them.

Signed - Applicant:

Or signed - Agent:

Date (DD/MM/YYYY):

E. R. I. W.

19/11/2012

(date cannot be earlier than 21 days before pre-application)

17. Applicant Contact Details

Telephone numbers

Country code: National number: Extension number:

Country code: Mobile number (optional):

Country code: Fax number (optional):

Email address (optional):

18. Agent Contact Details

Telephone numbers

Country code: National number: Extension number:

Country code: Mobile number (optional):

Country code: Fax number (optional):

Email address (optional):

19. Site Visit

Can the site be seen from a public road, public footpath, bridleway or other public land? ☐ Yes ☒ No

If the planning authority needs to make an appointment to carry out a site visit, whom should they contact? (Please select only one)

☐ Agent ☒ Applicant ☐ Other (if different from agent/applicant's details)

If Other has been selected, please provide:

Contact name: *Enid Pollard*

Telephone number:

07753420304

Email address:

H.M. LAND REGISTRY		TITLE NUMBER	
		LA 704245	
ORDNANCE SURVEY PLAN REFERENCE	SD 6037	SECTION V	Scale 1/1250 Enlarged from 1/2500
COUNTY LANCASHIRE	DISTRICT RIBBLE VALLEY		© Crown copyright 1989

320130959P

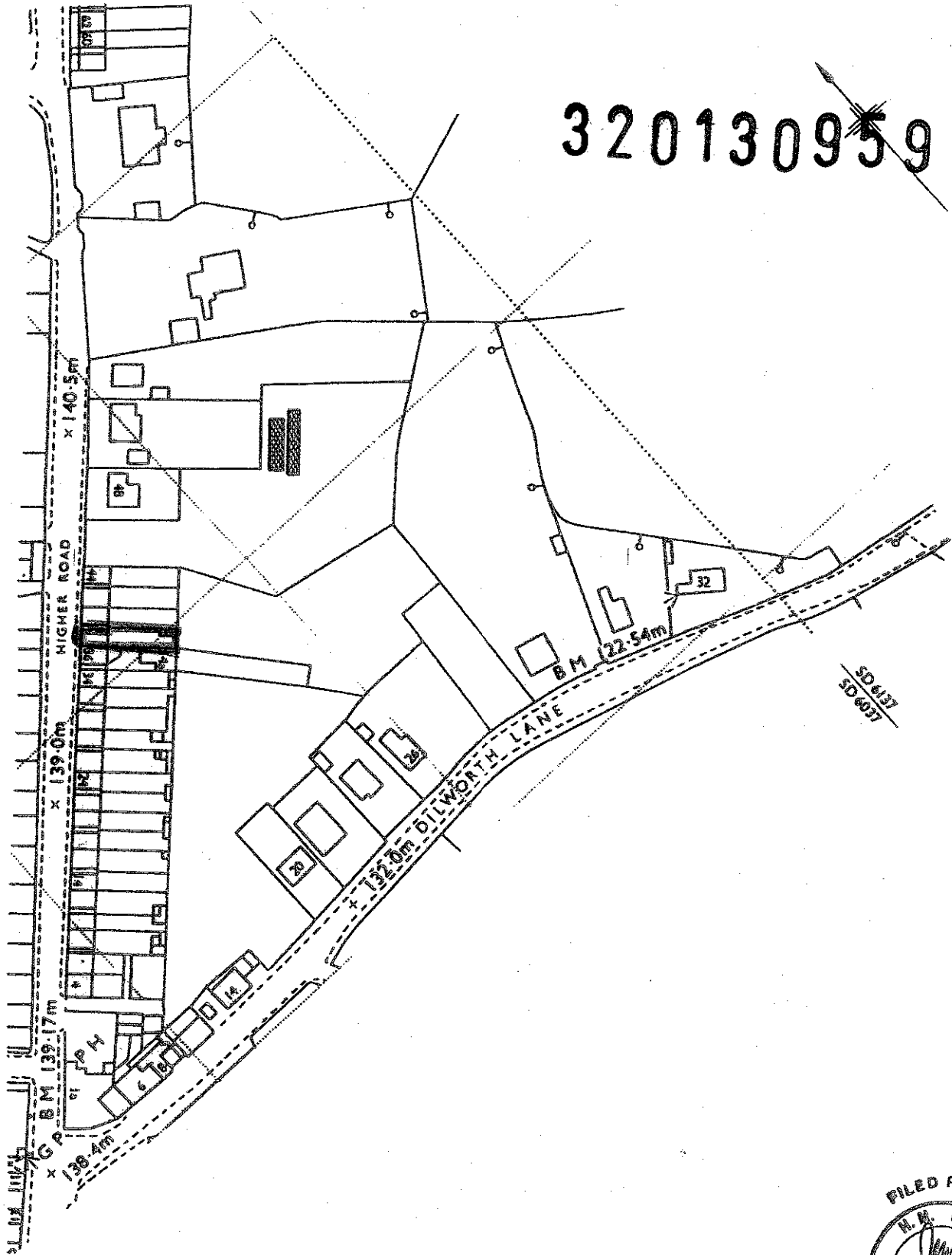

CERTIFICATE OF GUARANTEE



Acorn Building Services Ltd

Sefton Street, Leigh WN7 1LX
Telephone: Leigh (0942) 609966

Client: Mr E Pollard
Property: 38 Higher Road, Longridge, Preston, Lancs.
Date of completion: 8-9-92

This Guarantee is issued by Acorn Building Services Limited, in respect of the work carried out on the above named property by Acorn's operative in accordance with the estimate given to

the client on 23/7/92 KG/BD/8231 DPC

Acorn hereby GUARANTEES for a period of 20 years from the date of completion of the Rising Damp Treatment on the above Development will upon production of this certificate of Guarantee and the said estimate, at a mutually convenient time and without charge, expose and inspect the said Rising Damp Treatment and will then execute such further treatment and re-instatement work as is necessary to eradicate the Rising Damp.

The client shall retain any pre-existing rights at common law or by statute notwithstanding the terms of this Certificate of Guarantee, which shall be regarded as in addition to and not in diminution of such rights.

In the event of the sale of the property covered by this Guarantee, Acorn is prepared for the benefit of the remaining period of this Guarantee to be assigned to the purchaser and will recognise such purchaser as the person entitled to the benefit of this Guarantee.

AS B. B. R. Director

ACORN BUILDING SERVICES LTD.

320130959P

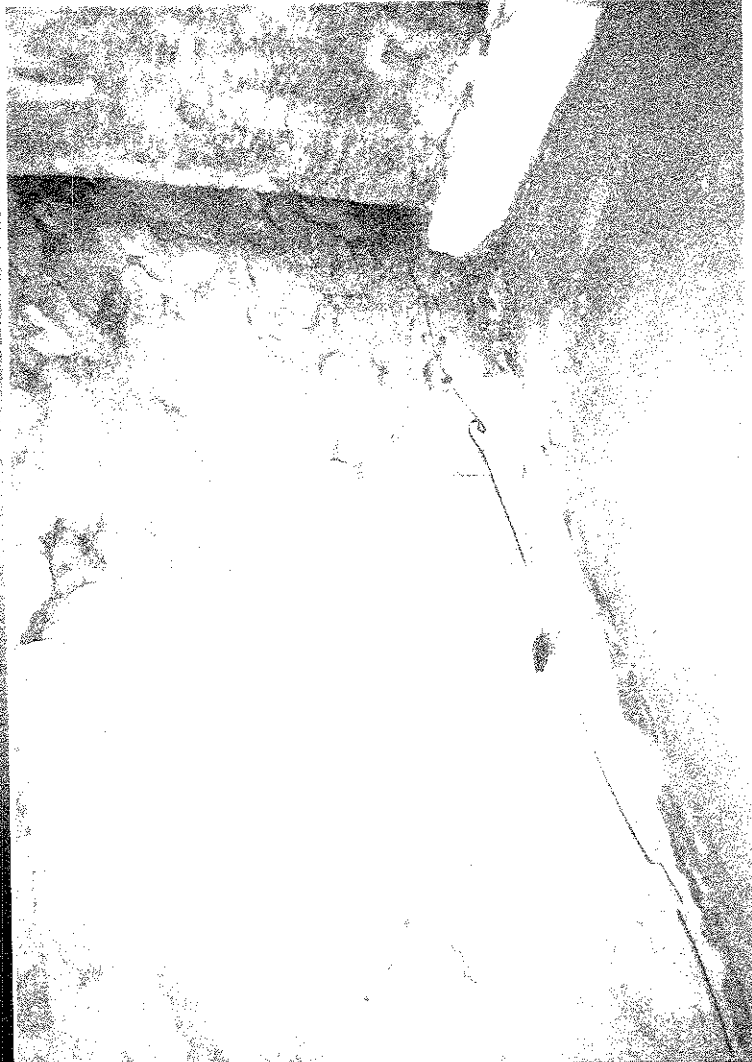

Ribble Valley Borough Council



DESIGN AND ACCESS STATEMENT PRO-FORMA

From the 10 August 2006, planning applications relating to certain types of developments are required to be submitted with a design and access statement. When submitting an application, failure to provide a design and access statement of sufficient standard may result in a delayed registration of the application.

What Applications Need to be Accompanied by a Design and Access Statement?

Most planning applications have to be accompanied by a design and access statement, the exceptions being:

- material change in the use of land or buildings, unless it also involves operational development;
- engineering or mining operations;
- development of an existing dwellinghouse, or development within the curtilage or a dwellinghouse for any purpose incidental to the enjoyment of the dwellinghouse, where no part of that dwellinghouse or curtilage is within a designated area or is a listed building. 'Designated Areas' include: • Conservation Areas; • Sites of Special Scientific Interest (SSSI); and • Areas of Outstanding Natural Beauty (AONB).

Process

What factors have you considered when deciding upon the use, design, scale, layout and materials used in the proposed development?

The replacement windows were chosen to match the previous ones. The previous windows had been replaced for others, as the the property is Georgian.

Use

What will the extension/development be used for and justify why this is necessary?

N/A

Amount

What is the proposed size of the extension/development and why is this necessary and appropriate for the setting of the development?

N/A

Layout

Why have you chosen the layout specified in the planning application and how did you eliminate alternative options?

N/A

Scale

Is the scale of the extension/development in keeping with the context of the site and in what way?

N/A

Landscaping

If appropriate, specify the boundary treatments and any landscaping included in the development. You may need to justify why certain materials or planting have been used?

N/A

Appearance

Specify how the extension/development fits in terms of its appearance and include details of materials to be used.

as near as possible the windows were replaced in keeping with the rest on terrace as they appear today.

Access

Explain how the extension/development will be accessed by vehicles and people. You should consider the need for access by all members of society and emergency vehicles.

N/A

The heritage statement.

The row of houses was built by a "building society" in 1795 to 1803.

The windows from the 1960's needed replacing in 2004 due to those soft-wood windows frames being rotten.

I replaced with hardwood frames in a style in keeping with the architecture of the row. Each house has individuality to reflect the original diverse ownership of the houses but my windows were chosen as the most suitable at that time to reflect the historical significance of the row.

I enclose photographs and map.

~~For~~