

All door and window openings to have Catnic type lintels fitted, stone to outer skin

150mm approx. stonework on bed outer leaf with 100mm concrete block backing wall, 50mm clear cavity 50mm Kingspan kooltherm K9 rigid urethane insulation or equivalent to give overall U* value of 0.3 WM2K or better, 150mm concrete block internal skin, stainless steel or heavy galvanised cavity ties (length to suit overall wall thickness), ties to be positioned at maximum 900mm horizontal centres and 450mm max. vertical centres, bond 12mm plaster board and plaster skim to internal finish.

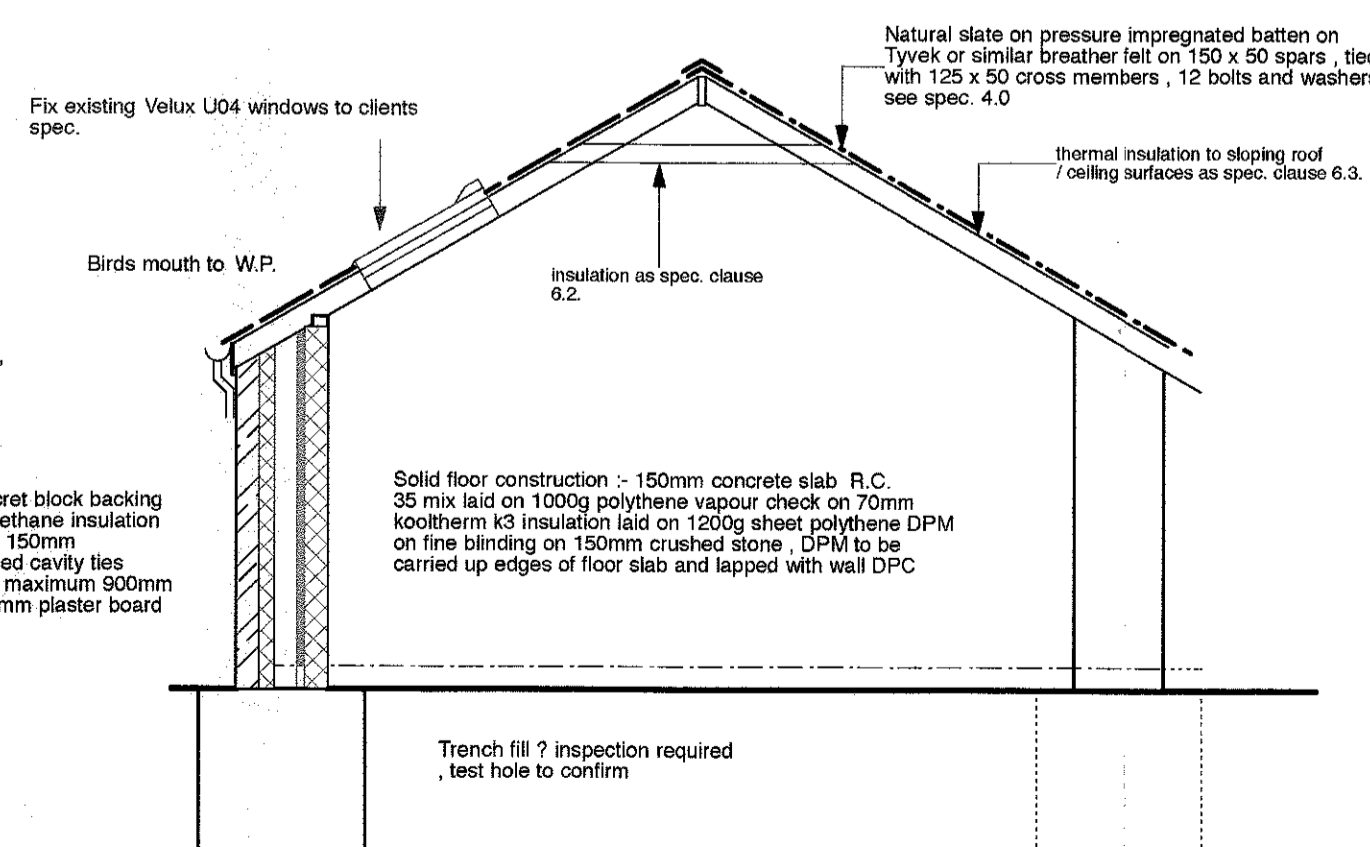

1100mm wide x 225 deep (minimum) gen 3 concrete strip foundation or trench fill, excavations to be approved by building control officer prior to placing concrete, see spec. 3.0

- 1/ This drawing to be read in conjunction with the specification reference Spec / D 973 / 14
- 2/ See beam calculations on separate sheet.
- 3/ Electrical safety - all electrical work associated with this extension shall be carried out in accordance with building regulation Part "P", refer also to specification section 13.0.
- 4/ For ventilation to kitchen see spec.8.0.

3 2014/0714/P
 NEWHEY LOFT CONVERSIONS
 LLOYD STREET SAW MILLS
 HIGHER LLOYD STREET
 DARWEN
 telephone 01254 706446

MR.MRS.DUNCAN JACKSON
 WILLOW HOUSE
 SLAIDBURN ROAD
 WADDINGTON BB7 3JJ

telephone 07939 014796
 drawing number D 973 / 14 / 02
 scale 1-50
 issue A date 5th February 2014
 drawn
 PROPOSED DETAIL