

## APPENDIX 2

### PLANNING STATEMENT

**SITE: LOUDSIDE COTTAGE, BACK LANE, CHIPPING, PRESTON PR3 2QA.**

**PROPOSAL: GLASS LINK EXTENSION, GARAGE, STABLE AND TACK ROOM**

### CONTAINMENT AND STORAGE OF MANURE.

It is proposed to contain manure from the stable in three composting bins on the north side of the stables as shown on the submitted site plan.

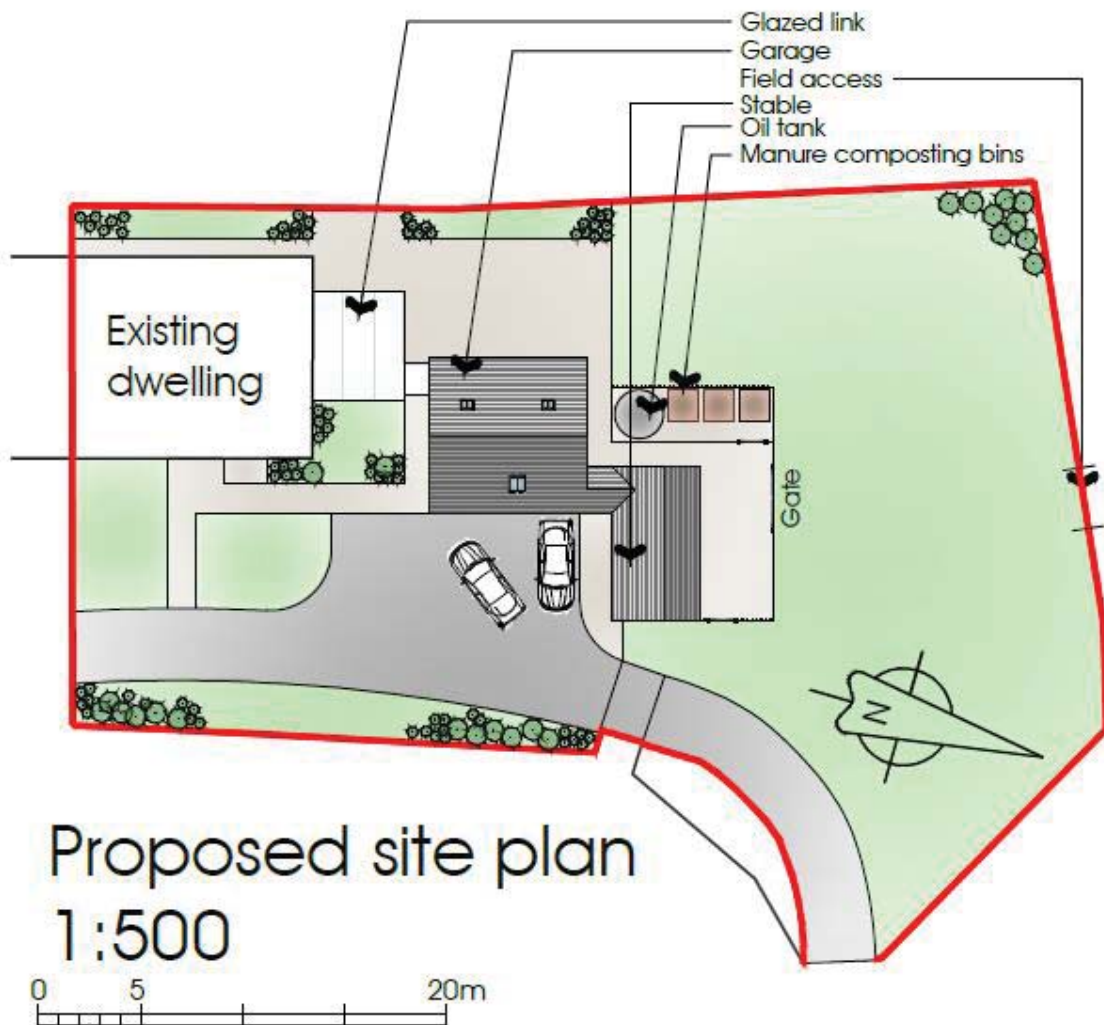

Proposed site plan

1:500

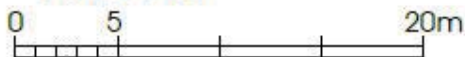

The composting bins are 1500 square x1200 high lidded timber storage containers giving min 8 months of clean composting (rubber matting instead of straw bedding used within the stable to limit bulk). Compost is then suitable for gardens when used with red worms to break it down. The bins are on a hardcore base to allow liquids to soakaway in the ground and strictly designed to prevent liquids from immediately entering any water course or drain.

The example shown in the photograph below was made using interlocking timber which build up in layers and are taken down in the same manner.



Judith Douglas  
Janet Dixon Town Planners Ltd  
June 2014.