

NOTES: All work shall be carried out in accordance with the requirements of the Lancashire County Council Specification For Construction of Estate Roads 2011 and to the satisfaction of the Highways Inspector.

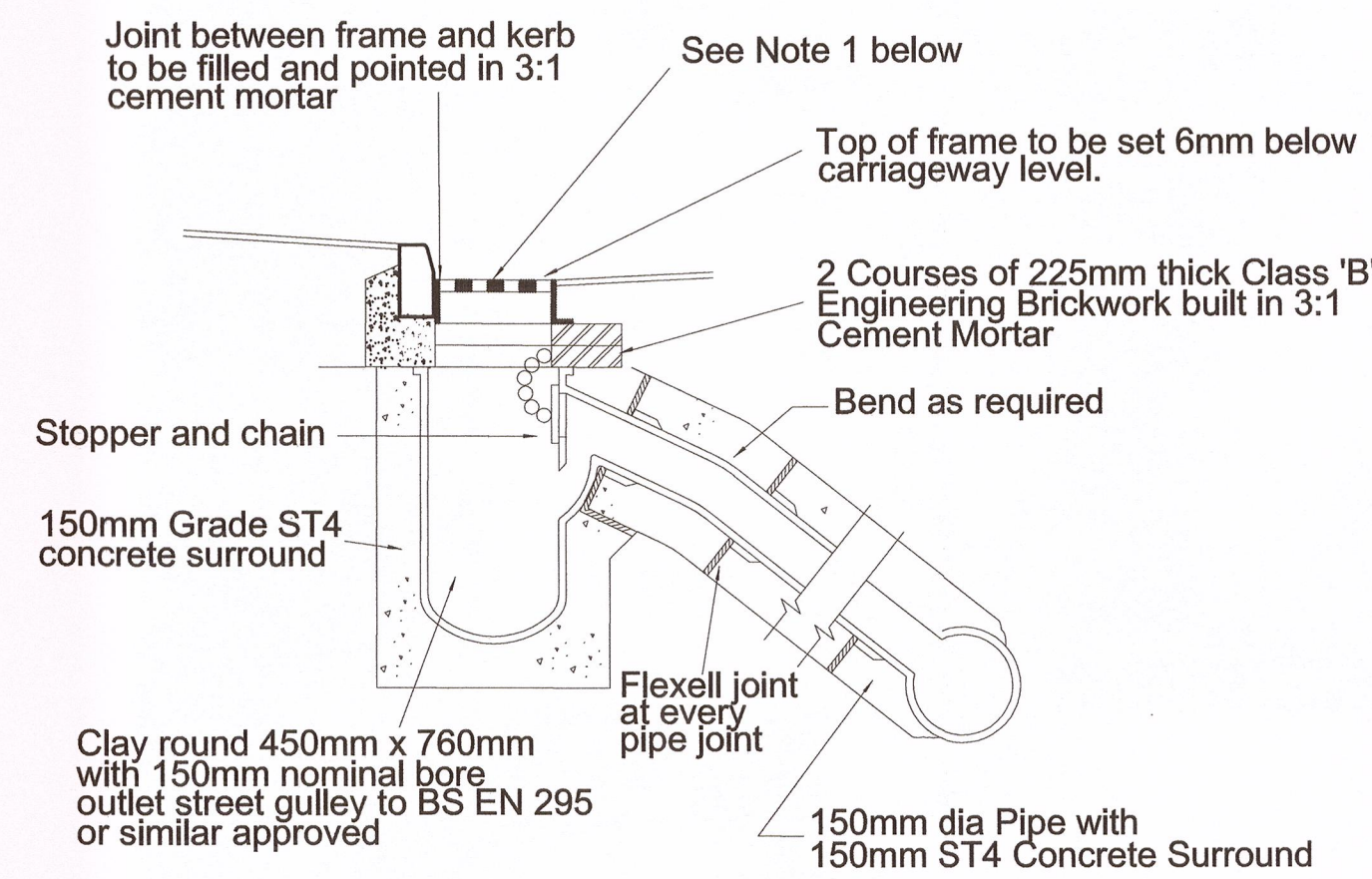
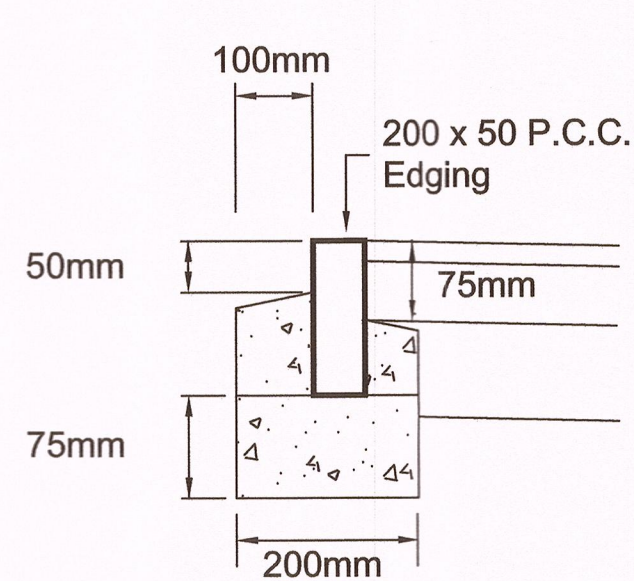
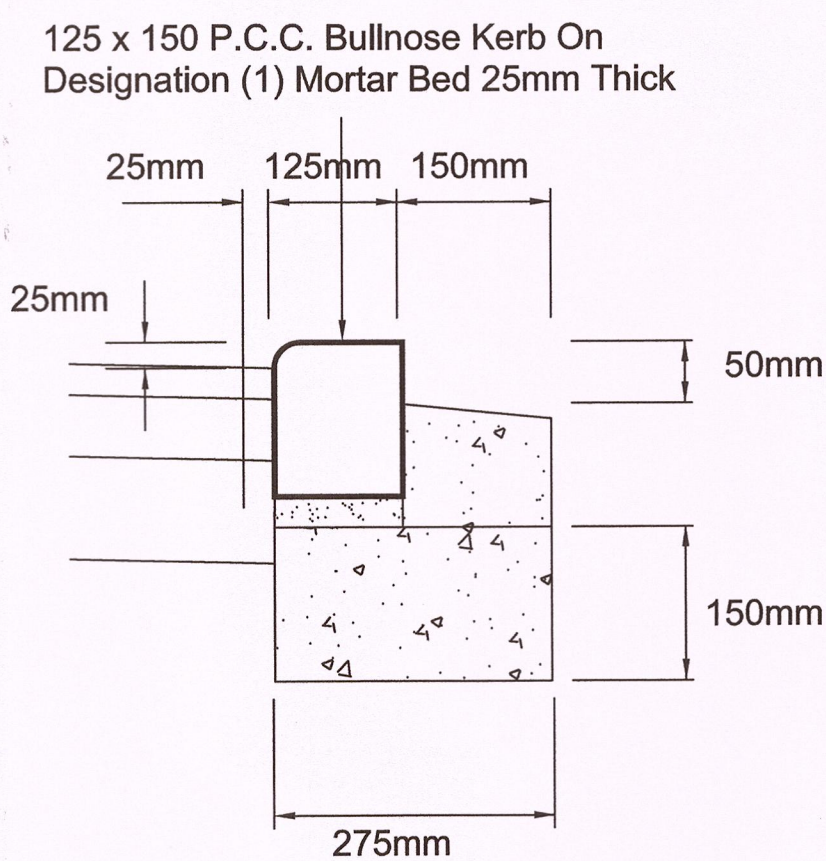
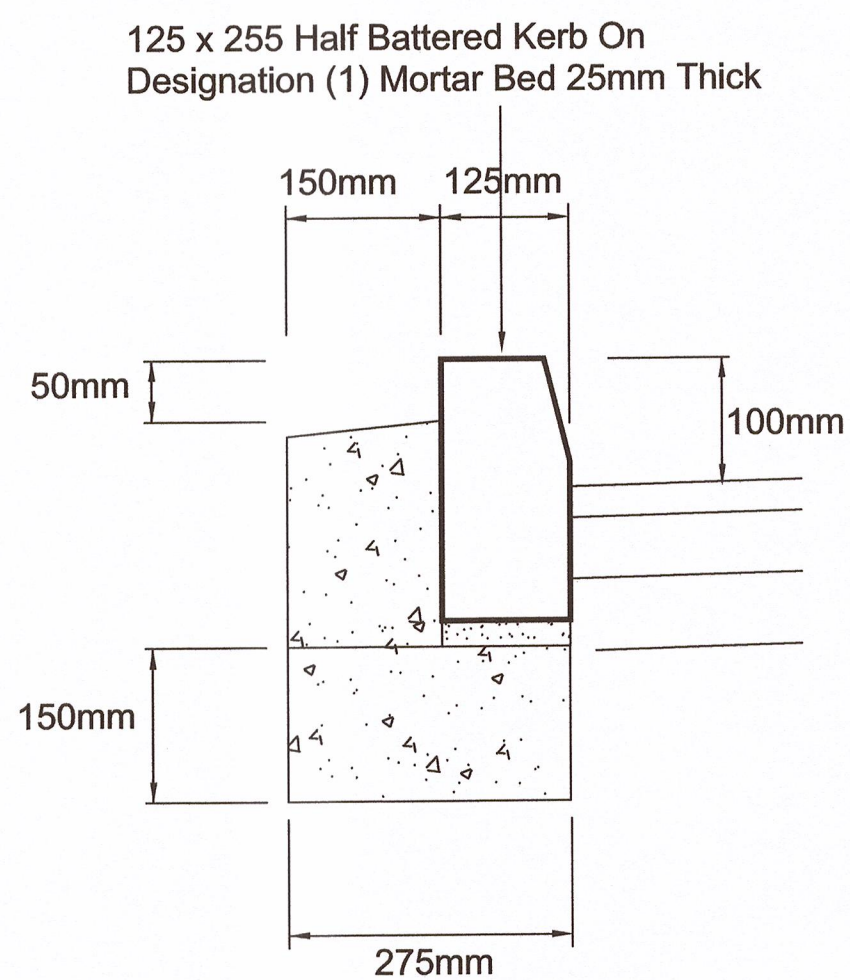
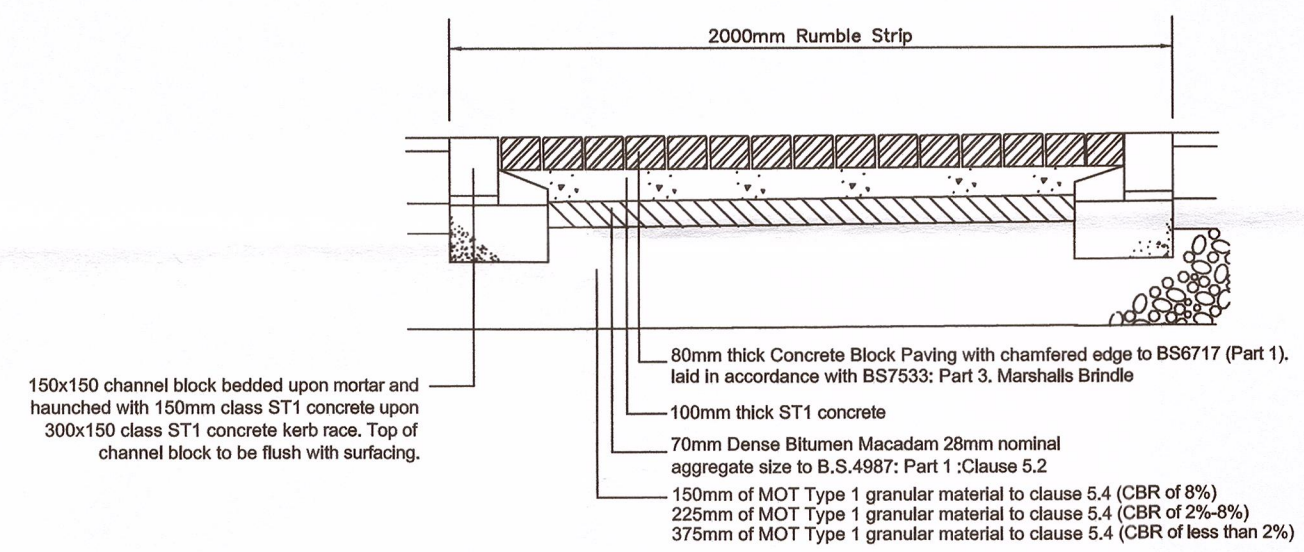
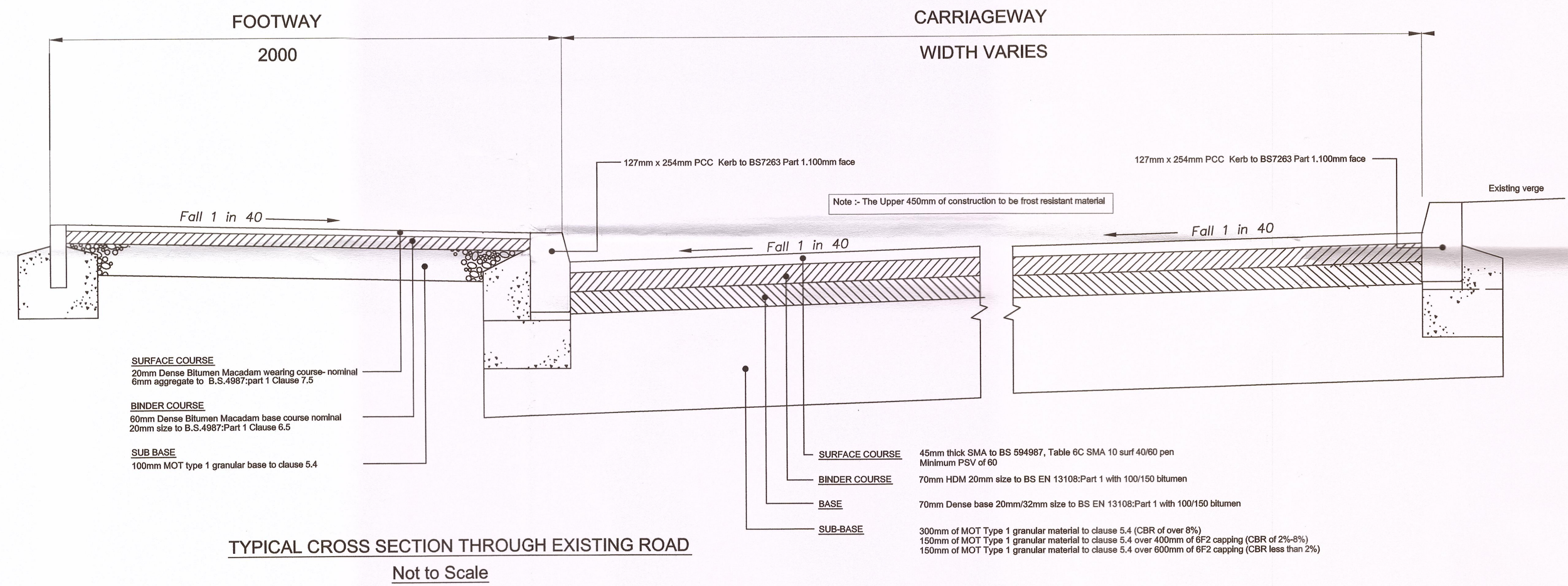
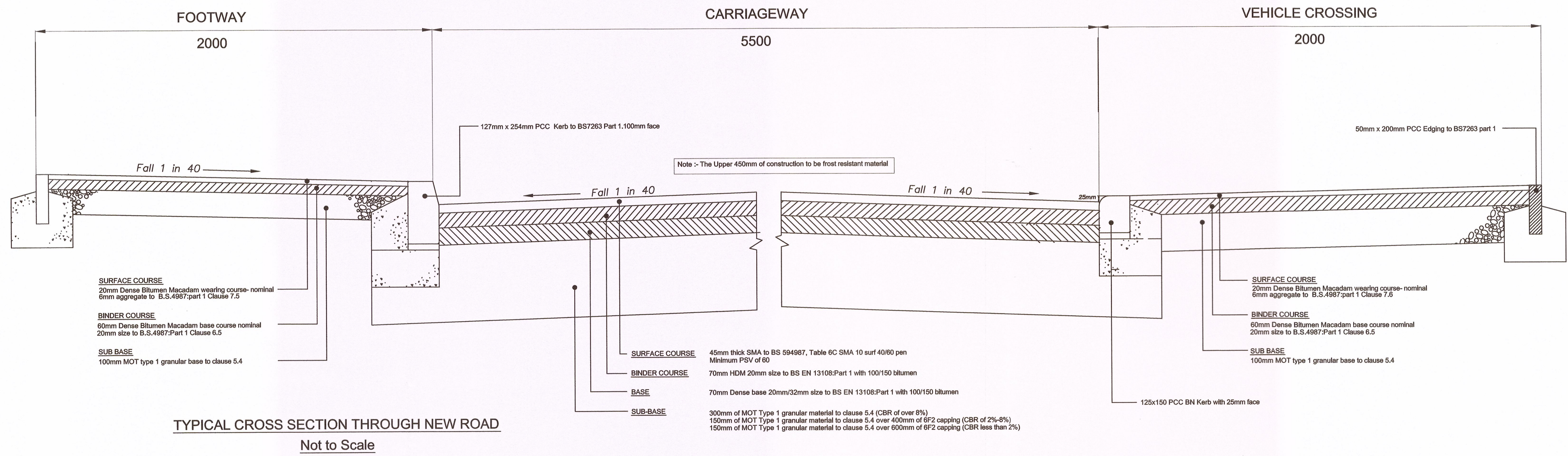

1. Gully grating and frame to BS EN 124 Class C400 to be of hinged, rectangular, (Approved Tester Kite mark or LRQA) Set in 3:1 Cement Mortar

320150355P

Preliminary

Rev	Details	Date	Drwn	Chk.
	Partner Construction			

Parsonage Avenue
Ribchester

Road Construction details

Dwg No.: STE/14/12/04
Date: 17-10-14
Scale: Not to scale
Copyright © Shaun Tonge Engineering

SHAUN TONGE
ENGINEERING

11 Broomhead Road, Wombwell, Barnsley, S73 0SA.
Tel. 01226 755929. Mobile 07528 278070. Email Shaun@stonge.fsnet.co.uk