

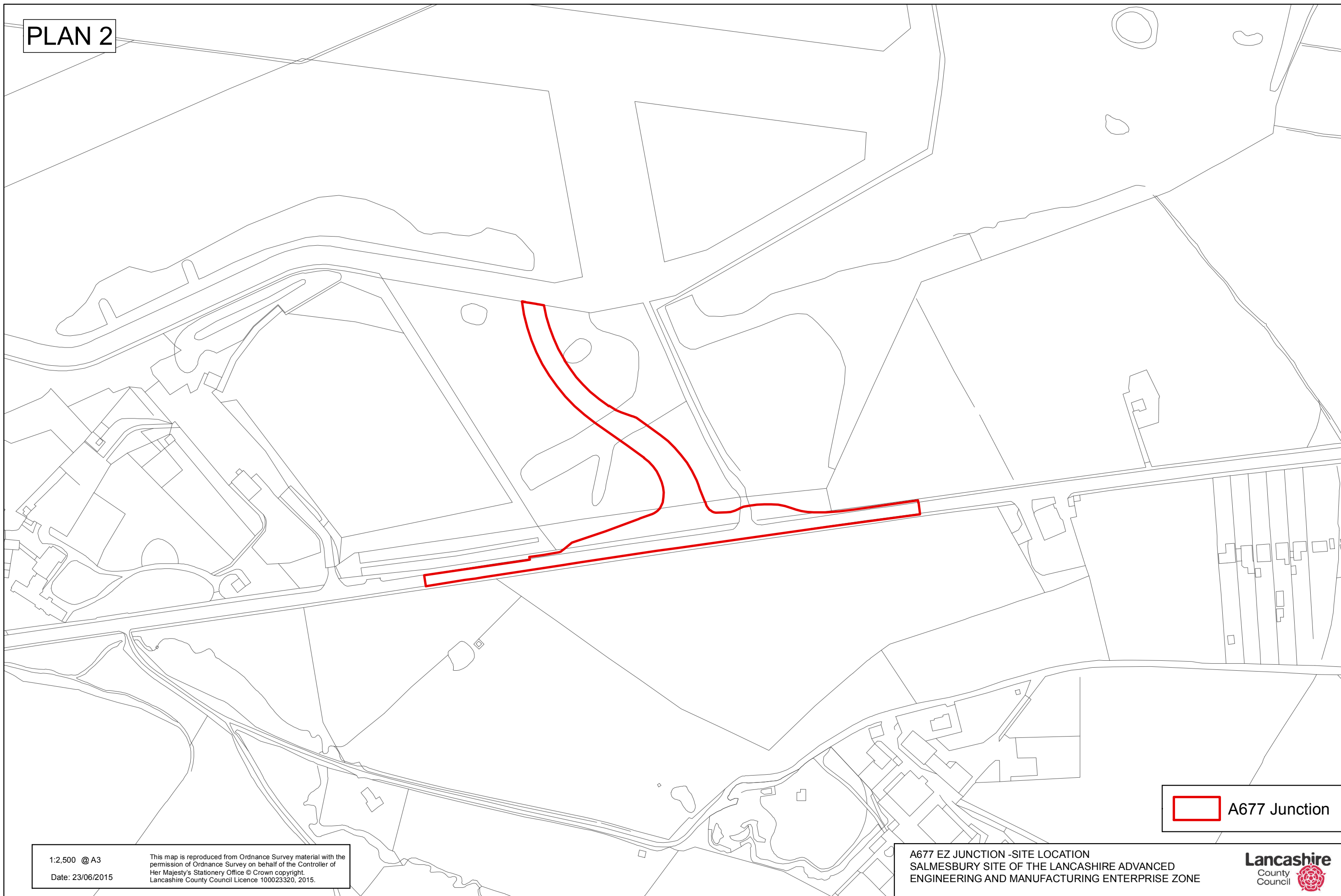

PLAN 2



 A677 Junction

1:2,500 @ A3  
Date: 23/06/2015  
This map is reproduced from Ordnance Survey material with the permission of Ordnance Survey on behalf of the Controller of Her Majesty's Stationery Office © Crown copyright. Lancashire County Council Licence 100023320, 2015.

A677 EZ JUNCTION - SITE LOCATION  
SALMESBURY SITE OF THE LANCASHIRE ADVANCED  
ENGINEERING AND MANUFACTURING ENTERPRISE ZONE

