

Part Front Elevation Of Cart Opening

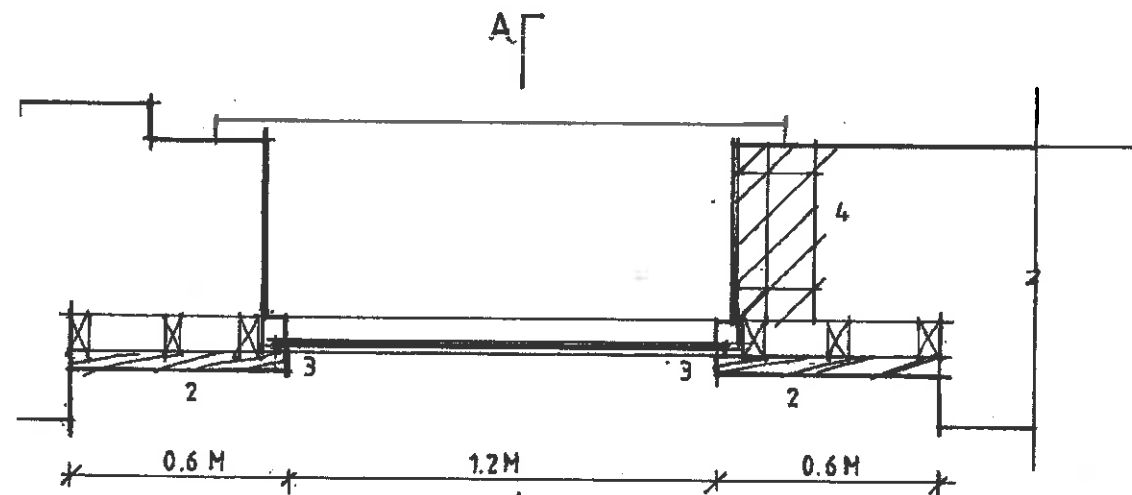

Part Plan

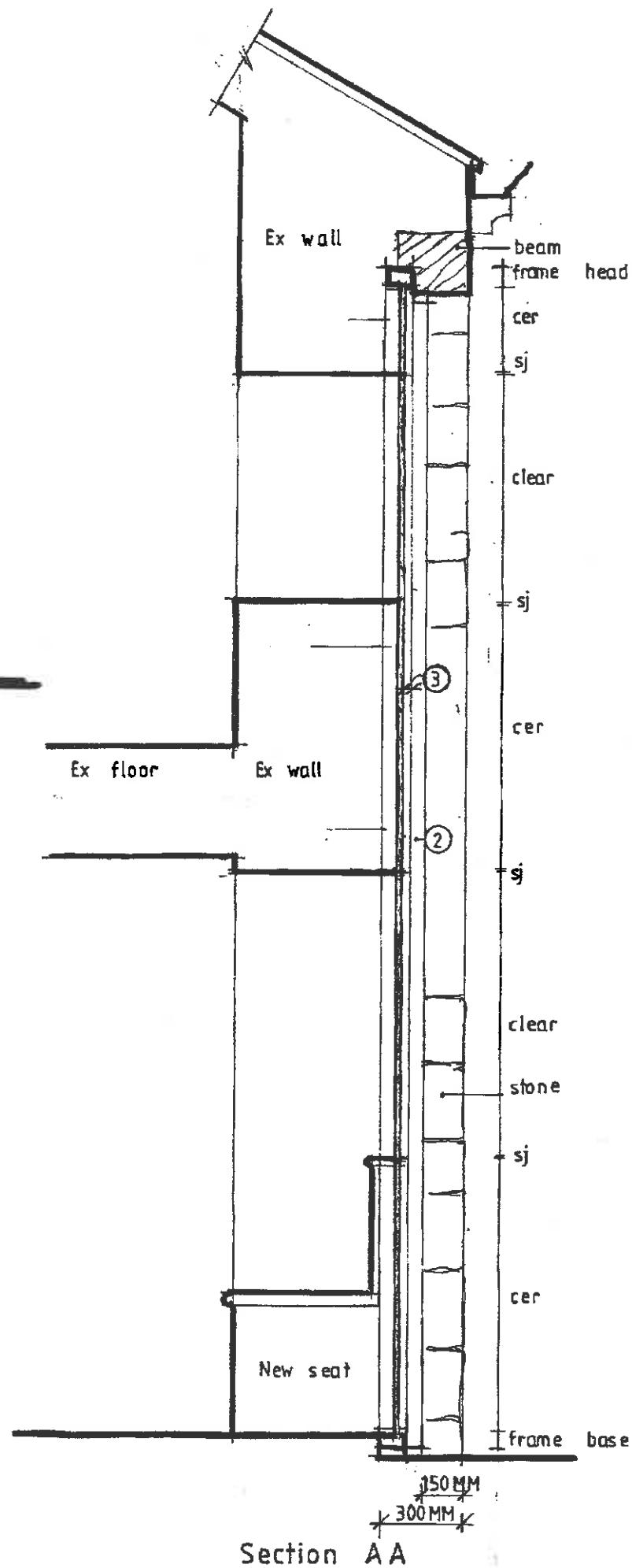

Section AA

Legend

1. Existing cart opening altered to reflect the use and appearance of this original feature. To include removal of double patio doors and first floor window with a full height glazed screen with minimal and concealed slender dark grey powder coated aluminium frames and dark grey glazed ceramic panels (cer), to conceal existing walls below and above the first floor window with fixed/non-open able lights. Clear glazed transparent units shown where there are existing window openings. Fine silicon joints (sj) between glazed panels horizontally.
2. Full height vertical reclaimed oak boards with butted joints (3no boards thick to give overall depth of 55mm) all fixed to timber battens behind to reflect old barn doors, which are to cover the contemporary infill stone walls to the cart opening and exposed oak dowel joints.
3. Shadow gaps are to be formed between the oak boarding and the glazing framework finished with dark grey powder coated aluminium trims. The frame work is to be set behind the projecting oak boards to provide a simple frameless glass appearance.
4. Jamb built up on inside to centralise glazed opening which has been proportioned to equate to two times the width of the exposed oak boards.

320150769P

Revisions

- Rev A - Plan, Section and Notes amended. 24.08.15 - NE
- Rev B - Section amended. 28.08.15 - NE

Client
Mr and Mrs Taylor

Job Title
Proposed Alterations To
Woodseave Barn
Waddington

Drawing Title
Proposed large scale
detailing for the
Cart Opening

Scale 1/20 e A3	Date July 2015	Drawn SGH
--------------------	-------------------	--------------

spa
SUNDERLAND PEACOCK ARCHITECTS
SUNDERLAND PEACOCK & ASSOCIATES LTD.
HAZELBERE, PIMLICO ROAD, CLITHEROE,
LANCASHIRE, BB7 2AB
T 01200 423170 F 01200 427328
E info@sunderlandpeacock.com
www.sunderlandpeacock.com

4 8 1 9 = 0 3 Rev B