

GROUND FLOOR PLAN

APT FLOOR AREA - 653sqft / 60.7m²

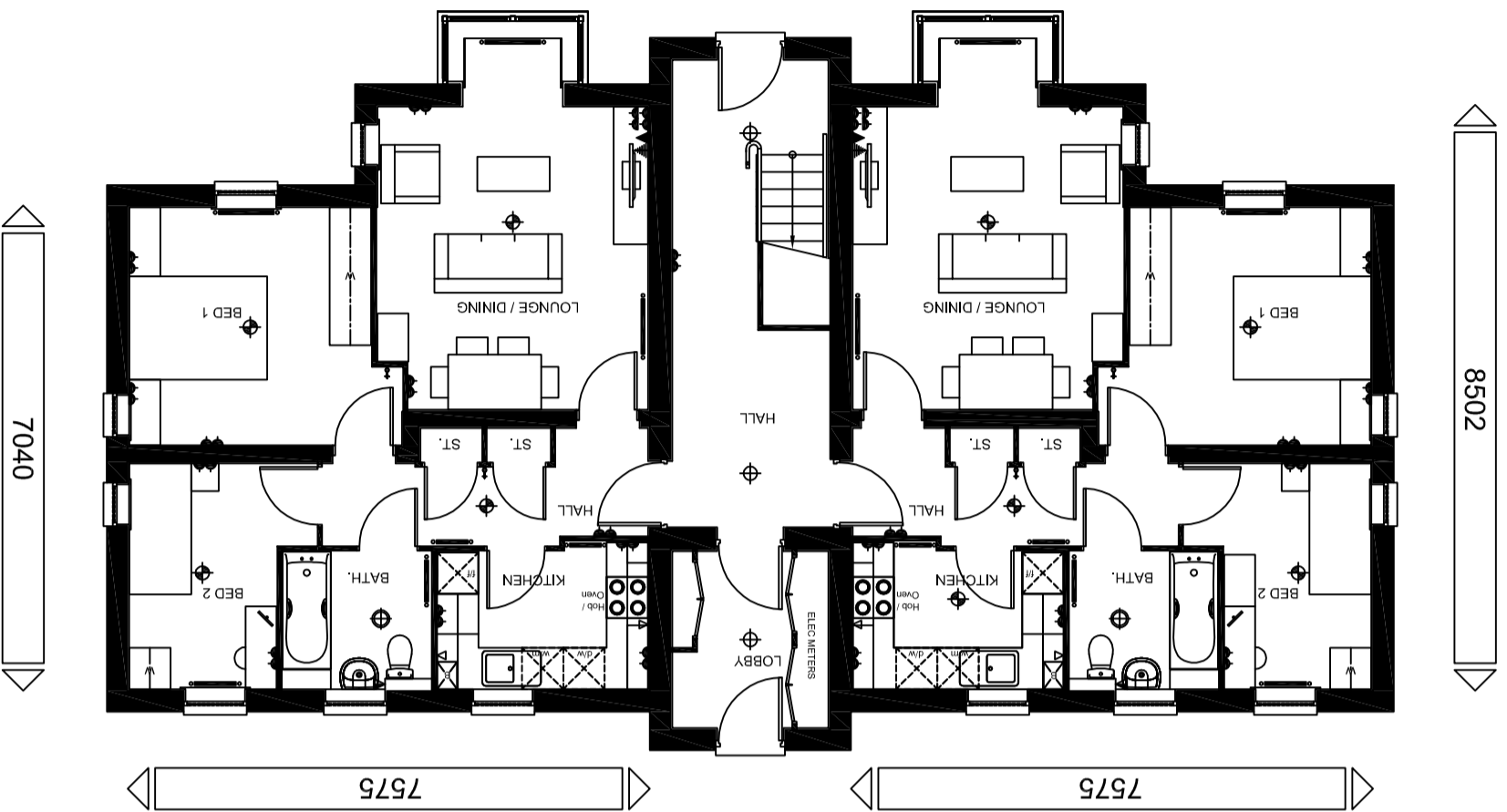

FIRST FLOOR PLAN

APT FLOOR AREA - 665sqft / 61.8m²

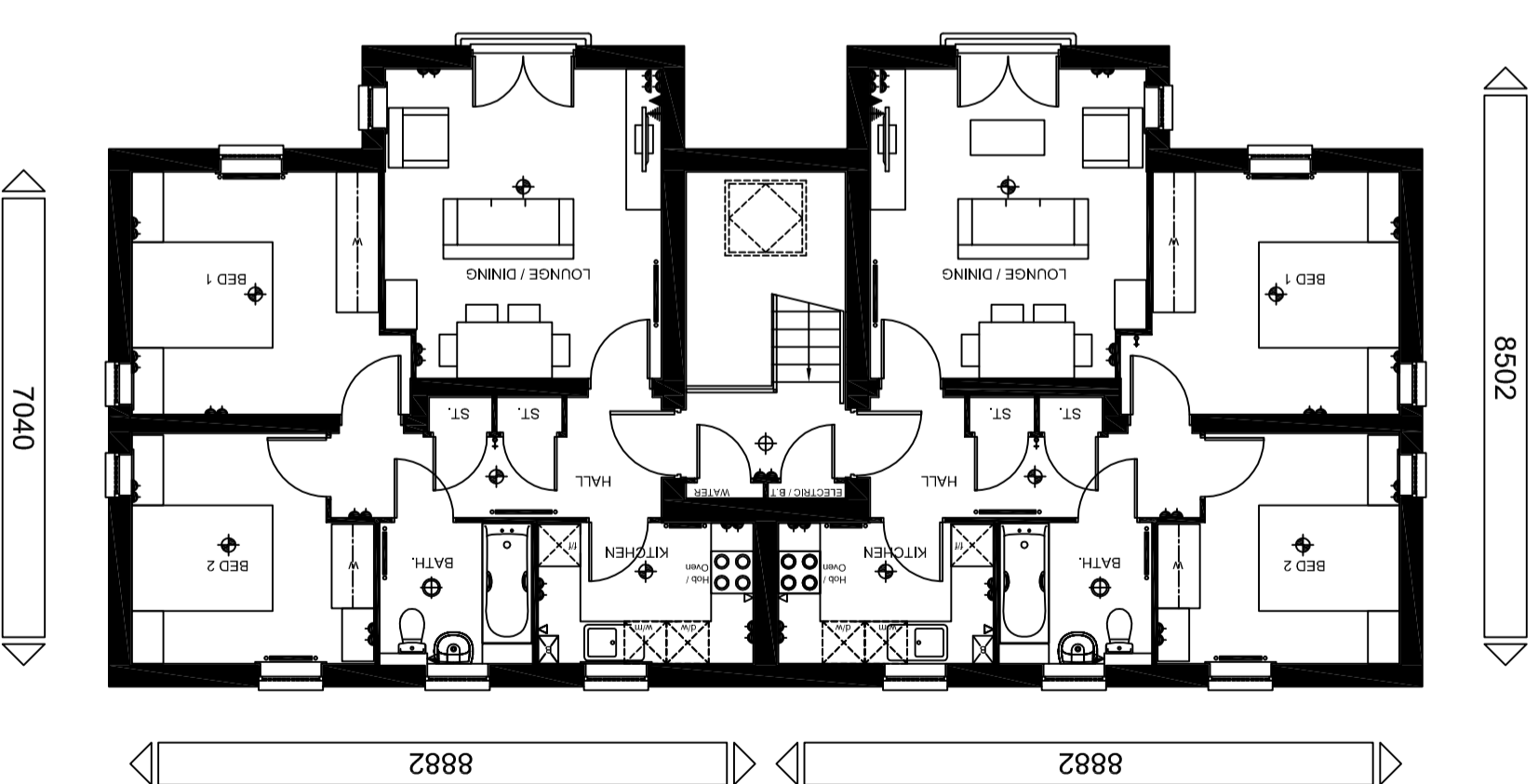

Barratt Homes (Manchester Division)
4 Brindley Road
City Park
Manchester
M16 9HQ

Tel: 0161 872 0161
Fax: 0161 855 2828

BARRATT
MANCHESTER DIVISION



House Type Code

2010 Range - The Foxton
(2 STOREY WITHOUT BALCONY)

WARNING TO HOUSE-BUYERS, Property Misdescriptions Act 1991
Buyers are warned that this is a working drawing and the contents of this drawing may be subject to change at any time and alterations and variations can occur during the progress of the build process. As such the layout, form, content and dimensions of the finished construction may differ (materially) from those shown. Whilst we make every effort to ensure our drawings are up to date there may from time to time be an unavoidable delay in updating these due to changes in regulations and/or re-letting. Purchasers are advised to check with the Sales Adviser whether any alterations have been made to this drawing. The contents of this drawing do not constitute a contract, part of any contract or warranty.

PLANNING DRAWING 2 of 2 - CLASSIC

Date	DEC 2015	2010/FOX-2/C/02	
Drawn by	SC		
Checked by			
Revision	-	Scale	1 : 100 @ A3