

Curtis House

NOTES
 THIS DRAWING IS TO BE READ IN CONJUNCTION WITH ALL OTHER DRAWINGS FOR THE PROJECT.
 ALL LEVELS AND DIMENSIONS ARE TO BE CHECKED ON SITE BY THE CONTRACTOR, PRIOR TO PLACING ORDERS OR COMMENCING ANY OF THE RELEVANT WORKS.
 ANY DISCREPANCIES BETWEEN THE INFORMATION SHOWN ON THE PLAN AND THAT FOUND ON SITE ARE TO BE REPORTED TO THE DESIGNER IMMEDIATELY.

carefully take down the existing hedgrow, and stone wall, at a distance of 2000mm back from the road edge in align with the approval on drawing PL-015- Rev A, at a distance of 5000mm from the wall to the left hand side to allow for an improved sight line, and allow for replanting behind this with like for like hedgrow

form new screen planting to rear of wall continous with the re-aligned hedgerow in natural hawthorn and blackthorn to match the existing native planting

coloured granew natural stone pavings to form path to entrance door to unit, and also from personel door of garage to gravel drive

coloured gravel to driveway, and edges to be s.w. treated timber with stakes at rear for fixing, with grassed edges.

CONTRACTOR TO NOTE THAT GROUND LEVEL TO BE REDUCED ON NORTHERN GABLE TO ALLOW FOR CLEAR HEADROOM FROM UNDERSIDE OF TRUSS TO GROUND FLOOR LEVEL. (APPROX 150MM)

existing grassed area on rear of garden

new septic tank location to be agreed on site, and irrigation system beyond tank to be in 100mm dia perforated land drainage system, laid to 1:80 falls, on be on a 300mm bed of limestone chippings with terram over this and then backfilled with 300mm of topsoil to bring it back to the extg garden level.

new access chamber on f.w. drainage system at head and also prior to discharging into the septic tank

LONGRIDGE ROAD

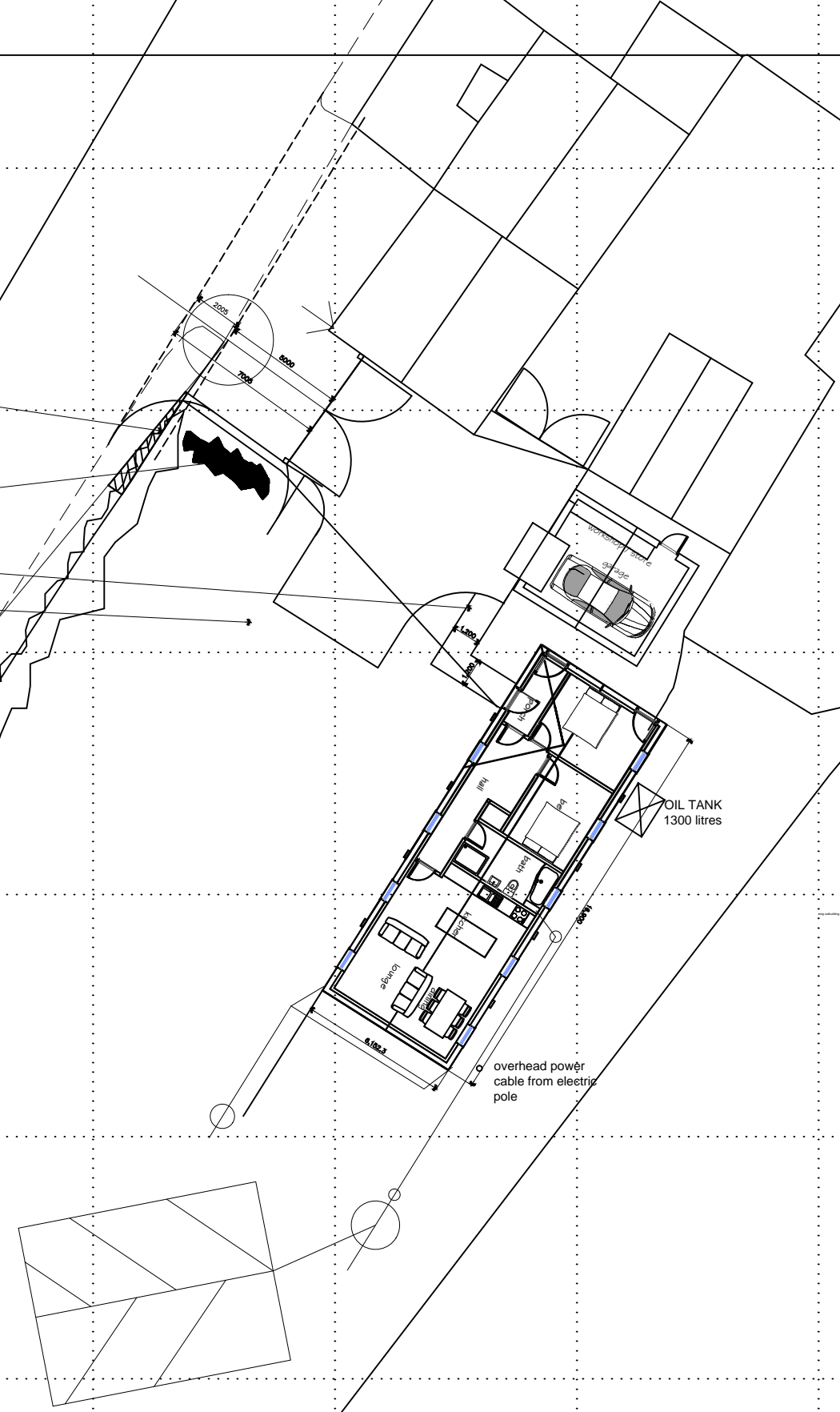

- C 08.03.16 garage omitted and notes added for Bldg Ctrl application
- B 22.02.16 garage re-sited to north-west boundary
- A 03.06.15 wall joining outbuilding and garage omitted

Rev.	Date	Description
------	------	-------------

A.L.H. Design Services
 Barley Cottage, Brewery Street, Longridge, Lancs
 PR3 3NB, Tel & Fax : (01772) 785719

Client
 Mr N. Sugden,
 Curtis House,
 Thornley-With: Wheatley
 Nr Longridge,
 Lancs.

Job/Scheme Title
CONVERSION OF REDUNDANT SHIPPON

Drawing Title
PROPOSED SITE PLAN

Job/Scheme Number	Drawing Number		
0454/93	Drawing No 1:0 C		
Scale	Date	Drawn	Checked
1/250th	Feb 15	a.t.l-h.	