

This drawing is to be read in conjunction with all relevant Architect, consultant, specialist and sub-contractors drawings and specifications. The Architect is to be notified of any discrepancies before proceeding. Do not scale from this drawing. All dimensions and levels are to be checked on site. This drawing is subject to copyright. All work carried out before Building and Planning Permission has been granted is at the contractor's own risk.

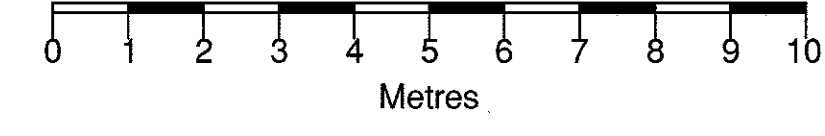
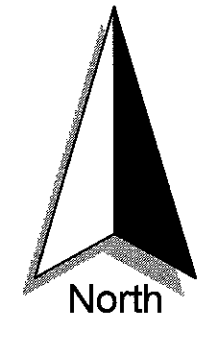

**ABBREVIATIONS**

- CH Cable Height
- CL Cover Level
- DK Drop Kerb
- EH Eaves Height
- EP Electric Pole
- FFL Finished Floor Level
- GU Gully
- MH Man Hole
- RH Ridge/Roof Height
- SL Step Level
- SVP Soil Vent Pipe
- TF Top of Fence
- TL Threshold Level
- TP Telegraph Pole
- TW Top of Wall

**NOTE**  
 All levels and coordinates relate to OSGB36 using GNSS data.  
 Levels defining edge of carriageway are observed at channel (bottom of kerb).

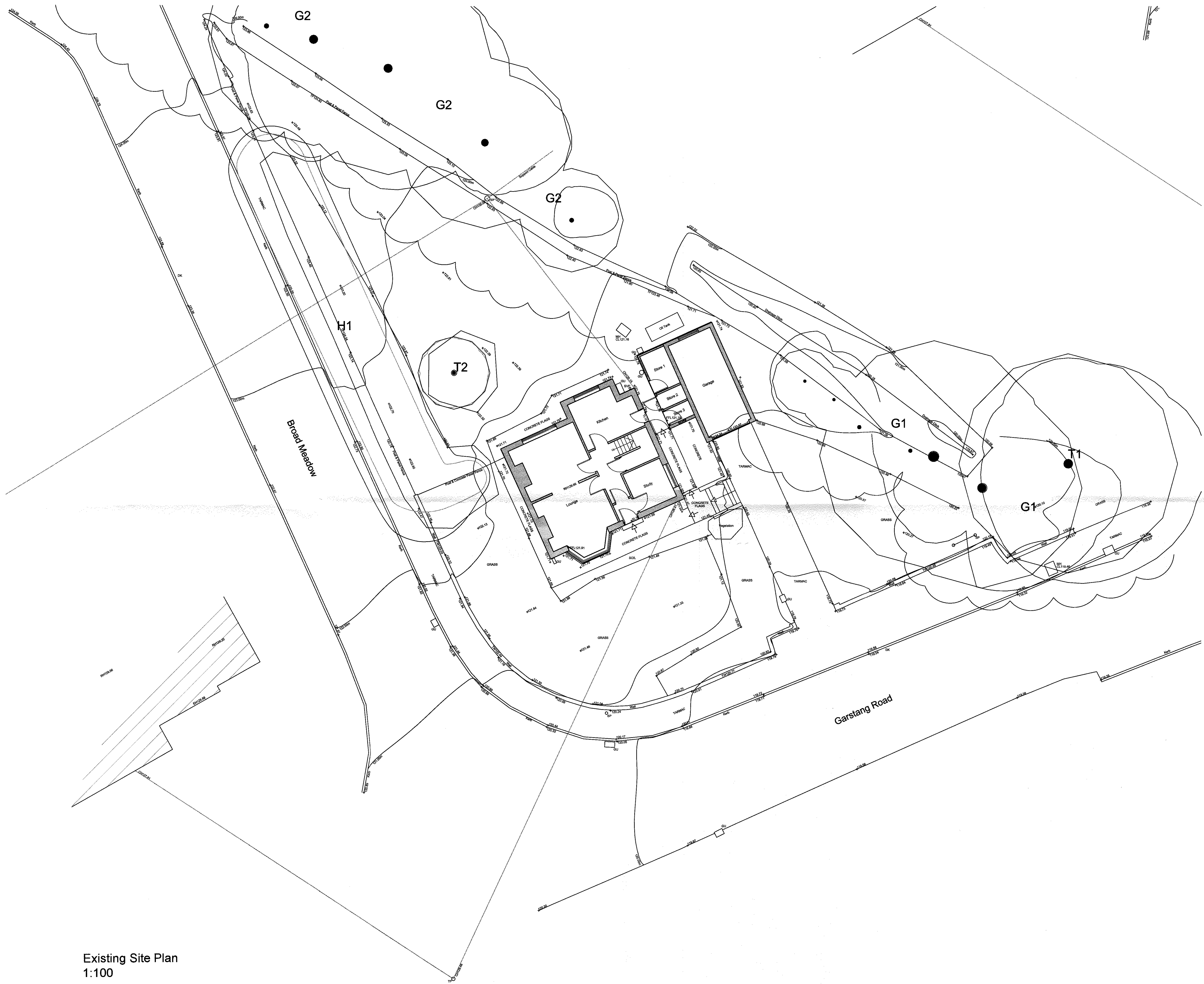

320160429P

Client  
 Mr and Mrs Roberts

Job Title  
 Police House  
 Chipping

Drawing Title  
 Existing Site Plan

Scale  
 1:100 @ A1

Date  
 March 2016

Drawn  
 Craig Harrison

**spa**  
 ARCHITECTS

SUNDERLAND PEACOCK & ASSOCIATES LTD.  
 HAZELMERE, PIMLICO ROAD, CLITHEROE  
 LANCASHIRE, B67 2AG  
 T 01200 423178 F 01200 427328  
 E info@sunderlandpeacock.com  
 www.sunderlandpeacock.com

5024 -03

Existing Site Plan  
 1:100