

general notes:  
 do not scale the drawing.  
 all dimensions to be checked on site prior to commencement of work and any discrepancy shall be immediately reported and resolved prior to work commencing. this drawing is to be read in conjunction with all relevant drawings and specifications relating to the job whether or not indicated on the drawing. copyright reserved to mck associates ltd. and this drawing may not be used or reproduced without prior written consent.

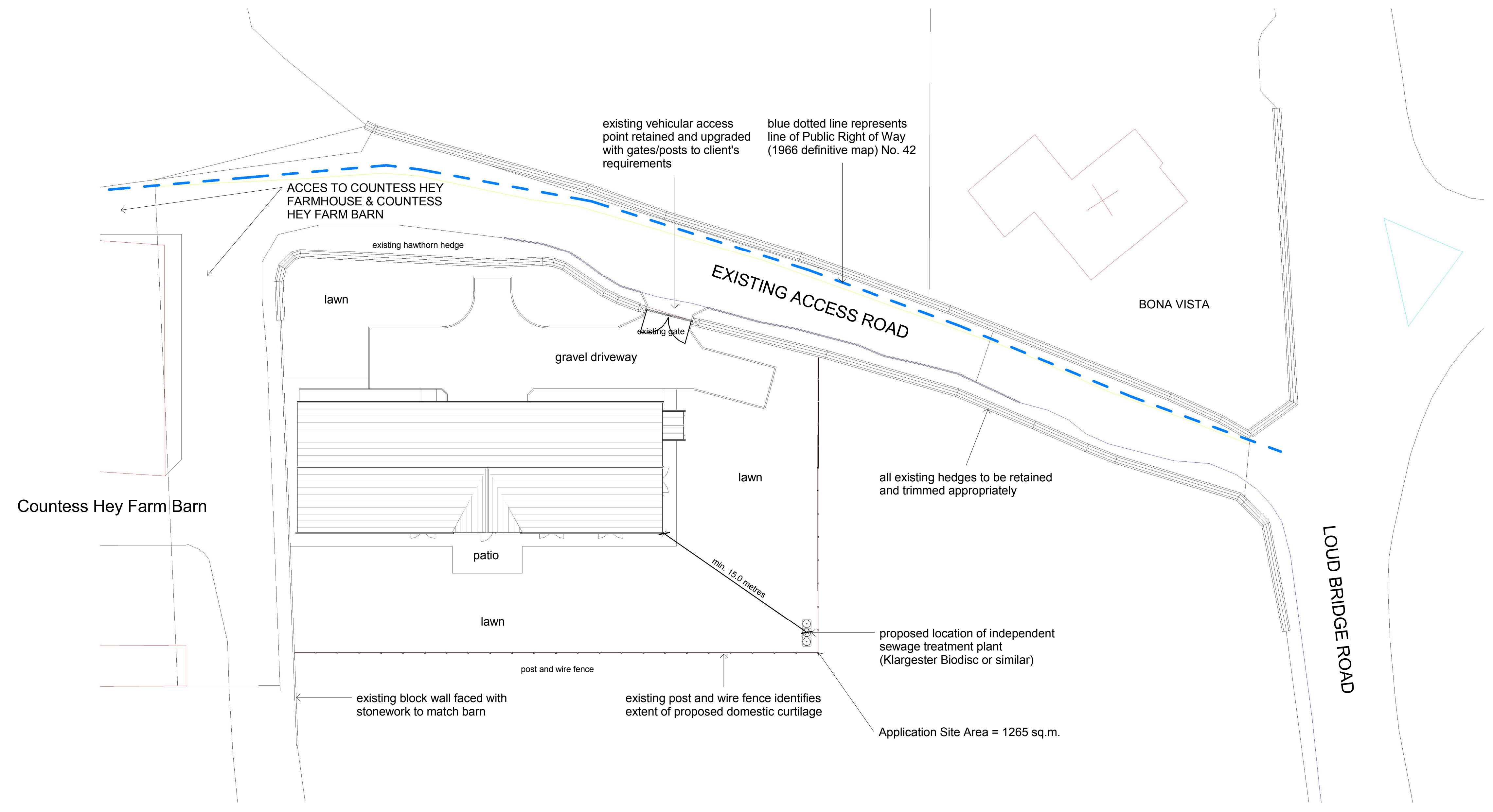

Rev.	Date	By	Description

Client:  
**Mr. H. Gornall**

**mck associates limited**  
 architecture | building surveying | urban design  
 burnaby villa ■ 48 wadding street road ■ fulwood ■ preston ■ pr2 8bp  
 tel: 01772 774510 fax: 01772 774511 email: mck@mckassociates.co.uk

Project:  
**Proposed Barn Conversion to dwelling  
 Countess Hey Barn, Loud Bridge Road,  
 Thornley, Chipping**

Drawing Title:  
**Site Layout as Proposed**

Drawn	Checked	Scale	Date
PS		1:200 (A1)	March 2016
Job No.	Drawing No.	Rev.	
16-023	2001		

A1 PLANNING