

Bridge Road

320160577P

22/12/16
APPROVED FOR
CONSTRUCTION

AMENDED PLANS RECEIVED
DATE 01/12/16

S J Bialacki Limited Building Surveyors
Drawing no 500 59a-b
Scale 1:100
Proposed Site Layout
Proposed Residential Development On Land At Ribbleisdale View Charburn

proposed levels
 amendments 15-11-16
 introduction of footpath
 relocate plot 4 dwelling
 20-11-16
 increase width of footpath
 to 1800mm

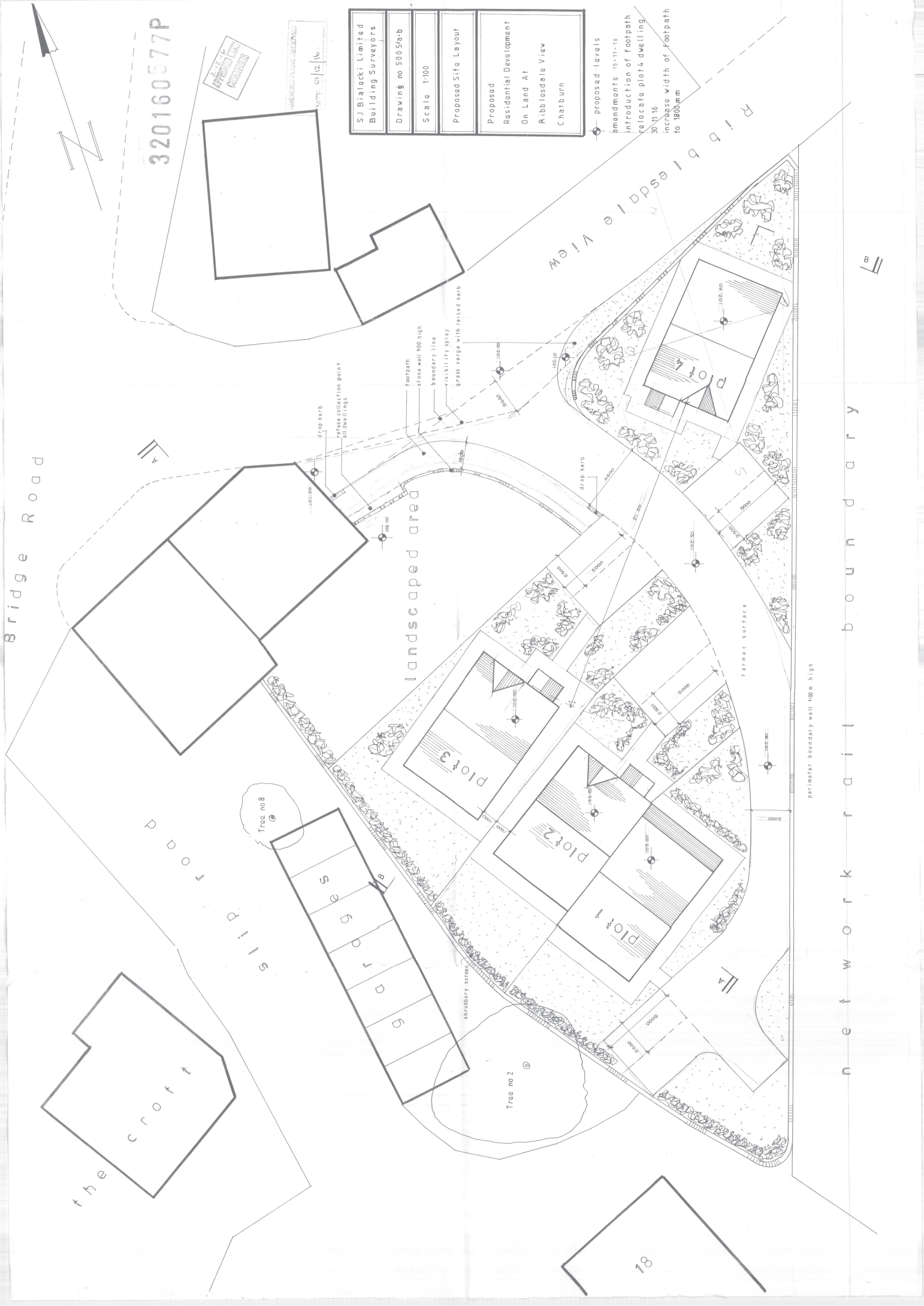

landscaped area

Ribbleisdale View

net work rail boundary

perimeter boundary wall 100m high