

landscaping and boundary treatment plan scale 1:100

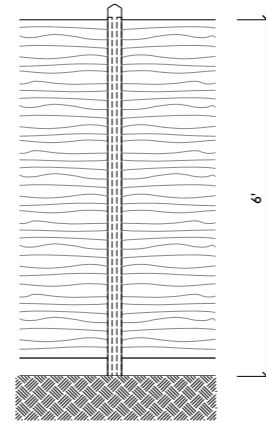

existing masonry and concrete panel boundary wall repaired and made good
concrete panels to be repainted in white

01 existing boundary wall retained



existing 6' concrete post and timber panel to be repaired and made good
missing / broken panels to be replaced as necessary
timber fence panels to be painted with preservative varnish / stain

02 existing boundary fence repaired scale 1:20



existing red brick paving to front and side of property to be repaired and made good as necessary
extent and type of paving unchanged

03 existing paving retained



rear patio to be paved with natural stone similar to that shown opposite
area of paving to rear of the property to abut the existing garden retaining wall

04 proposed stone flags

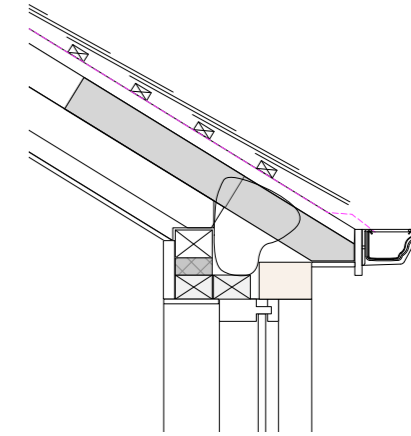

proposed eaves detail

EAVES DETAIL
saffits and fascia boards to be marley 'cedral board', colour - 'white' ref.OP01.
all fixings to be concealed. all exposed sawn edges to be painted out prior to installation.
supported on 50x50mm studwork at max 400mm ctrs.
compressed mineral fibre insulation to eaves void.

RAINWATER GOODS
existing rainwater goods (gutters, downpipes, hoppers, etc...) to be carefully taken down and removed from site where indicated.
proposed aluminum rainwater goods to be manufactured by and installed in accordance with the recommendations of :-
Marley Alutec Ltd
tel. 01234 359 438
- new Marley aluminum 'alligator classic ogee'
- gutters fitted with leaf guards
- fixed rafter arms
- colour - 'black grey' RAL 7021.

A Issued for planning June 2016
- Issued for information May 2016

stanton andrews
architects

44 york street
clitheroe
BB7 2DL

t 01200 444490
e mail@stantonandrews.co.uk
w stantonandrews.co.uk

Sandy Bank Farm
Chipping

Landscaping plan and
Eaves Details

drg.no. 1545/ PL20 rev. A
drawn. ae date. jun 16 scale. 1:200 © A3