

SPECIFICATION

The work to include the provision for the supply and installation of a new electrical installation in accordance with the following documentation:-

- 1) Lancashire county property group engineering design General Electrical Specification Nov 2014
- 2) The 17th edition of the IET regulations for electrical equipment in buildings, BS 7671 including the current amendments.
- 3) All architectural, structural and other services drawings and specifications relating to this contract.
- 4) This Supplementary Specification and Site Layout drawings:-

-6584/E01 - Electrical Details

Extent of Work

The contractor shall be deemed to mean the electrical subcontractor and the installation is deemed to mean the electrical installation. The main contractor shall be the building contractor with sole responsibility for the project. Electrical contractor to consult with the main contractor with regard to programme and access.

The work to be carried out includes for supplying materials and labour as required, all sundry items whether specifically mentioned or not for the work to be completed in accordance with this specification and drawings to form a complete electrical installation for the Heat Recovery installation.

Elec To Mech

Contractor to include all supplies to the Heat Recovery Units and all local isolation and control. The controls shall be supplied by the mech but installed and interconnected by the elec but commissioning included by the mech. The beldon wiring shall be enclosed within HGSW steel conduit surface. The supplies to the Heat Recovery shall be routed to conceal the route from the side rooms or ceiling voids were available.

Bonding

Contractor shall include a 6mm cross bond to the steel ductwork from the local electrical installation.

Accessories

Metal Clad MK.

LTHW Heating Frost Stat

The contractor shall include to remove the existing external frost stat and install and wire the new internal Low Temp Sensor as shown fed from the local LTHW heating panel in the plant room.

Fire Alarm

Contractor to include to extend the existing fire alarm to include a 2 channel interface adjacent the Heat Recovery Control Units in the office via 1.5mm FP200

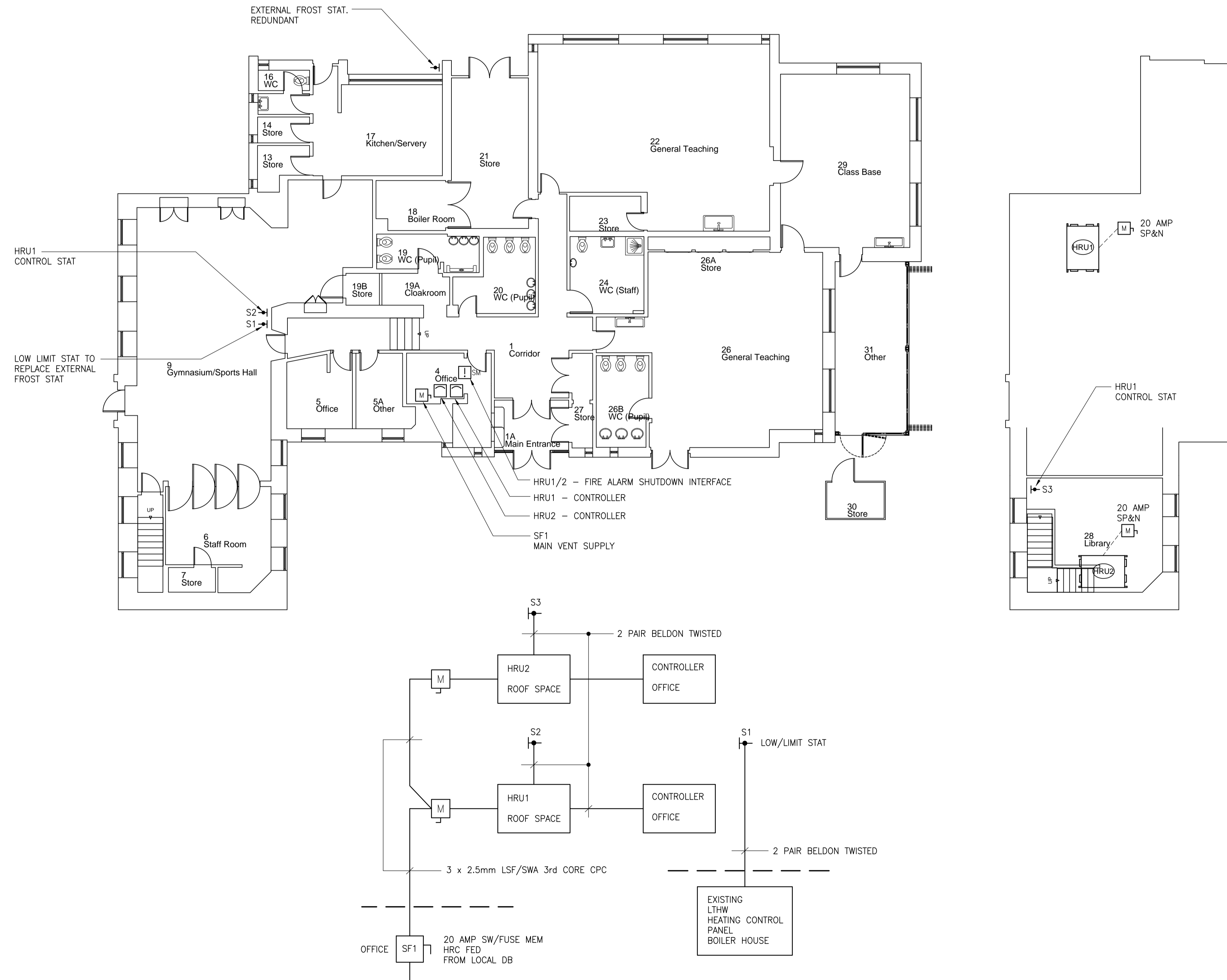

DATE	REV	NOTES

NOTE: DIMENSIONS ARE NOT TO BE SCALED FROM THIS DRAWING. ALL WRITTEN MEASUREMENTS ARE TO BE CHECKED ON SITE BY THE CONTRACTOR.
 © LANCASHIRE COUNTY COUNCIL MMXVI
 ALL RIGHTS DESCRIBED IN CHAPTER IV OF THE COPYRIGHT, DESIGN AND PATENTS ACT 1988 HAVE BEEN GENERALLY ASSERTED.

TOWN NAME
CLITHEROE, SLAIDBURN
 PREMISES NAME
BRENNANDS ENDOWED PRIMARY SCHOOL, CHURCH STREET, BB7 3ER
 PREMISES NO.

PROJECT
NEW VENTILATION INSTALLATION, HALL & UPPER TEACHING SPACE

DRAWING TITLE
ELECTRICAL DETAILS

SCALE @ A1	DRAWN BY	DATE	CHECKED BY
1:100	JC	Aug 2016	



Design & Construction

PO BOX 26, COUNTY HALL, PRESTON. PR1 8XB
 TEL: 0300 1236701

PROJECT NO.	DRAWING NO.	REVISION
3770	6584/E01	

DRAWING STATUS
TENDER