

Note 1
Car park spaces delineated using white marker blocks. Assume 15 blocks per parking bay.

ACCESS ROAD & CAR PARK
(Scale 1:10)

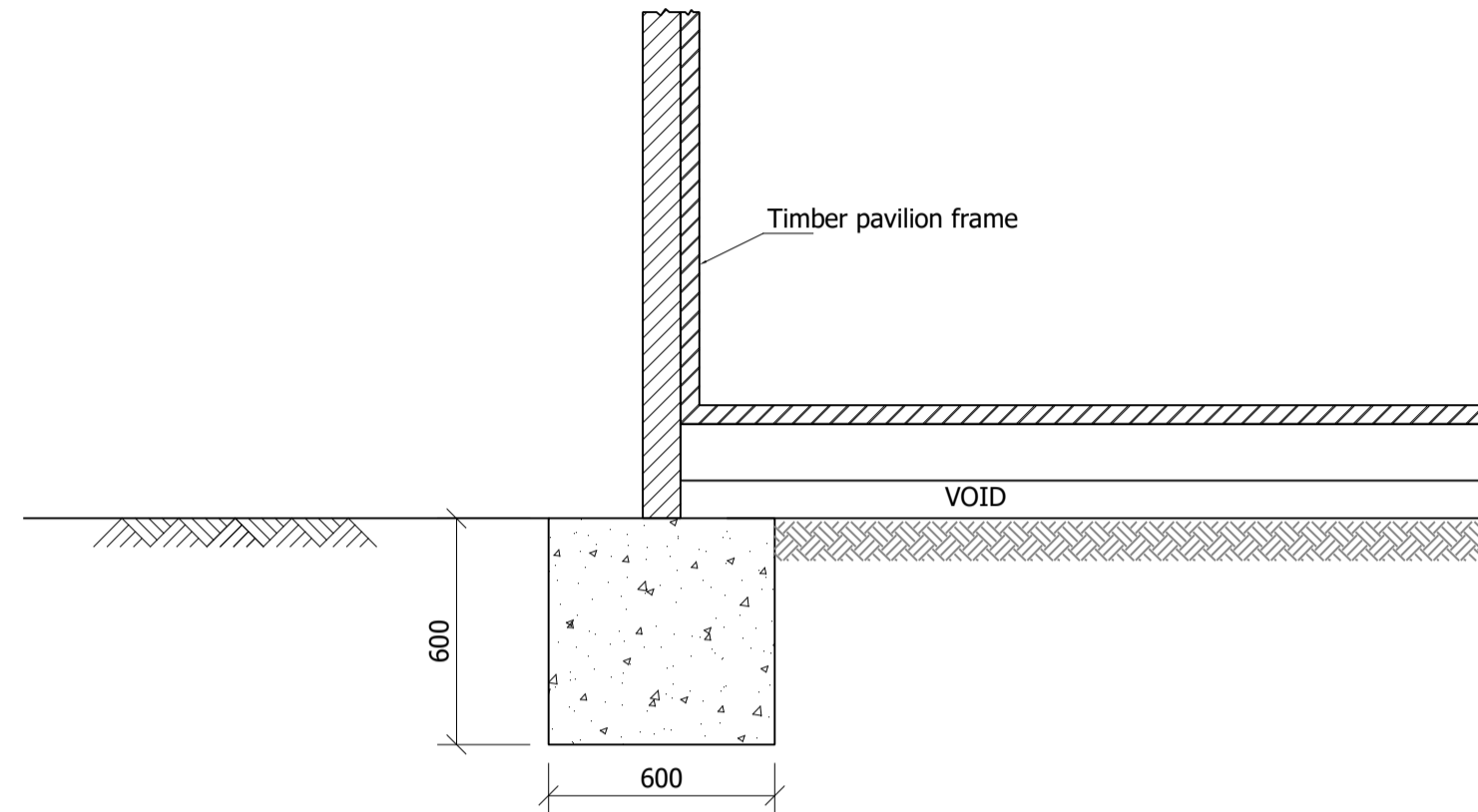

SECTION A-A
(Scale 1:20)

ACCESS ROAD & CARPARK
AREA 481.27m²

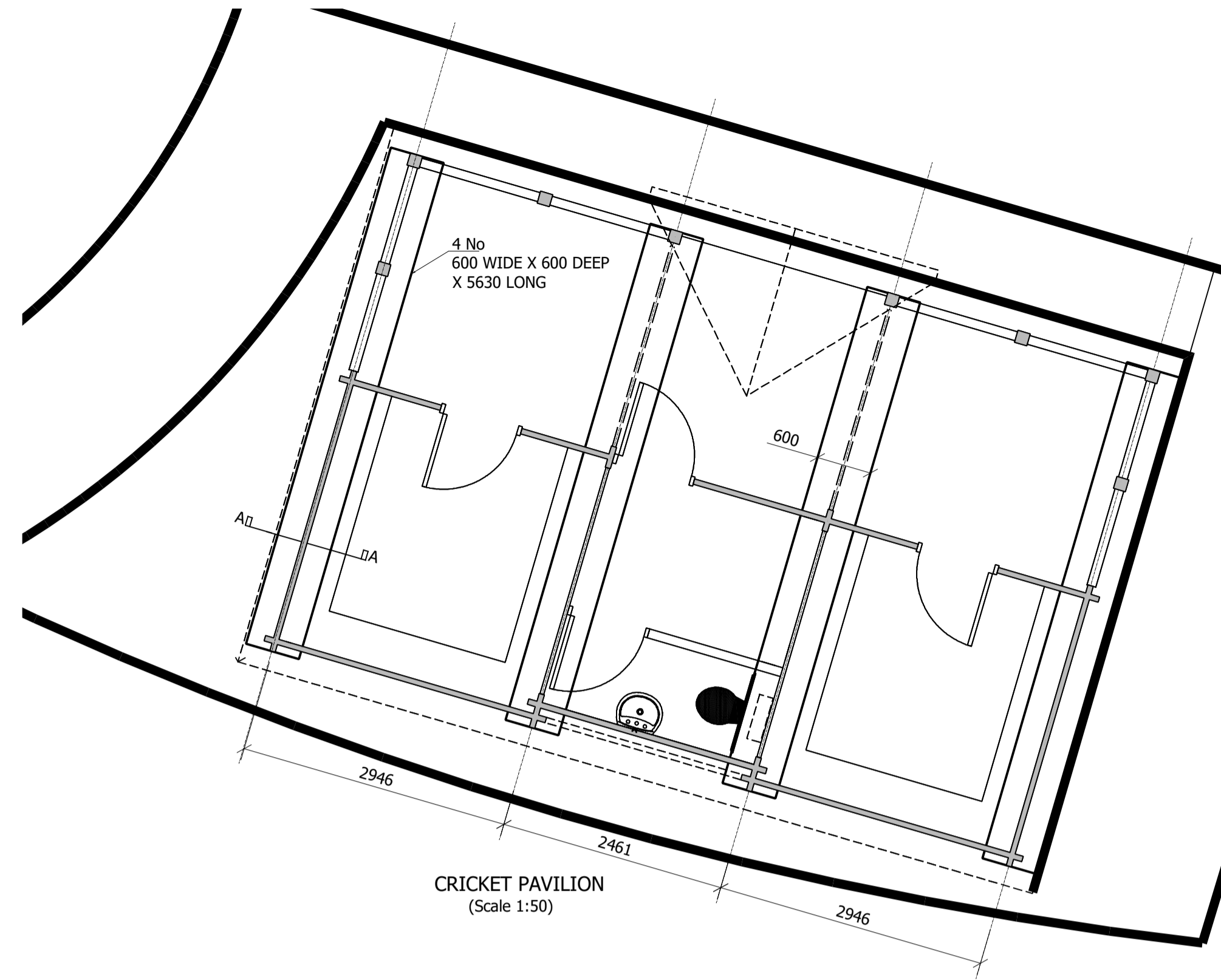

CRICKET PAVILION
(Scale 1:50)

CONCRETE WORKS

- DO NOT SCALE FROM THIS DRAWING.
- ALL DIMENSIONS IN MILLIMETERS UNLESS NOTED OTHERWISE.
- DRAWINGS TO BE READ IN CONJUNCTION WITH ALL OTHER RELEVANT DRAWINGS AND SPECIFICATIONS.
- ALL CONCRETE TO BE GRADE RC25/30 DESIGNATED MIX RC30 TO BS8500.
- GROUND BEARING PRESSURE UNDER FOUNDATION ASSUMED TO BE STIFF CLAY/MUDSTONE OR STANDSTONE WITH SBP OF 100KN/M2 IN ACCORDANCE WITH THE SITE INVESTIGATION. ALLOW FOR TRENCH FILL DOWN TO ROCK LEVEL IF SOFT CLAYS ARE ENCOUNTERED.
- WHERE IT IS NECESSARY TO EXCAVATE BELOW THE PROVISIONAL FORMATION LEVELS TO REACH AN APPROVED BEARING STRATUM, ANY ADDITIONAL EXCAVATION IS TO BE BACKFILLED WITH MASS CONCRETE IN ACCORDANCE WITH THE SPECIFICATION
- WHERE EXISTING FOUNDATIONS ARE ENCOUNTERED DURING EXCAVATION TO FORMATION LEVELS OF NEW FOUNDATION THE EXISTING FOUNDATION MUST BE REMOVED TO ALLOW THE NEW FOUNDATION TO BEAR ONTO THE FOUNDATION STRATA.
- THE PERMISSIBLE DEVIATION IN LEVELS OF THE TOP OF BLINDING CONCRETE SHALL BE BETWEEN +0MM AND -25MM. ALL CONCRETE WORKS ARE TO BE CONSTRUCTED IN ACCORDANCE WITH BS8110 PART 1 1987.
- REFER TO ARCHITECT'S DRAWINGS FOR ALL WATERPROOFING, TANKING & INSULATION DETAILS.
- REFER TO ARCHITECTS AND SERVICE ENGINEER'S DRAWING FOR LOCATION, ORIENTATION AND SIZE OF PITS, TRENCHES, MANHOLES, PENETRATIONS AND LIGHTNING PROTECTION ETC.

GENERAL SUPERSTRUCTURE CONCRETE WORKS:

- ALL CONCRETE GRADE DESIGNATED MIX RC30
- FORMED FINISHES TO BE SMOOTH WOOD UNO
- WORKED FINISHES TO BE WOOD FLOAT TO RECEIVE SUSPENDED FLOOR
- ALL REINFORCEMENT TO BE GRADE 500
- ALL MESH TO HAVE MINIMUM 400mm LAP
- COVER TO REINFORCEMENT 30mm UNO

CDM

Notes below are additional to hazards/risks normally associated with this type of work

These notes are based on the use of experienced and competent contractors carrying out the work using an approved safe method of working



CRICKET PITCH TOPO
(Scale 1:200)

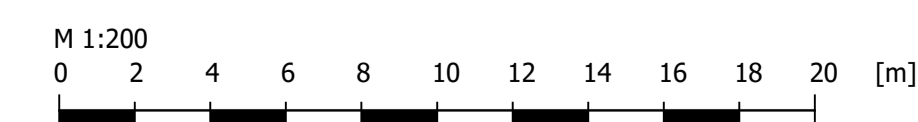

B	26.05.16	JG	Carpark Revised
A	19.11.15	JG	Issued for Planning
Revision	Date	By	Description

gravitate consulting
Civil and Structural Engineers

The Heath Business & Technical Park, Runcorn, Cheshire WA7 4QX
Tel 01928 563 847 Email eng@gravitateconsulting.com

Client
SCPI

Site
CHIPPING

Project
NEW HOTEL

Drawing Title
CRICKET PITCH CAR PARK

Status :	Planning	Date:	Nov 2015
Scale at A1:	1:200	Job Number:	12-155
Drawn By:	JG	Drawing Number:	5
Checked By:	RS	Revision:	B