



- Key:**
-  Outline/Extent of ownership
 -  Illustrates outline/ extent of new residential curtilage proposed
 -  Illustrates outline/ extent of change of use from agricultural to equestrian



A PRG Drawing update. 12.10.2016
 no. by revision date

Client
Nicky Cummings

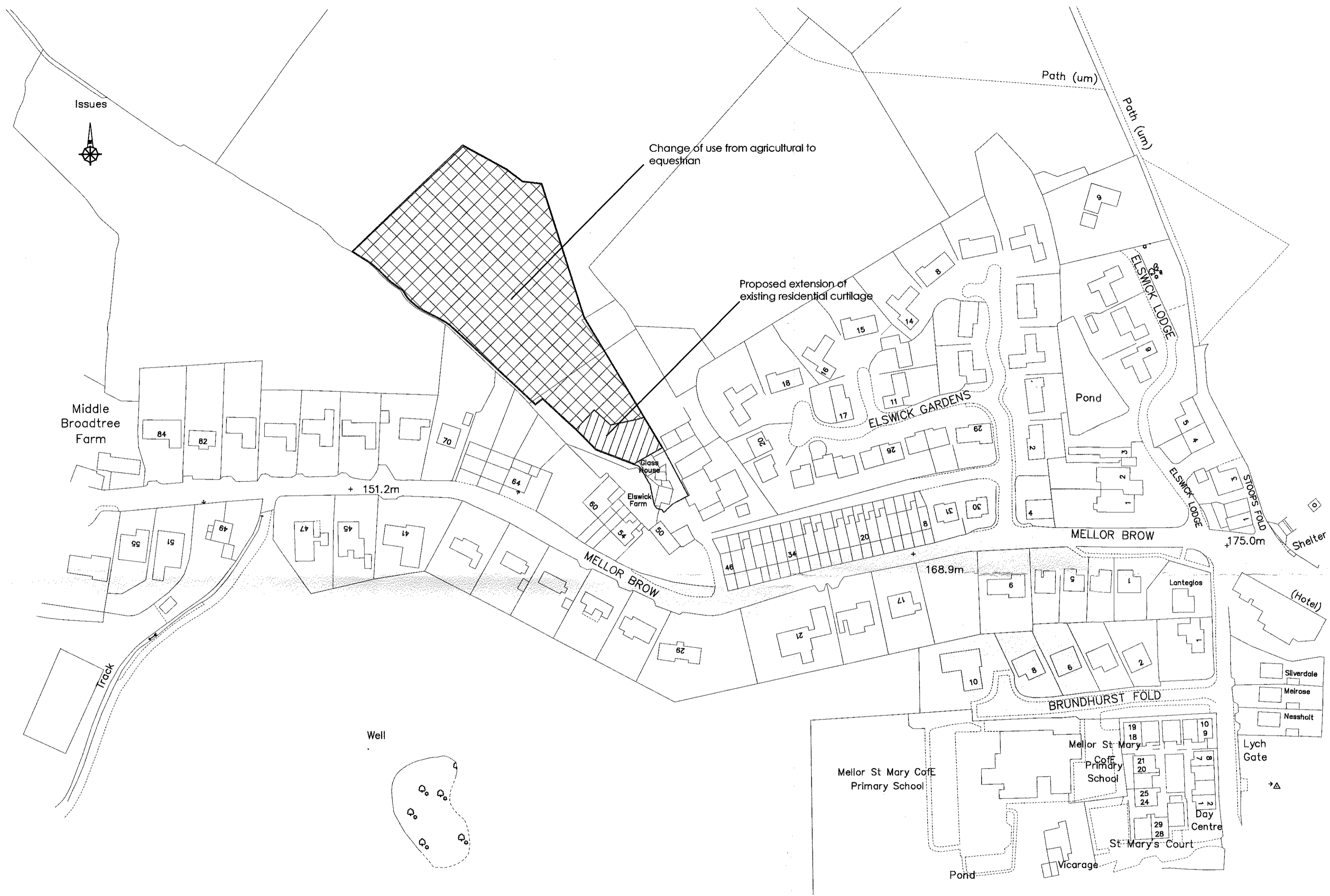
Job Title
 Proposed change of use from agricultural to equestrian use including alterations and external works to The Glass House, Mellor Brow, Mellor Lancashire BB2 7EX

320160954P

Drawing Title
Site Location plan

| | | |
|----------------------|----------------------|-------------|
| Scale 1:1250 @ A2 | Date October 2016 | Drawn PG |
|----------------------|----------------------|-------------|

SITE LOCATION PLAN

[SCALE 1:1250]

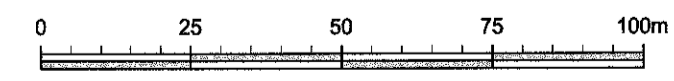

SUNDERLAND PEACOCK & ASSOCIATES LTD.
 HAZELMERE, FIMLICO ROAD, CLITHEROE
 LANCASHIRE, BB7 2AG
 T 01200 423178 F 01200 427328
 E info@sunderlandpeacock.com
 www.sunderlandpeacock.com



4855 - P05A