

LAYOUT PLAN - KIRK MILL

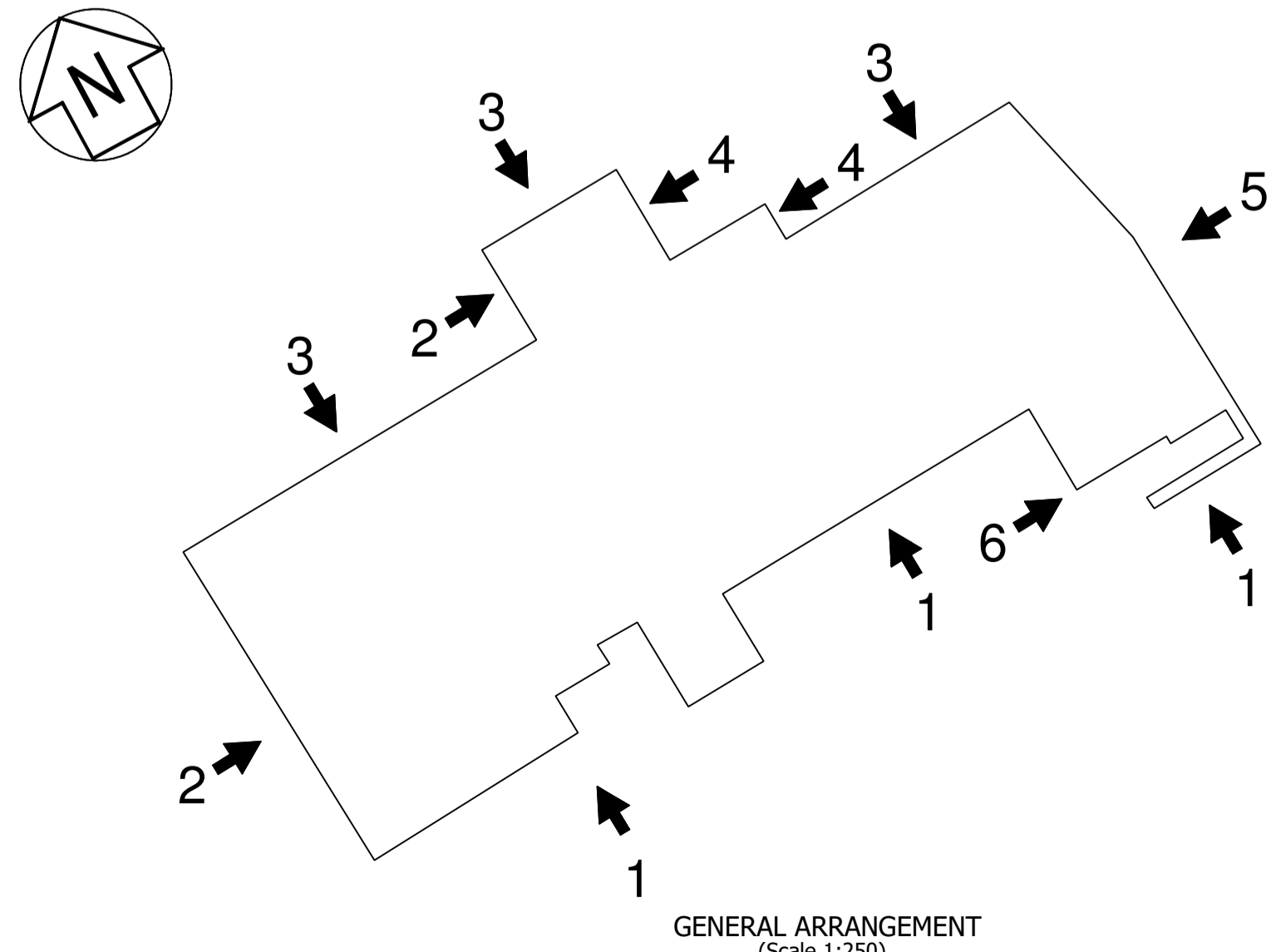

FULL REPOINT REQUIRED

ELEVATION 1
SOUTH ELEVATION
(Scale 1:50)

ALL CAST IRON RAINWATER
GOODS TO BE RENEWED

NOTES

- DO NOT SCALE FROM THIS DRAWING.
- ALL DIMENSIONS IN MILLIMETERS UNLESS NOTED OTHERWISE.
- DRAWINGS TO BE READ IN CONJUNCTION WITH ALL OTHER RELEVANT DRAWINGS AND SPECIFICATIONS.
- REFER TO ARCHITECTS DRAWINGS FOR WINDOW, ROOF & DOOR REFURBISHMENT.

CDM

FLOODING - THE CONTRACTOR IS TO ENSURE THAT ANY DRAINAGE WORKS ON EXISTING DRAINAGE ARE CARRIED OUT IN SUCH A MANNER AS TO MAINTAIN EXISTING FLOWS. REFERENCE TO LOCAL WEATHER FORECASTS SHOULD BE ADOPTED.

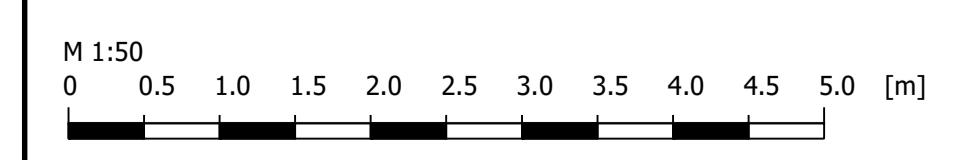

B				
A		07.10.16	DW	Issued for Tender
Revision	Date	By	Description	
 Civil and Structural Engineers				
The Heath Business & Technical Park, Runcorn, Cheshire WA7 4QX Tel 01928 518008 Email eng@gravitateconsulting.com				
Client	SCPI BOWLANDS LTD			
Site	CHIPPING			
Project	KIRK MILL			
Drawing Title	ELEVATION 1			
Status :	Tender	Date:	OCT 16	
Scale :	1:50	Job Number:	12-155	
Drawn By:	CC	Drawing Number:	1	
Checked By:	RS	Revision:	A	