

This drawing is to be read in conjunction with all relevant Architectural, structural and specialist drawings and specifications. The Architect is to be notified of any discrepancies before proceeding. Do not scale from this drawing. All dimensions and levels are to be checked on site. This drawing is subject to copyright. All work carried out before Planning and Building Permission has been granted is at the contractor's risk.
 NOTE: All dimensions are to the face of blockwork /studwork (not to plaster finish).

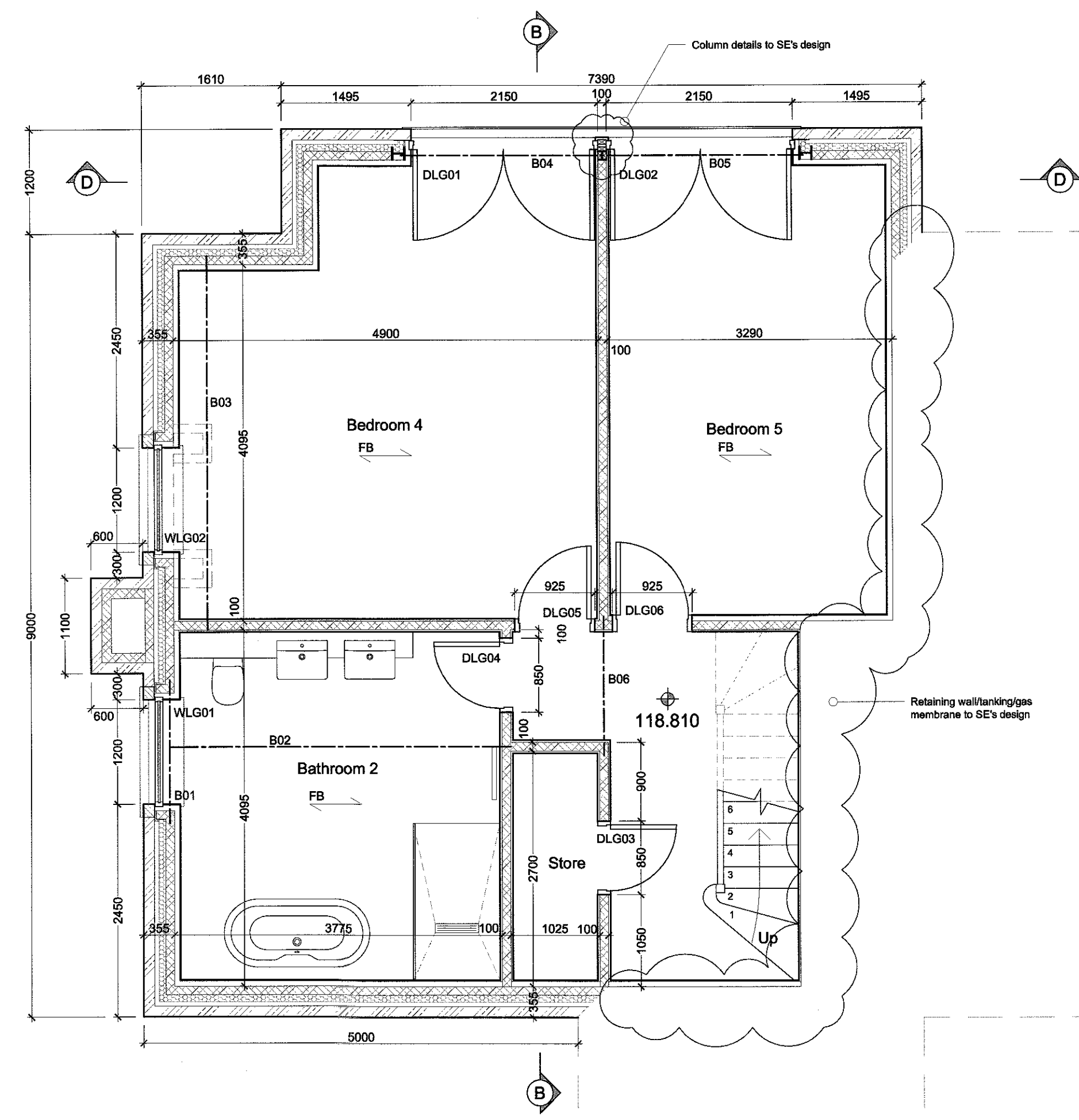

Lower Ground Floor Plan
 1:50 Scale

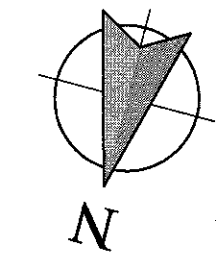

All dimensions given to face of stone/block/studwork

- Materials**
- Roof**
 Natural blue slate and lead flat where applicable.
 Powder coated aluminium rainwater goods to be dark grey.
 Eaves/verge roof overhangs to have dark grey fascia/barge boards with white soffits.
 - Walls**
 Natural coursed stone with dressed cills, heads and string course.
 - Windows/patio doors**
 Powder coated (dark grey) frames.
 - Doors**
 Painted timber.
 - Garage doors**
 Composite or powder coated aluminium.

REVISIONS:
 Rev A - Garage orientation and link size amended.
 12.10.16 - NE

3 201 610 19

Client
 J.J. Construction (NW) Ltd.

Job Title
 Proposed Erection of 10 houses on land off Chatburn Old Road Chatburn

Drawing title
 Plot 6
 Proposed Foundation Plan and Lower Ground Floor Plan

Scale
 1:50 @ A1

Date
 August 2016

Drawn
 NE

spa
 ARCHITECTS

SUNDERLAND PEACOCK ARCHITECTS
 SUNDERLAND PEACOCK & ASSOCIATES LTD.
 HAZELHIRE, PIMLICO ROAD, CLITHEROE
 LANCAHIRE, BB7 3AG
 T 01202 423176 F 01200 427268
 E info@sunderlandpeacock.com
 www.sunderlandpeacock.com

5138 - 42 Rev A

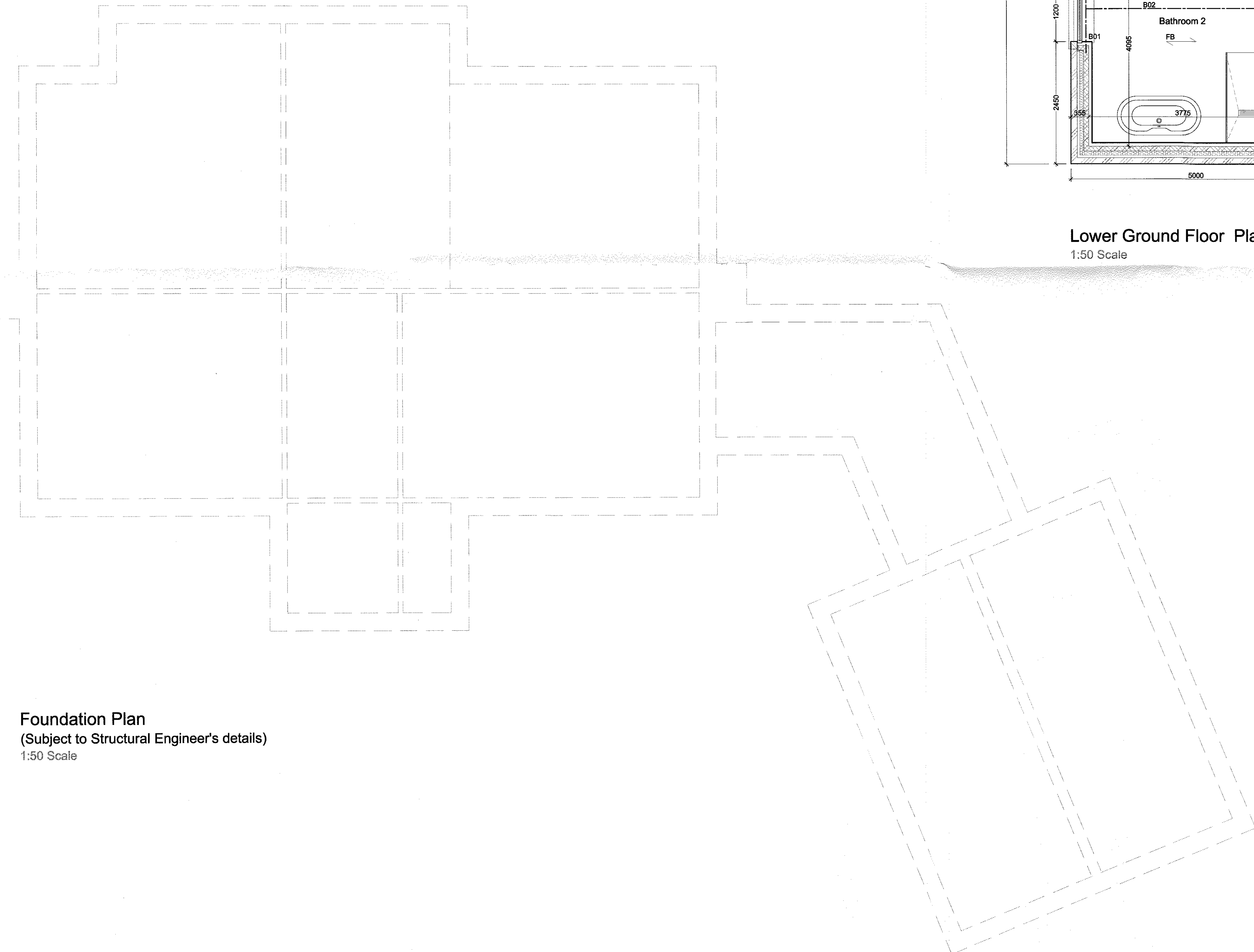

Foundation Plan
 (Subject to Structural Engineer's details)
 1:50 Scale