

FOUNDATION DETAILS

HATCH	DESCRIPTION	SURFACE	BINDER	BASE	SUB/BASE/CAPPING
[Pink Hatched]	AREA OF RESURFACING	Where proposed levels are <40mm lower than existing: 40mm SMA 10 Surf 40/60 (PSV 65) carriageway to be planed off to a depth of 40mm	Contractor to review Isopachytes plan to determine requirement	N/A	N/A
		Where proposed levels are higher than existing: 40mm SMA 10 Surf 40/60 (PSV 65) regulating/binder material is required	70mm (or as required) AC20 Dense Bin 40/60 rec to BS EN 13108-4	100mm (or as required) AC32 Base 40/60 rec to BS EN 13108-4	
[Green Hatched]	AREA OF FULL DEPTH NEW CONSTRUCTION	40mm SMA 10 Surf 40/60 (PSV 65)	70mm AC20 Dense Bin 40/60 rec to BS EN 13108-4	100mm AC32 Base 40/60 rec to BS EN 13108-4	CBR >8% - 300mm of type 1 sub-base CBR >2-8% - 150mm of type 1 sub-base over 400mm of 6F2 capping CBR <2% - 150mm of type 1 sub-base over 600mm of 6F2 capping
[Blue Hatched]	AREA OF NARROW WIDENING CONSTRUCTION	40mm SMA 10 Surf 40/60 (PSV 65)	70mm AC20 Dense Bin 40/60 rec to BS EN 13108-4	345mm Concrete Type ST4	N/A

NOTES

1. THE HIGHWAY AUTHORITY IS LANCASHIRE CC.
2. ALL WORKS ARE TO BE CARRIED OUT IN ACCORDANCE WITH THE APPROVED CONTRACT DRAWINGS AND THE MANUAL OF CONTRACT DOCUMENTS FOR HIGHWAY WORKS (SHW) VOLUME 1.
3. BITUMINOUS MATERIALS SHALL CONFORM TO BS EN 13108 AND SHALL BE SAMPLED AND TESTED IN ACCORDANCE WITH BRITISH STANDARDS, AND THE RESULTS MADE AVAILABLE FOR INSPECTION BY THE ENGINEER. LIMESTONE AGGREGATE IS NOT TO BE USED IN THE CARRIAGEWAY OR FOOTWAY SURFACE COURSES.
4. ALL EXISTING SERVICE COVERS AND FRAMES SHALL BE RAISED/LOWERED TO MATCH NEW LEVELS.
5. AGGREGATES FOR BITUMINOUS MATERIALS AND THE MIXED MATERIAL SHALL COMPLY WITH CLAUSE 901 OF THE DOT SPECIFICATION EXCEPT IN RESPECT OF SUB-CLAUSE 19.
6. THIS DRAWING IS TO BE READ IN CONJUNCTION WITH ALL OTHER RELEVANT DRAWINGS AND DOCUMENTS ASSOCIATED WITH VECTOS SERIES VD15354.
7. THE HIGHWAY WORKS SHALL BE INSPECTED /SUPERVISED BY REPRESENTATIVES OF THE HIGHWAY AUTHORITY. PRIOR TO COMMENCING WORK THE CONTRACTOR SHALL PROVIDE A DETAILED CONSTRUCTION PROGRAMME.
8. ANY DISCREPANCIES ON SITE MUST BE REPORTED TO THE LHA VIA THE DESIGNER IN WRITING.
9. DO NOT SCALE FROM THIS DRAWING. ALL DIMENSIONS MUST BE CHECKED/VERIFIED ON SITE.
10. ALL WORKS TO BE CARRIED OUT IN ACCORDANCE WITH THE HEALTH AND SAFETY AT WORK ETC.
11. IF APPLICABLE - ALL EXISTING WALL FOUNDATIONS TO BE REMOVED ARE TO BE BROKEN OUT DOWN TO A LEVEL 1.0M BELOW THE NEW SURFACE LEVEL. EXCAVATION TO BE BACKFILLED WITH SUITABLE FILL MATERIAL.
12. PRESENCE OF STATUTORY UNDERTAKERS EQUIPMENT IN THE HIGHWAY SHOULD BE VERIFIED BY THE CONTRACTOR ON SITE PRIOR TO STARTING ANY WORKS. THE LOCATION OF STATUTORY PLANT SHOWN ON ANY PLANS IS INDICATIVE ONLY AND SHOULD NOT BE RELIED UPON FOR THE LOCATION OF ANY PIPEWORK OR CABLING. THE CONTRACTOR SHOULD CONFIRM THE LOCATION OF ALL STATS PLANT BY HAND DUG TRIAL TRENCHES PRIOR TO COMMENCING ANY WORKS. ALLOWANCE FOR THE PRESENCE OF ALL STATS APPROPRIATE PROTECTION / DIVERSION MEASURES IS TO BE PUT IN PLACE BY THE CONTRACTOR (UNLESS STATED OTHERWISE) WHERE STATS EQUIPMENT ARE FOUND TO BE WITHIN THE AREA OF HIGHWAY WORKS.

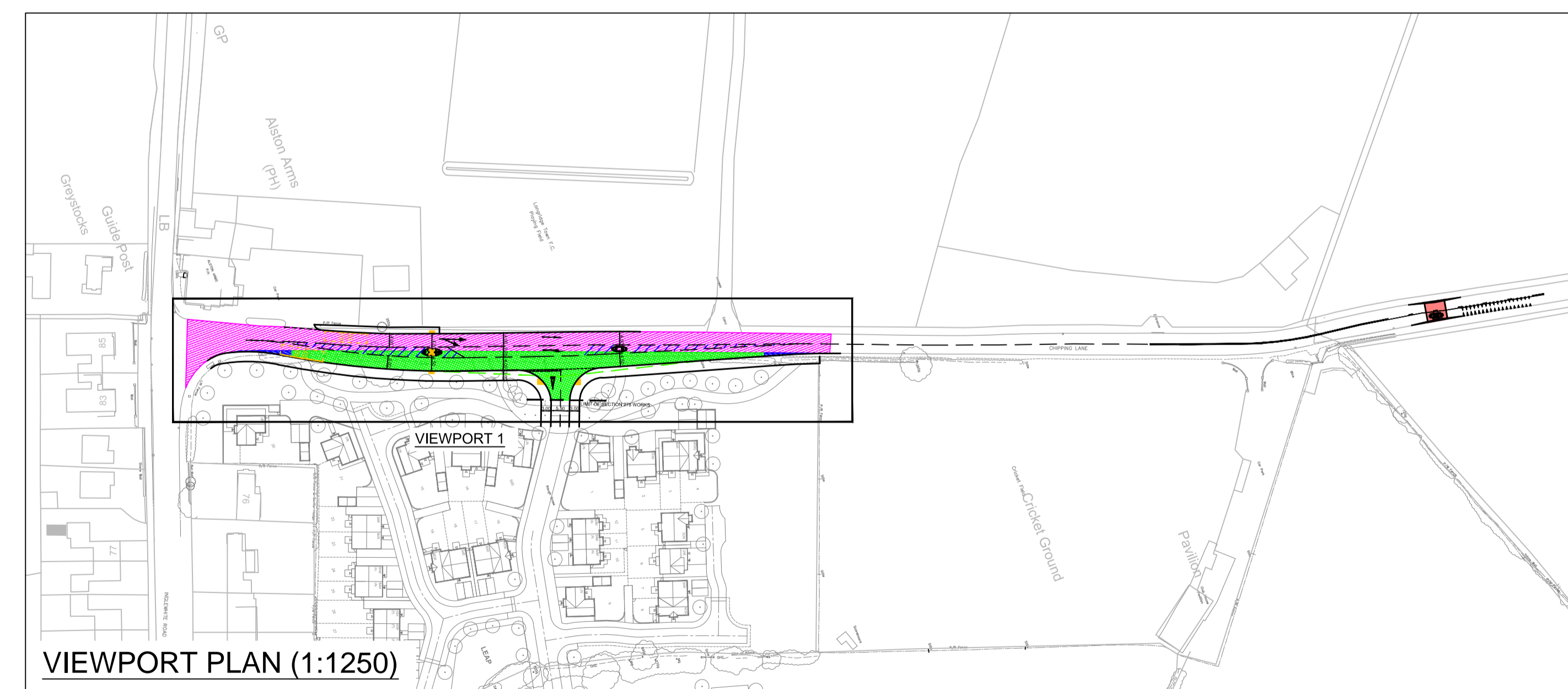

NOTE: THE PROPERTY OF THIS DRAWING AND DESIGN IS VESTED IN VECTOS (NORTH) LTD. IT MUST NOT BE COPIED OR REPRODUCED IN ANY WAY WITHOUT THEIR PRIOR WRITTEN CONSENT.

REV.	DETAILS	DRAWN	CHECKED	DATE	REV.	DETAILS	DRAWN	CHECKED	DATE	Notes:
A	Layout amended	SR	MIS	Jan 2016						
B	Phase 2 access removed.	TF	SR	June 2016						
C	Southern footway tie in amended to avoid BT cabinet	TW	SR	Aug 2016						

PROJECT: CHIPPING LANE, LONGRIDGE				CLIENT: BARRATT HOMES	
DRAWING TITLE: Sc278 HIGHWAY IMPROVEMENT WORKS - PHASE 1 PAVEMENT CONSTRUCTION PLAN					
DRAWN: MF	CHECKED: SR	DATE: 06/01/2016	SCALE: 1:250 @ A1	DRAWING NUMBER: VD15279-700	REVISION: C

