

Ordnance Survey
Ukmapcentre.com

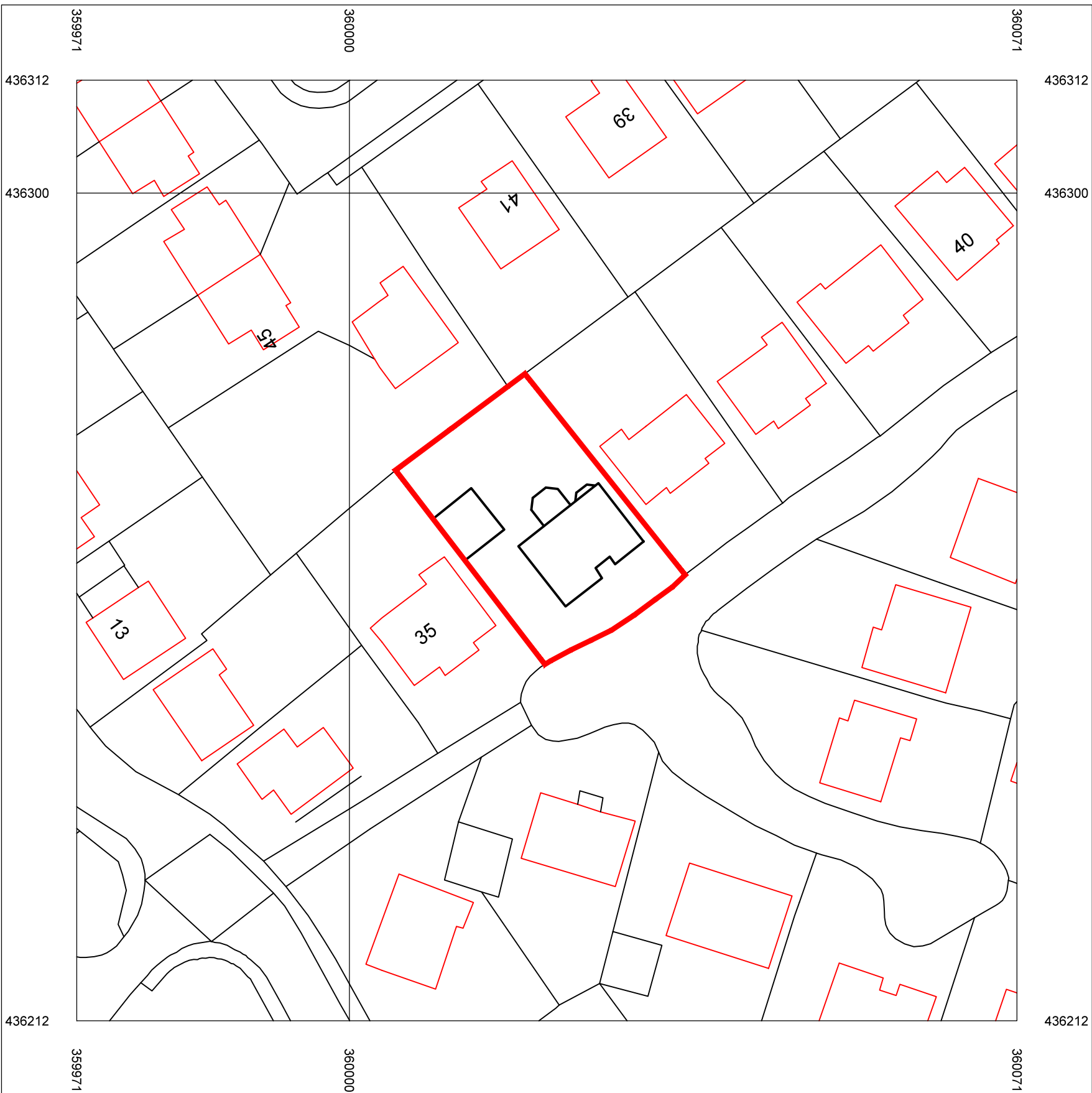

Serial number: 88062

© Crown copyright and database right 2016
Ordnance Survey licence 100048957
Reproduction in whole or in part is prohibited
without the prior permission of Ordnance Survey

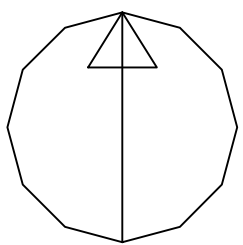
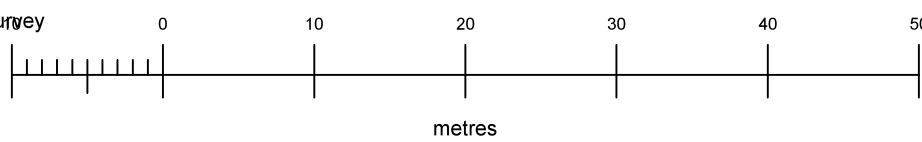

Ordnance Survey
Ukmapcentre.com

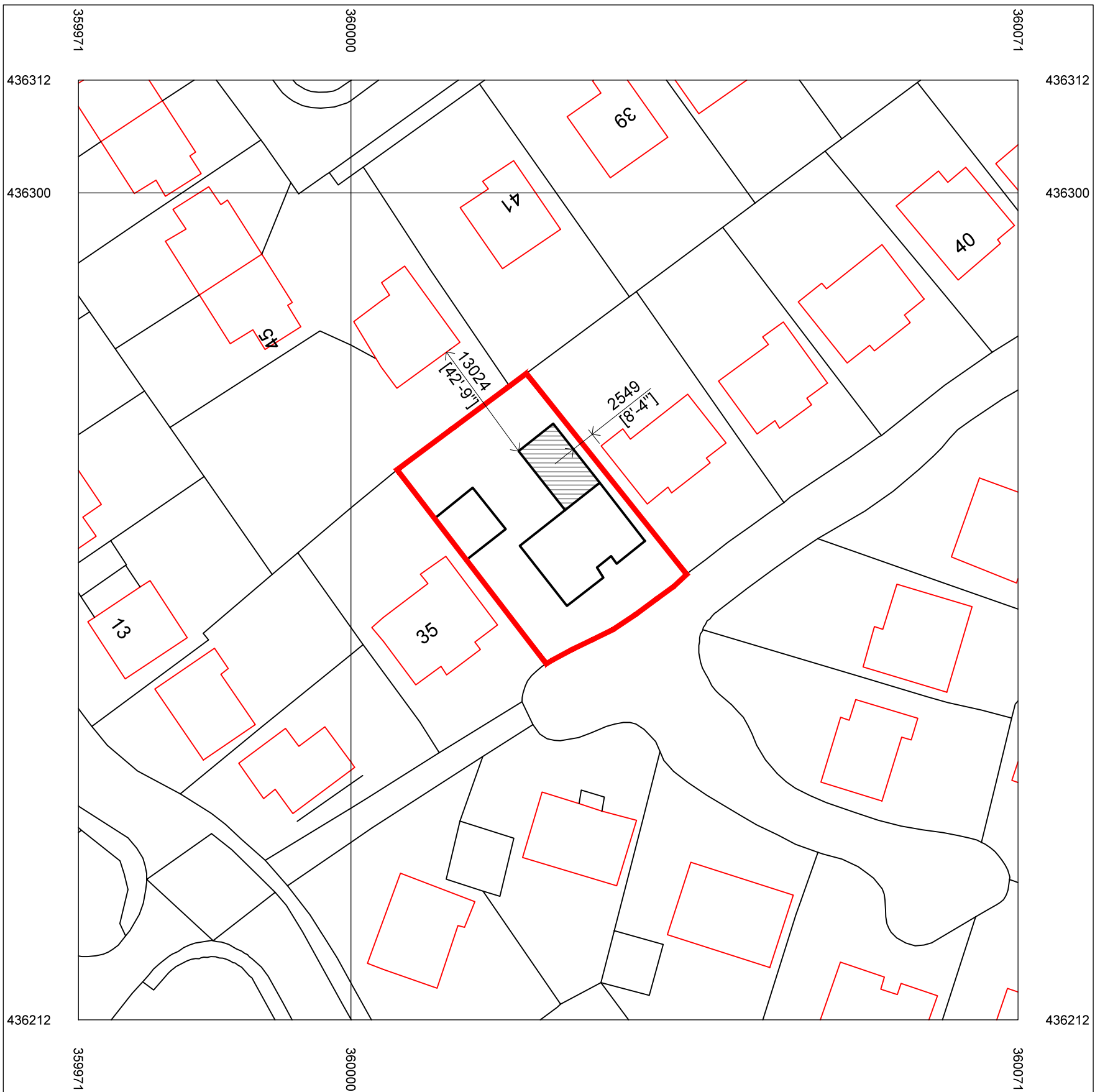

Serial number: 88062

© Crown copyright and database right 2016
Ordnance Survey licence 100048957
Reproduction in whole or in part is prohibited
without the prior permission of Ordnance Survey

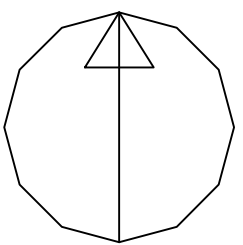
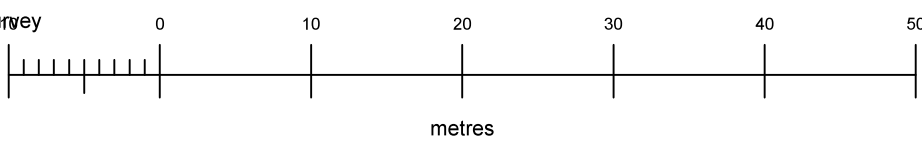

Project Information:

Client: Mr. G. Baker

Project Title: Renovation, Extension & Loft Conversion

Project Address: 36 College Close, Longridge, Preston, PR3 3AX

Project Stage: Building Regulation Application

Date of Drawing: 16.03.16

Drawn By: SLP

Drawing Sheet Size: A1 (841 x 594)

Drawing Scale: 1:500

Drawing Title:

Site Plans as 'Existing' & 'Proposed'

Job Number: Drawing Number: Revision:

0251 (S)2-01-BR -

DO NOT SCALE ONLY USE DIMENSIONS SHOWN
© COPYRIGHT RESERVED

Drawing Revisions

Rev.	Date	Description	Author
------	------	-------------	--------

Copyright © 2015 Style Design & Architecture Ltd.
All Rights Reserved

Deviating from these drawings without consultation and/or agreement with the employer is unacceptable. This drawing is indicative and exact dimensions should be checked and confirmed on site by the nominated contractor or competent persons prior to commencement of building works. All drawings and dimensions shall be verified by the relevant contractor's on site prior to commencement of any works, ordering of materials or setting out. Any discrepancies should be reported writing to SDA Architecture Ltd.

Do not scale from this drawing unless trained to use a scale ruler - only work from written and checked dimensions. This drawing is the property of SDA Architectur Ltd and copyright reserved by them. This drawing is not to be used, copied or disclosed by or to any unauthorised persons without prior written authorisation consent from SDA Architecture Ltd.

DO NOT PROCEED WORKS IN THE EVENT OF A DRAWING DISCREPANCY

For all structural aspects please refer to Structural Engineers project information. cross reference all drawings, details and calculations with the architectural drawing prior to commencement of building works.

SDA Architecture Ltd is a trading name of Style Design and Architecture Ltd and holds no responsibility or liability for any works carried out on site.