

Notes

1. FULL DEMOLITION OF BUILDINGS 1, 2, 5, 6, 7, 8, 9, & 10 - EXISTING BUILDING STRUCTURE TO BE COMPLETELY DEMOLISHED INCLUDING SUPER STRUCTURE, GROUND FLOOR SLAB & FOUNDATIONS. ALL TIMBER & METALS TO BE REMOVED OFF SITE. MASONRY & CONCRETE TO BE CRUSHED AND STOCK PILED LOCALLY. REBAR TO BE REMOVED.
2. CONCRETE FRAMED BUILDINGS 3&4 - REINFORCED CONCRETE PORTAL FRAMED BUILDINGS TO BE DEMOLISHED TO GROUND FLOOR SLAB LEVEL. GROUND FLOOR TO BE LEFT IN PLACE FOR FUTURE USE.
3. EXISTING BUILDING 8 - NORTH END OF THE STRUCTURE TO BE LEFT UNDEMOLISHED SOUTH SECTION OF THE BUILDING TO FULLY DEMOLISHED SEE NOTE 1.
4. BUILDING 7 IS AN EXISTING HW SUBSTATION AND WILL BE RETAINED. ADEQUATE SWAMP RESERVOIRS SHOULD BE PUT IN PLACE TO PROTECT THIS BUILDING FROM DAMAGE BY BUILDING WATERS.

KEY

- FULL DEMOLITION Note 1
- DEMOLITION TO GROUND SLAB NOTE 2
- BUILDING TO BE RETAINED FOR RENOVATION NOTE 3
- BUILDING TO BE RETAINED AND PROTECTED FROM BUILDING WORKS NOTE 4
- ESTIMATED POSITION OF COMBINED SEWER
- ESTIMATED POSITION OF UNDERGROUND HV POWER LINE
- Boundary

CDM

Notes below are additional to hazards/risks normally associated with this type of work

- Location Adjacent to Running water Course
- Running HV Sewer running under building 4
- Live HV Cables and Transformers
- Asbestos See Report ASTRA28041.1J53N

These notes are based on the use of experienced and competent contractors carrying out the work using an approved safe method of working

Revision	Date	By	Description
A	12.05.14	JT	Issued for Tender

gravitate consulting
Civil and Structural Engineers

The Health Business & Technical Park, Rumcom, Cheshire WY4 4QX
Tel: 01928 353 847
Email: eng@gravitateconsulting.com

SCPI BOWLAND Ltd

CHIPPING

NEW HOTEL

Drawn To Scale: **DEMOLITION GA PLAN**

Status:	Tender	Date:	April 2014
Scale at A1:	1:500	Job Number:	12-155
Drawn By:	JT	Drawing Number:	D1
Checked By:	RS	Revision:	A

ASBESTOS FOR ALL DETAILS ON THIS PLAN SEE ASBESTOS REPORT ASTRA28041.1J53N

Building	Area m ²	Description
1	1885	Masonry & Steel Structure, 2 Storey Building
2	558	Masonry Structure, 2 Storey Warehouse
3	1347	Reinforced Concrete Portal Frame Building
4	1686	Reinforced Concrete Portal Frame Building
5	21	Masonry Single Storey
6	64.5	Masonry Single Storey
7	92	Masonry Sub Station Single Storey
8	1885	Masonry Barn 2 Storeys
9	1885	Small 1 Storey Steel Shed
10	1885	Steel Bridge Compriated Cladding

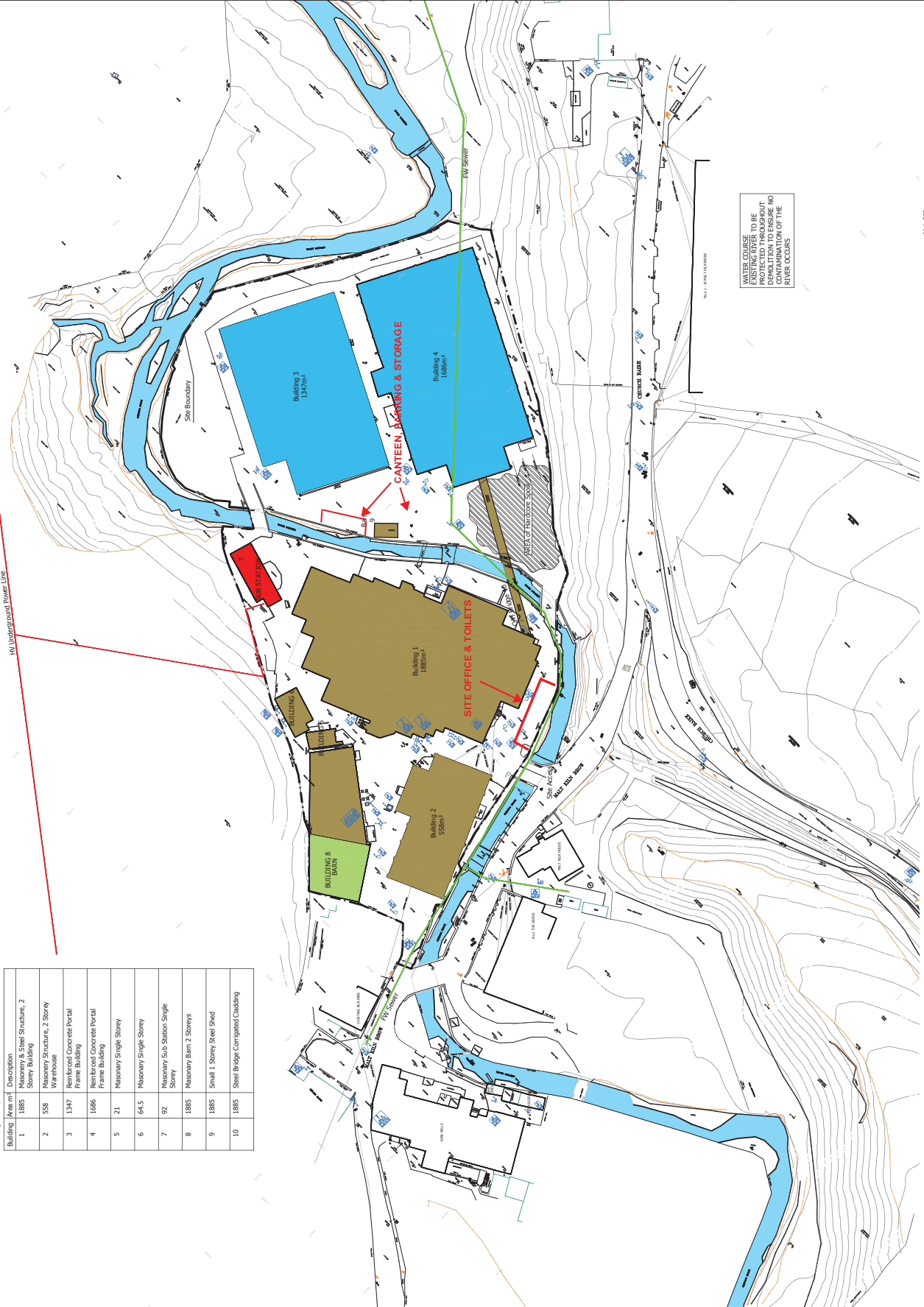

WATER COURSE TO BE PROTECTED THROUGHOUT DEMOLITION TO ENSURE NO CONTAMINATION OF THE RIVER OCCURS

M 1:500
0 5 10 15 20 25 30 35 40 45 50 [m]