

320170590P

Proposed change to bedroom window from the approved plan, into a Juliet Window with a 1.1m balustrade, gap between rails to be a max of 100mm.



Proposed Rear Elevation



As Approved Rear Elevation



Existing Rear Elevation

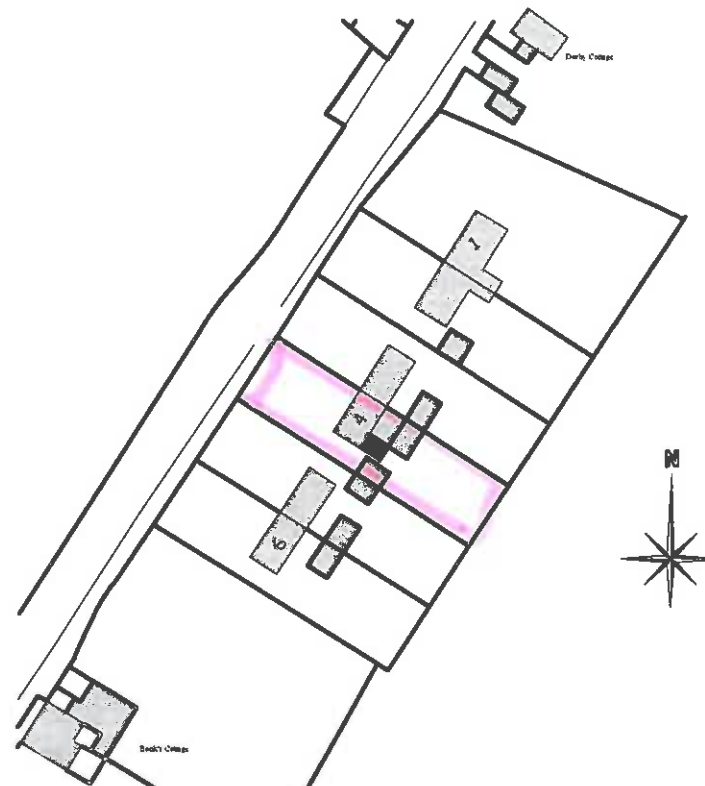

Ordnance Survey (c) Crown Copyright 2016. All rights reserved. Licence number 100022432

Client Mr & Mrs Guisef	
Location 4 Beacon View, Chipping Road, Longridge. Ribble Valley PR3 2NB	
Project Alteration to the approved plan 3/2016/0797	
Drawing Non Material Planning Application	
Agent APB Consultant Building Surveyors 1 Maple Grove Ramsbottom BL0 0AN Telephone 01706 826300 Mobile 07976404449	
Scale 1:100 & 1/1250	Date 19th June 2017
Drawing No. DWG/01/R	Revision A
<p>This drawing is provided for planning & Building Regulations consent only. The contractor must check all dimensions on site before works are commenced. The contractor must comply with all requirements of the Health & Safety Regulations.</p> <p>DO NOT SCALE THIS DRAWING</p>	