

## KEY

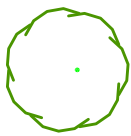

Existing trees, hedges and vegetation to be retained.



Existing trees, hedges and vegetation to be removed



Proposed Extra heavy standard (14-16cm girth) tree

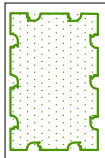

Proposed ornamental shrub planting

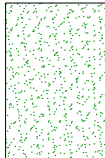

Proposed turf

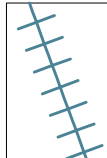

1100mm high hoop top fence to be retained

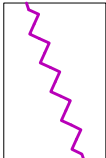

600mm high timber knee rail to be retained



1025mm existing brick wall

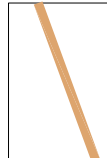

1025mm proposed brick wall  
(detailed by others)

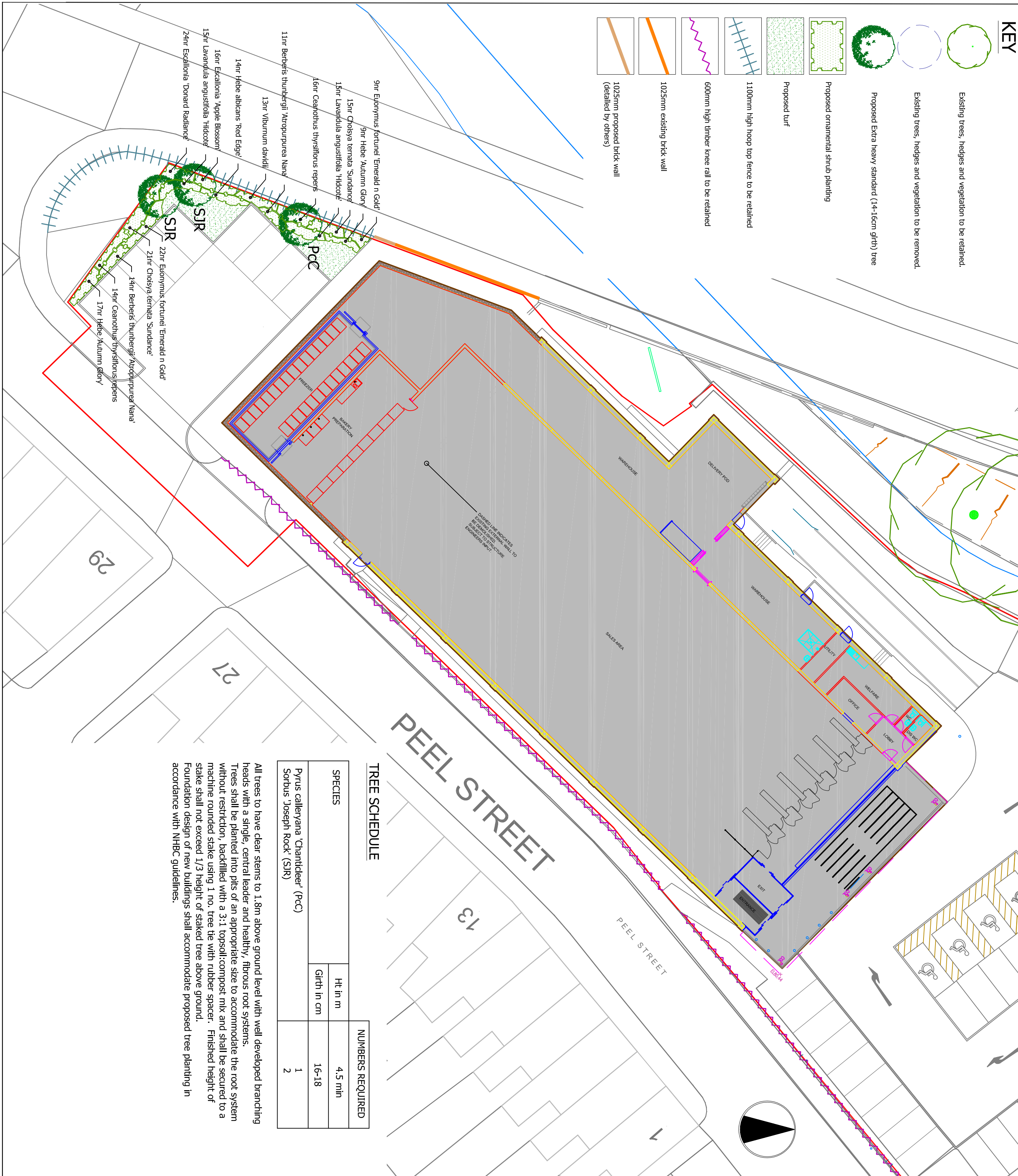

## PROTECTION OF EXISTING VEGETATION

Trees to be protected where necessary during works by a tree protective barrier, secured to a scaffold tubing framework with fluorescent tape to the top rail. Protective fending shall be erected on the canopy drip line wherever possible. Laminated, waterproof A4 signs shall be fixed to the fence posts at 10m intervals bearing the words 'PROTECTED TREE ZONE - NO STORAGE OR OPERATIONS WITHIN FENCED AREA'.

Tracking of machinery, storage of chemicals and building materials shall not be permitted within the protected area. Leaks or spills should be removed immediately and the contaminated soil replaced. No bonfires shall be lit within 5m of the canopy spread. Any excavation work beneath the canopy spread shall be carried out by hand.

All works affecting trees within the development shall be subject to BS 5837:2012.

## PLANTING SCHEDULES

A proprietary black geotextile mulch is to be installed between the soil and mulch of all the planted areas, cut with T or X slits to fit around the plants as required. All plant material shall be a minimum of 31 pot size unless otherwise specified and conform to BS5336 Part 1 and BS 4428. Finished beds shall be lightly forked over and dressed with 50mm coarse amenity grade dark mulch (nominal particle size 5-75mm - sample to be approved).

ORNAMENTAL PLANTING SCHEDULE				
Shrub				
Nr	Name	Ht in cm	Pot(L)	Density
25	Berberis thunbergii 'Atropurpurea Nana'	20-30cm	3L	5.00
30	Ceanothus thyrsiflorus repens	30-40cm (D)	3L	5.00
36	Croisya ternata 'Sundance'	30-40cm	3L	5.00
16	Escallonia 'Apple Blossom'	30-40cm	3L	5.00
24	Escallonia 'Donard Radance'	40-60cm	3L	5.00
31	Eunonymus fortunei 'Emerald n Gold'	20-30cm (D)	3L	5.00
14	Hebe albicans 'Red Edge'	20-30cm	3L	5.00
26	Hebe 'Autumn Glory'	20-30cm	3L	5.00
30	Lavandula angustifolia 'Hilcote'	20-30cm	3L	5.00
13	Viburnum davidii	20-30cm	3L	5.00

All shrub material shall be first quality, sturdy, well rooted non-refrigerated stock with well branched heads and fibrous root systems. Shrubs shall be planted into 450mm good quality fibrous topsoil incorporating organic compost and slow release fertiliser in accordance with all good horticultural practice.

## TURFING

The topsoiled area to be turfed, is to be grade and cross-graded to even running falls, to allow the finished levels of the turf to be 40mm above the adjoining paved areas. The surface should be lightly and uniformly firmed by rolling or treading and reduced to a fine tilth up to 25mm in depth. All rubbish, stones greater than 50mm in diameter etc, shall be removed from the surface.

Apply an even application of approved fertiliser at a rate of 70g/m<sup>2</sup> and rake in. No turves shall be laid in exceptionally frosty weather or in other unsuitable weather conditions. The turves shall be laid in a stretcher bond pattern, closely butted and firmed into position, to the correct levels. The turves should be laid off plants, working over turves previously laid. A dressing of fine, sifted topsoil (complying with BS 3882) should be applied to the laid turf and brushed well into the joints.

LINE CODES		NUMBERS REQUIRED
SPECIES	Ht in m	4.5 min
	Girth in cm	16-18
Pyrus calleryana 'Chanticleer' (PC)		1
Sorbus 'Joseph Rock' (SR)		2

## TREE SCHEDULE

All trees to have clear stems to 1.8m above ground level with well developed branching heads with a single, central leader and healthy, fibrous root systems. Trees shall be planted into pits of an appropriate size to accommodate the root system without restriction, backfilled with a 3:1 topsoil/compost mix and shall be secured to a machine rounded stake using 1 no. tie with rubber spacer. Finished height of stake shall not exceed 1/3 height of staked tree above ground. Foundation design of new buildings shall accommodate proposed tree planting in accordance with NHBC guidelines.

<div><div><div>Sue Farmer BA MAud MA Landscape Architect</div></div><div><div>fdalandscape</div></div><div><div>Westleigh Hall Wakenfield Road Derby DE1 Huddersfield HD8 8QJ telephone 01484 866161 fax 01484 866166 isdh 01484 866900 email info@fdalandscape.co.uk www.fdalandscape.co.uk</div></div></div>					client
Lidl GmbH UK					
project					
Proposed Store Extension					
SHAWBRIDGE STREET, CLITHEROE					
drawing title					
LANDSCAPE DETAILS					
scale	date	drawn by	drawing no		
1:250	May17	SEL	R/1989/1		
@A2					