

# Proposed Residential Development at Whalley Road, Hurst Green

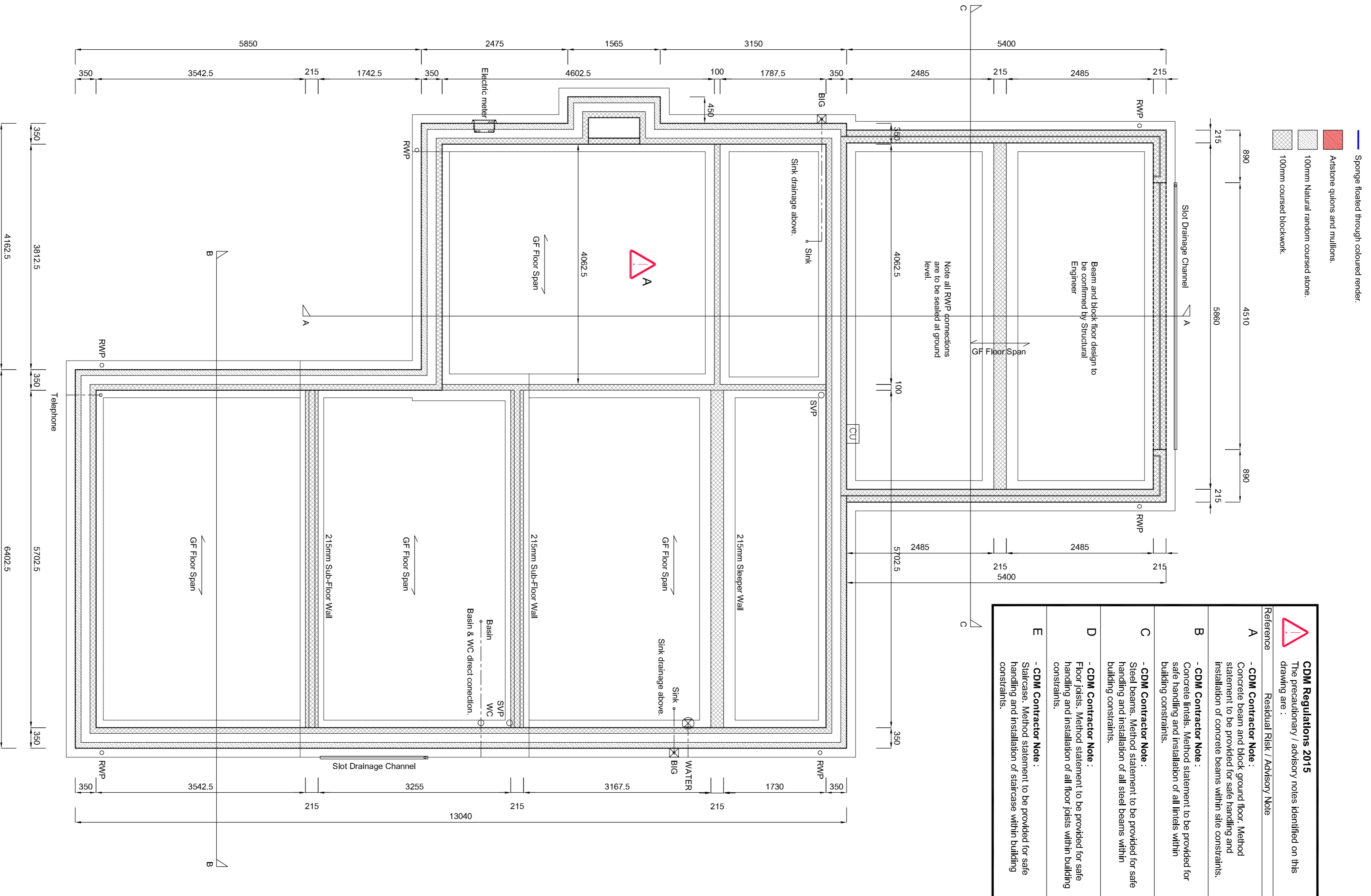

Foundation Plan

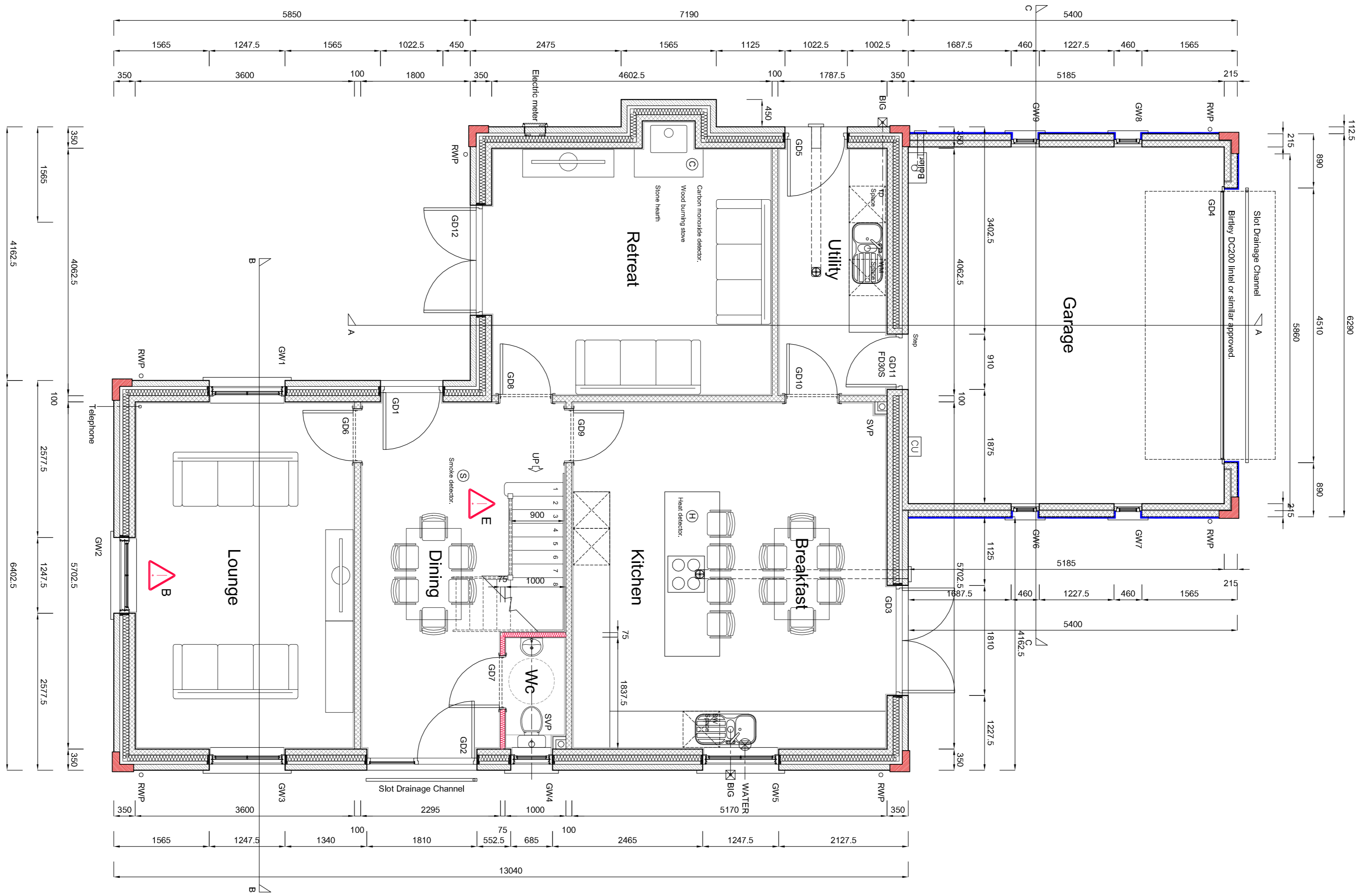

Ground Floor Plan

# Plot 01 (House Type K 2075) - Foundation and Ground Floor Plans



**NOTE: Superstructure design to be checked and confirmed by Structural Engineer prior to construction.**

**Building Regulation Notes:**

Approved Document B.

All steelwork to be provided with 1 hr fire resistance as an element of structure.  
To be installed in accordance with manufacturers instructions.

All 2.5 storey dwelling protected stairways to have a min. 30 minutes fire resisting construction to all perimeter walls, floors & ceilings.

Smoke Detector (S)  
Heat Detector (H)

Approved Document E.

Stud wall to achieve a minimum airborne sound reduction of 50dB.

Approved Document F.

Mechanical extractor ventilation to be provided as follows:

- Kitchen 60 Litres / Second (30 Litres / Second hood extract)
- Utility 30 Litres / Second
- WC 6 Litres / Second
- Bathroom 15 Litres / Second
- En Suite 15 Litres / Second

Background ventilators to provide 135,000mm<sup>2</sup> ventilation area (192mm<sup>2</sup> 5 Bedroom house)  
Operable windows to provide 80% floor area purge extract for each room.

Rev	By	Note	Date
B	GF	External materials updated to Natural random coursed stone/sponge floated through coloured render. RWP moved Family room renamed to 'Retreat'. Artstone quions and mullions added.	23.10.17
C	GF	Mullions removed at clients request and foundation updated to BMC details GD12 replaced window.	17.11.17



53 The Barnery Lawrence Street York YO10 3WH T: 01904 653772  
F: 01904 653779 E: mail@pra-architects.com W: www.pra-architects.com

PROJECT Whalley Road, Hurst Green

TITLE Plot 01 - Foundation and GF Plans

CLIENT Hillcrest Homes

DATE 11.11.16 SCALE 1:50@A1

DWG NO Y81:1008:101 REVISION C

DRAWN JD CHECKED JD  
DO NOT SCALE FROM DRAWINGS. ANY DISCREPANCIES TO BE NOTIFIED TO THE ARCHITECTS. COPYRIGHT RESERVED