

broken line indicates relieving lintel (above timber lintel)
65mm rc builders lintel to carry blockwork
min.100mm bearing beyond timber lintel

broken line indicates relieving lintel (above timber lintel)
65mm rc builders lintel to carry blockwork
125x75mm RSA to carry stone
min.100mm bearing beyond timber lintel

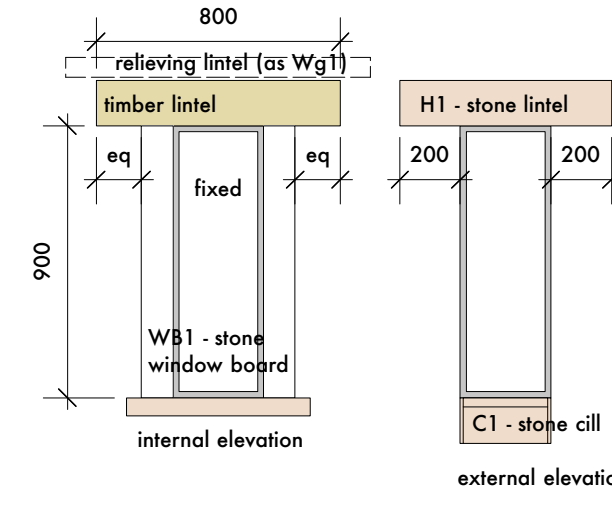

SLOT WINDOWS (as illustrated to left)
Wg1, Wg2, Wg4, Wg12, Wg18, Wf2, Wf3, Wf4, Wf6, Wf7, Wf8, Wf10, Wf17, Wf18
- triple glazed unit (as specified to drg.no.1716/41)
secured using 2no.75x20mm aluminium angles mounted back-to-back.
- aluminium angles polyester powder coated to match window frames (as drg.no.1716/41)
- aluminium angles fixed to internal masonry cheeks.
- glazing unit full isolated from frame using proprietary glazing gasket
- polysulphide sealant (eg Adshead Radcliffe ref.arboflex 500) to glass/frame junction.

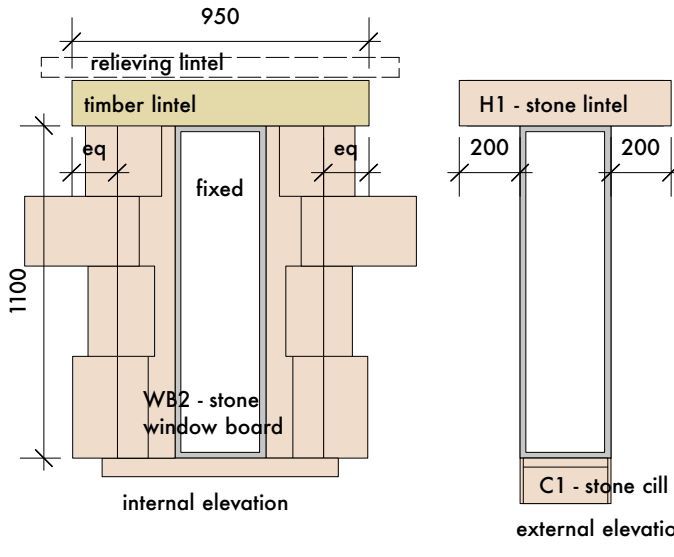
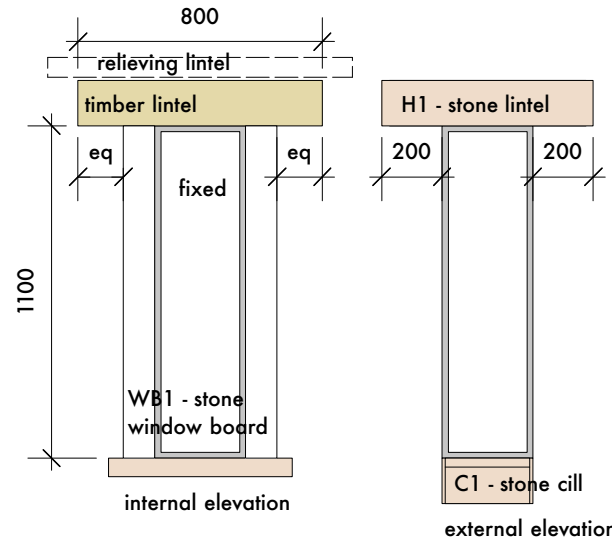
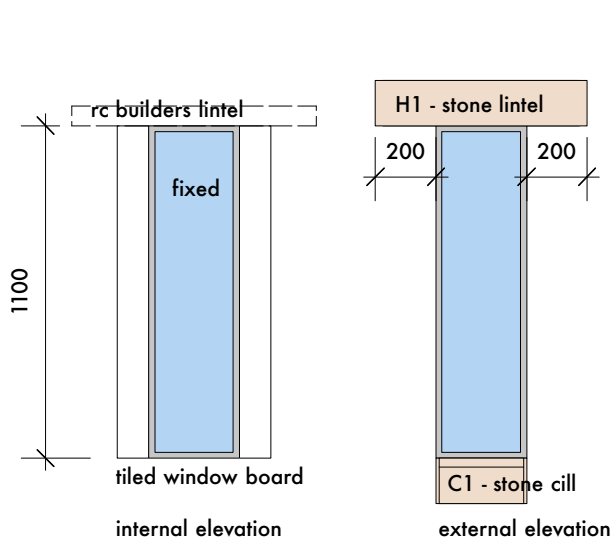
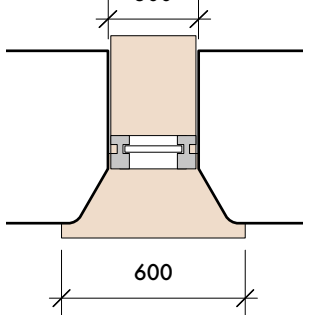
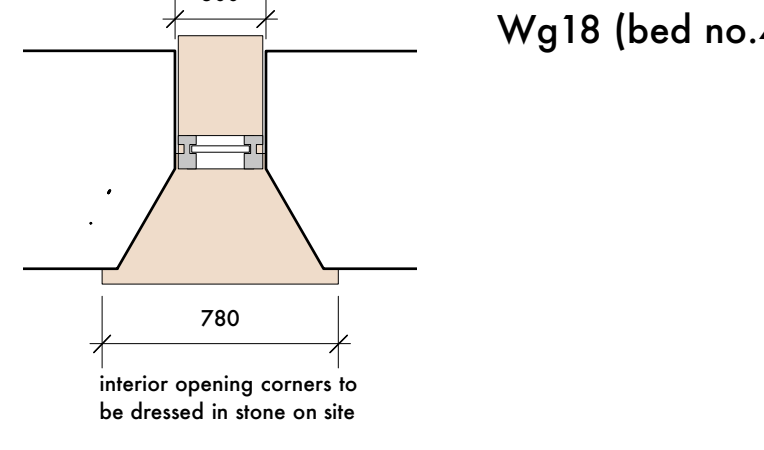
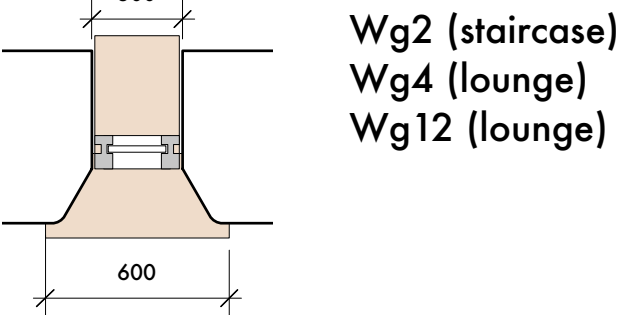
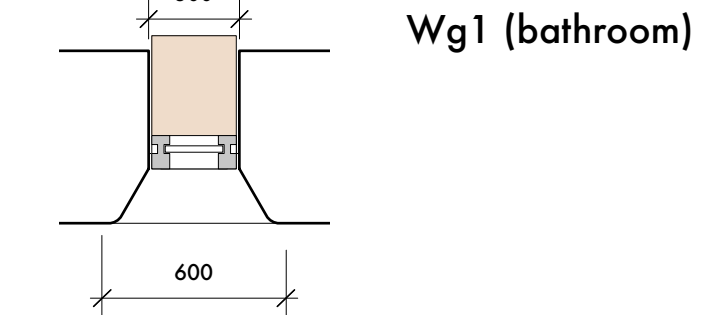
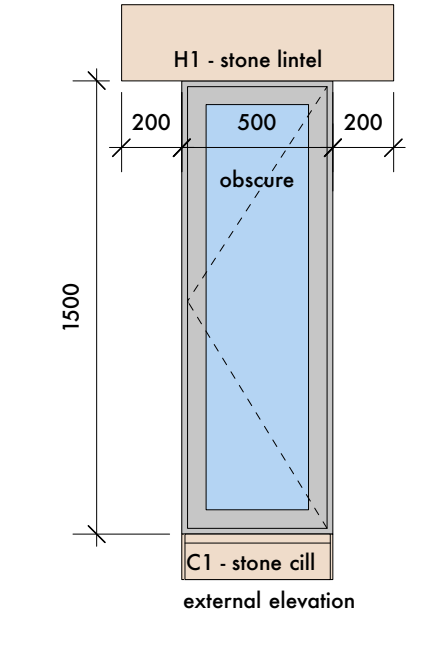
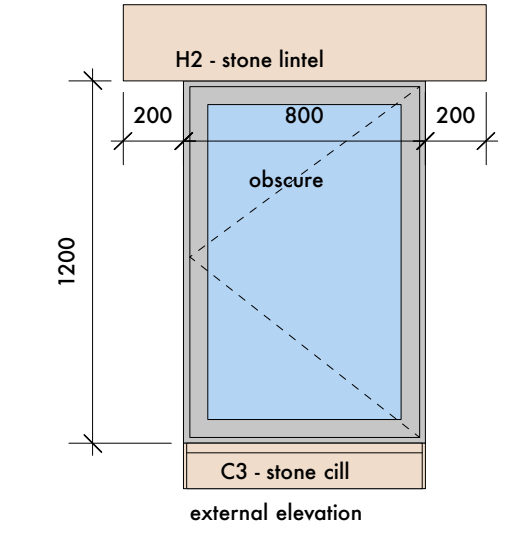
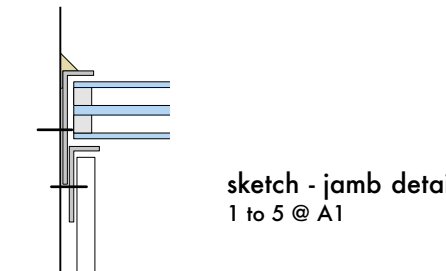

Wf2 (staircase)
Wf3 (staircase)
Wf4 (staircase)
Wf6 (bed no.1)
Wf7 (bed no.1)
Wf8 (bed no.1)
Wf10 (dressing)
Wf17 (bed no.3)
Wf18 (bed no.3)

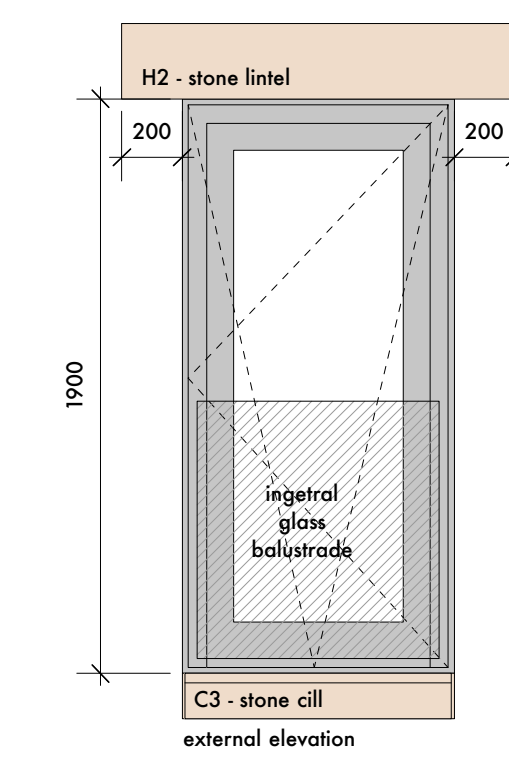
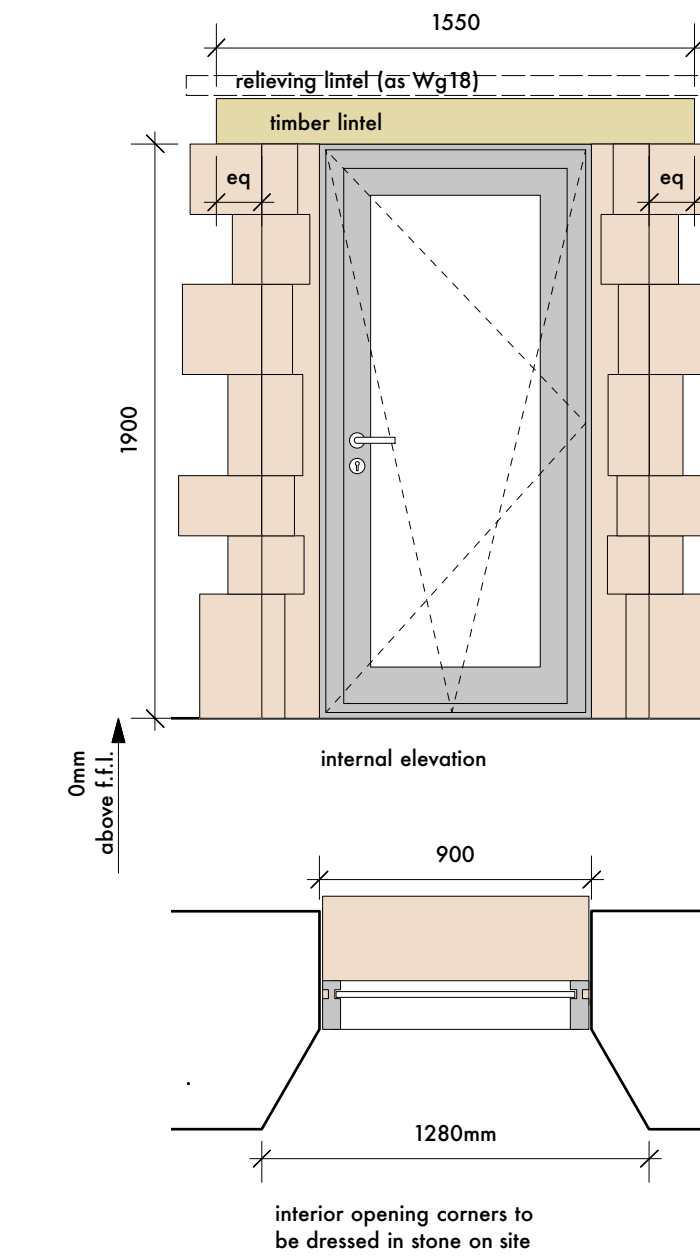
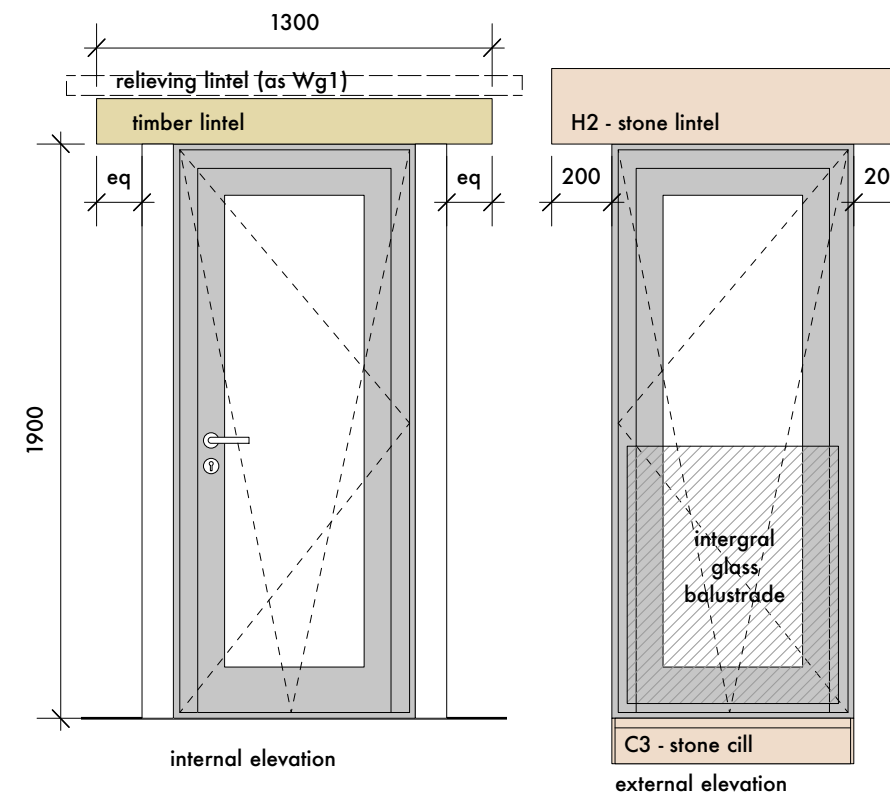
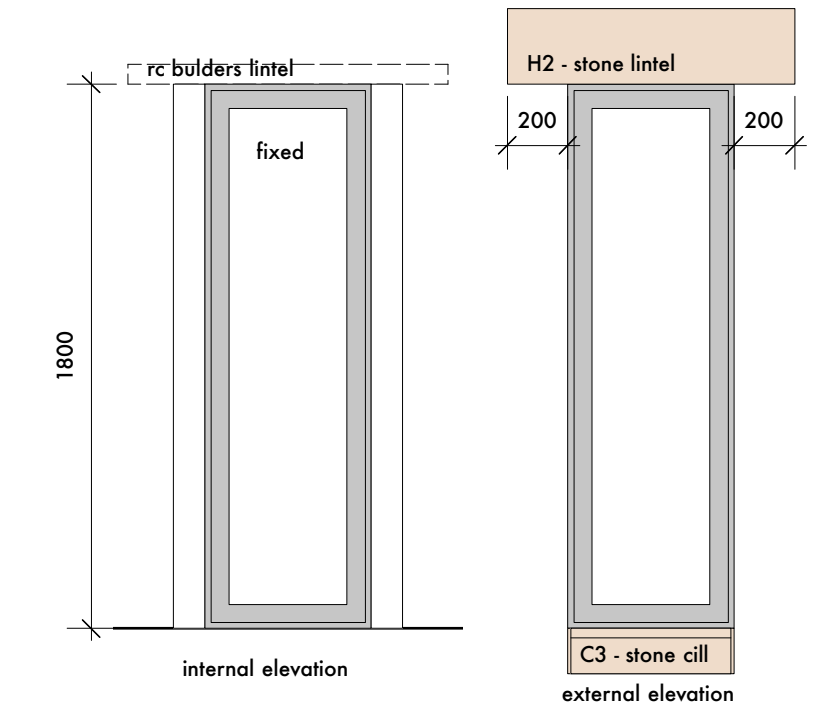
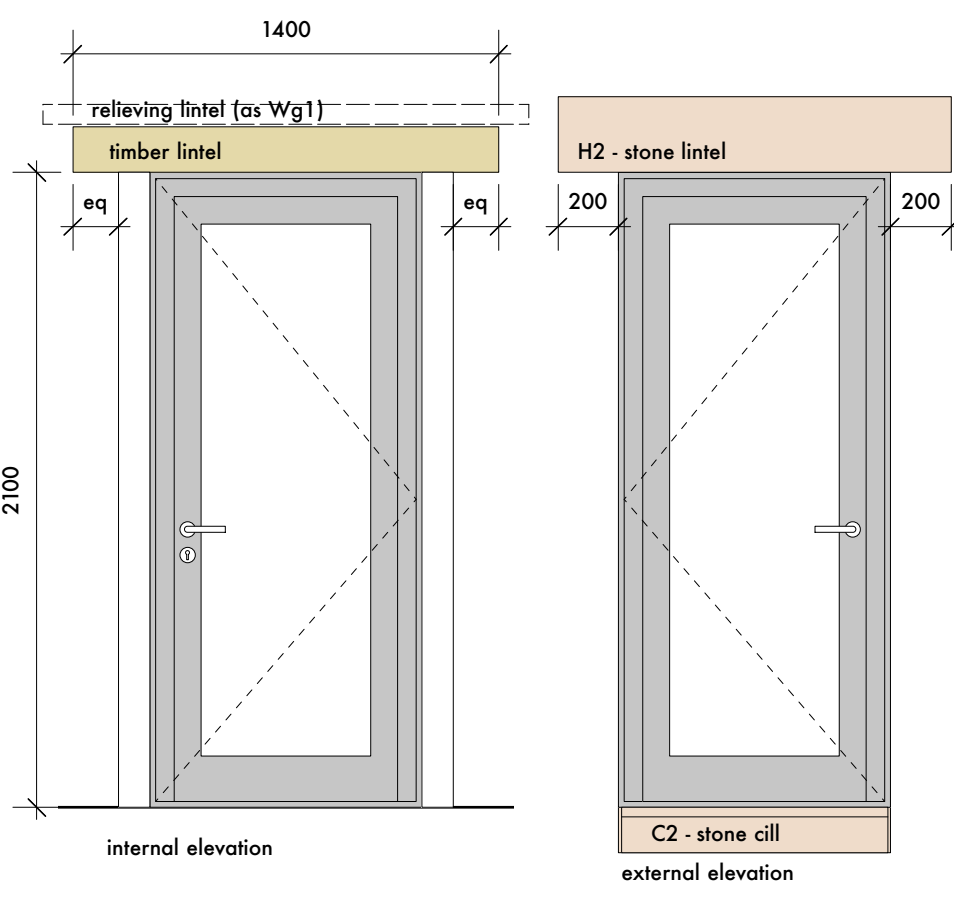
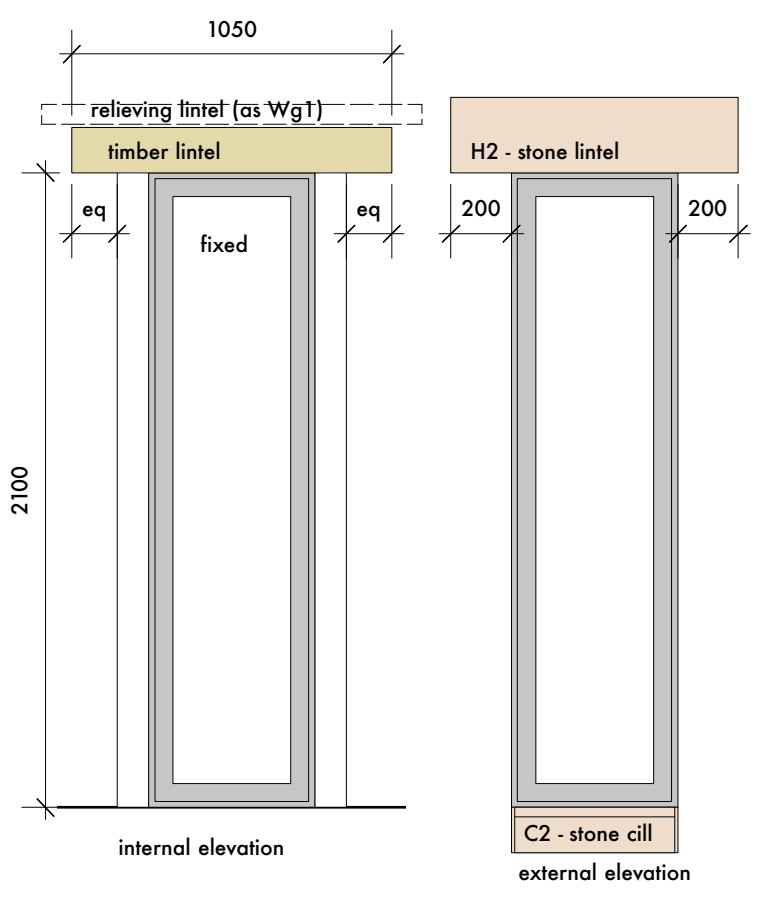

A Issued for discharge of conditions February 2018

stanton andrews architects

44 york street
clitheroe
BB7 2DL
t 01200 444490
e mail@stantonandrews.co.uk
w stantonandrews.co.uk

Eatoughs Farm Ribchester

windows and external doors schedule - sheet 1 of 2

drg.no. 17.16 / 3 rev. A
na dec.17 scale. 1 to 25 @ A1
drawn. date. scale.