

to be read in conjunction with drg.no.1716/40, 42, 43

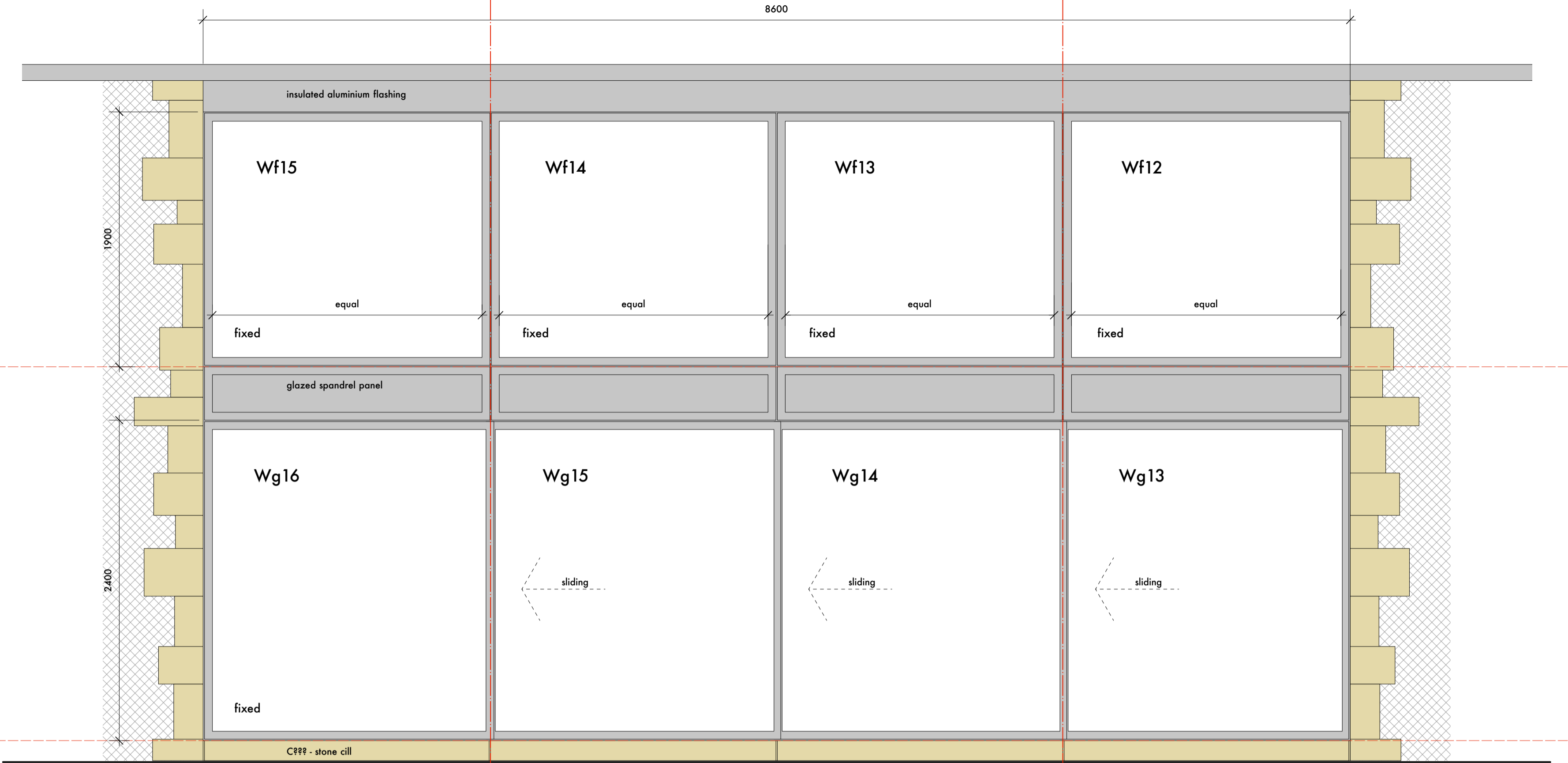

external elevation  
(as drg.no.1716/25)

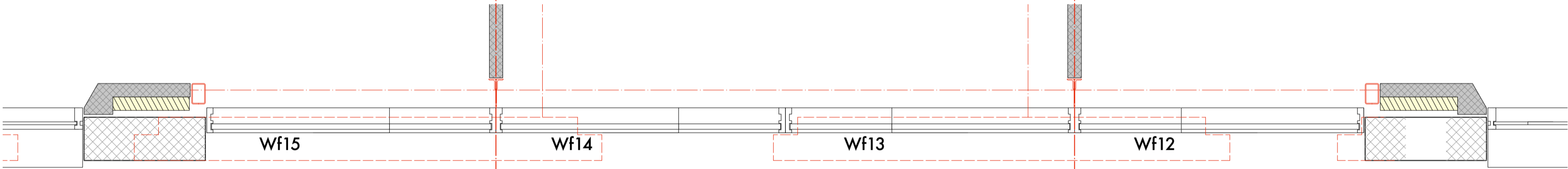

first floor plan extract  
(as drg.no.1716/22)

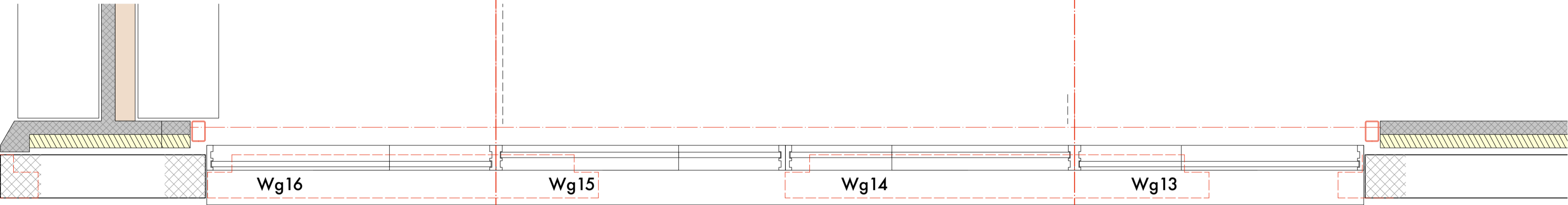

ground floor plan extract  
(as drg.no.1716/21)

illustrated dimensions provided for costing purposes only. all dimensions to be confirmed by dimensions taken on site by contractor.

**WINDOWS AND EXTERNAL DOORS**  
windows and external doors to be 'FWS 60 CV' range, min.0.84W/m2K U value, manufactured by and installed in accordance with the recommendations of :-  
Schueco UK ltd  
tel.no.01908 282111

to be polyester powder coated aluminium with triple glazed units, draught strips to all opening lights. windows and lockable latch doors to be fitted with multipoint locking mechanism.

integral 'julliette' balcony screen to Wf11, Wf16 and Wf19

**GLAZING**  
triple glazed units to be argon gas filled factory sealed units comprising 8-12-6-12-6.  
laminated glass outer pane  
Pilkington 'K' low emissivity toughened safety glass inner pane.  
safety glass to BS6206 class B or C to be fitted in any doors and side screens with glazed areas less than 1500mm above floor level, and in walls with glazing below 800mm above floor level.  
obscure glass to be 'stipolyte'.

**FRAMES**  
frames to be fitted with trickle vents to provide background ventilation, mounted min.1.7m above f.f.l.  
trickle vents to habitable rooms to have min.5000mm2 openable area, and 2500mm2 openable area to 'wet' rooms.

minimum one opening light to windows to accommodation rooms at first floor to be capable of being used as "escape window" as defined by clause 2.8 of approved document B1, ie min.0.33mm2 unobstructed openable area, min.450mm wide and min.450mm high, sill to be max.1100mm above floor.

'as existing' drawings based on information provided by others - no measured survey of the property has been undertaken by the architect.  
this drawing is to be read in conjunction with all relevant consultants and specialists drawings. the architect is to be notified of any discrepancies before proceeding.  
do not scale from this drawing. all dimensions are to be checked on site.  
this drawing is subject to copyright.

A Issued for discharge of conditions February 2018

stanton andrews  
architects

44 york street  
clitheroe  
BB7 2DL  
  
t 01200 444490  
e mail@stantonandrews.co.uk  
w stantonandrews.co.uk

Eatoughs Farm  
Ribchester

windows and external doors  
schedule - sheet 2 of 2

drg.no. 17.16 / 4 rev. A  
na dec.17 1 to 25 @ A1  
drawn. date. scale.

