





- KEY**
- **HB** 125 X 255 PRECAST CONCRETE HALF BATTERED KERB TO BS EN 12463 PART 1: 1994 - 100MM KERB FACE - REFER TO DRAWING C3054
 - **BN** 125 X 150MM PRECAST CONCRETE BULLNOSED KERB TO BS 7263 PART 1: 1994 - LAID FLUSH - REFER TO DRAWING C3054
 - **EK** 50 X 150MM PRECAST CONCRETE EDGING LAID FLUSH TO COMPLY WITH BS 7263 PART 1: 1994 - REFER TO DRAWING C3054
 - **K1** 305 X 150 BULLNOSE KERB 160MM KERB FACE - REFER TO DRAWING C3054
 - **K2** 305 X 150 BULLNOSE KERB 160MM TO 130MM KERB FACE - REFER TO DRAWING C3054
 - **K3** TRANSITION 130MM TO 100MM KERB FACE - REFER TO DRAWING C3054
 -  TACTILE PAVING TO LANCASHIRE COUNTY COUNCIL SPECIFICATION - REFER TO DRAWING C3054
 -  FLEXIBLE FOOTWAY CONSTRUCTION TO LANCASHIRE COUNTY COUNCIL SPECIFICATION - REFER TO DRAWING C3054
 -  FLEXIBLE CARRIAGEWAY CONSTRUCTION TO LANCASHIRE COUNTY COUNCIL SPECIFICATION - REFER TO DRAWING C3054
 -  AREA OF EXISTING CARRIAGEWAY TO BE REDUCED AND MADE UP TO FLEXIBLE FOOTWAY CONSTRUCTION
 -  EXISTING ACCESS JUNCTIONS TO BE REMOVED AND MADE UP TO FLEXIBLE FOOTWAY CONSTRUCTION
- NOTES:**
- 1 TRANSITION KERBS TO BE REQUIRED BETWEEN KERBS OF DIFFERENT HEIGHTS

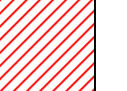
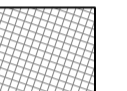
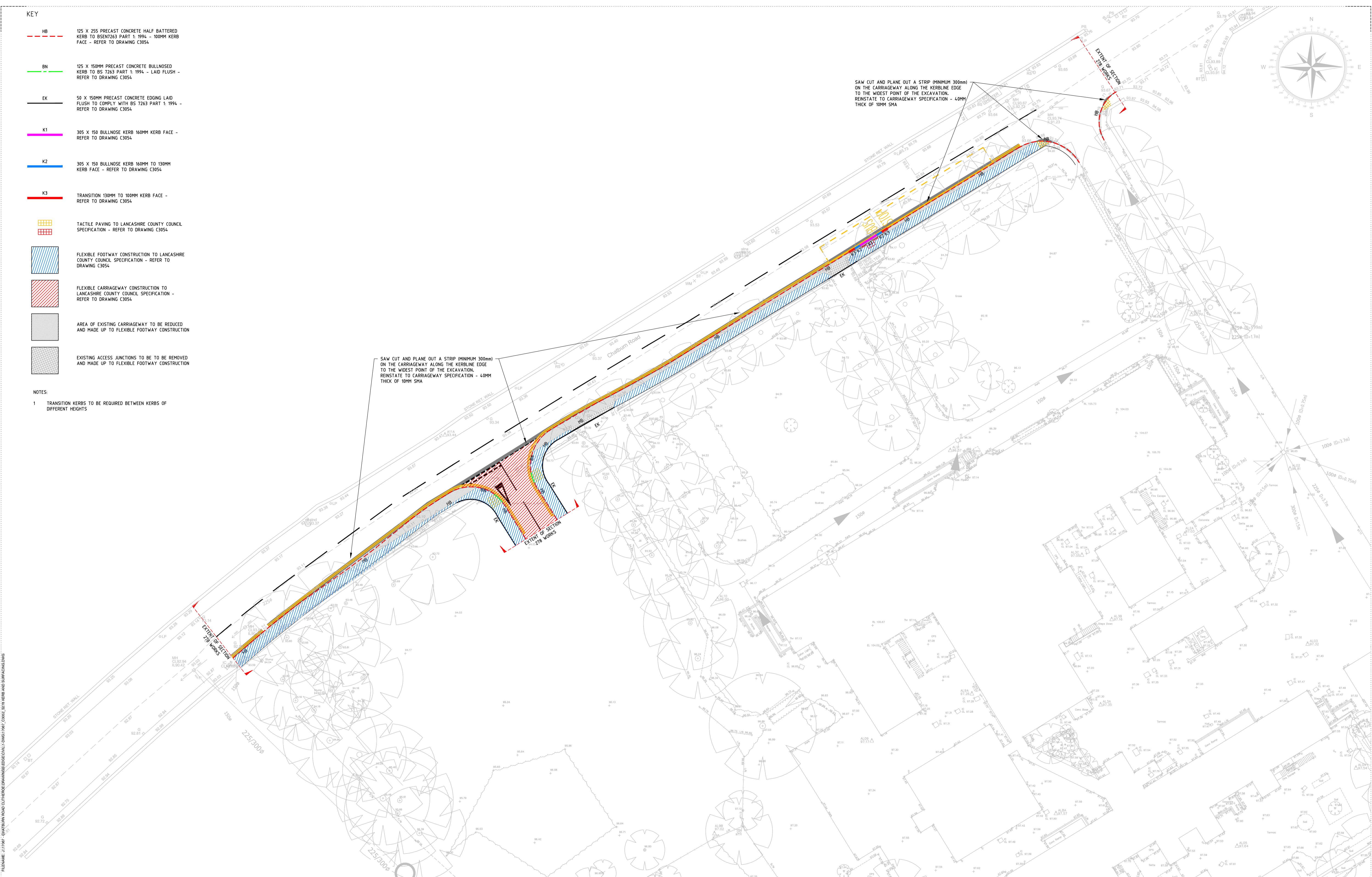

<p>EDGE CONSULTING ENGINEERS www.edgece.com</p> <p>Manchester, UK 3rd Floor, Conovan Court, 12 Blackfriars Street, Manchester, M3 5BQ, United Kingdom</p> <p>T: +44 (0) 161 834 1938 E: manchester@edgece.com</p>	<p>Project Name CHATBURN ROAD CLITHEROE</p> <p>Client McDERMOTT HOMES</p> <p>Discipline CIVIL</p> <p>Scale @ A1 1:250</p>	<p>Section Title SECTION 278 KERB AND SURFACING</p> <p>Status APPROVAL</p> <p>Project No. 17067</p> <p>Drawing No. C3052</p> <p>Revision P04</p>																									
<table border="1" style="width: 100%; border-collapse: collapse;"> <thead> <tr> <th>Rev</th> <th>Date</th> <th>Description</th> <th>By</th> <th>Chk</th> </tr> </thead> <tbody> <tr> <td>P04</td> <td>14.12.17</td> <td>Kerb line in existing access junction updated</td> <td>MA</td> <td>RA</td> </tr> <tr> <td>P03</td> <td>11.12.17</td> <td>Updated to S278 comments</td> <td>MA</td> <td>RA</td> </tr> <tr> <td>P02</td> <td>05.12.17</td> <td>Updated to new build out junction</td> <td>MA</td> <td>RA</td> </tr> <tr> <td>P01</td> <td>03.11.17</td> <td>Issued for Approval</td> <td>MA</td> <td>RA</td> </tr> </tbody> </table> <p>The concepts + information contained in this document are the copyright of EDGE Consulting Engineers. Use or copying of this document in whole or in part without the written permission of EDGE Consulting Engineers constitutes an infringement of copyright.</p> <p>DO NOT SCALE DRAWINGS, IF IN DOUBT, ASK!</p>	Rev	Date	Description	By	Chk	P04	14.12.17	Kerb line in existing access junction updated	MA	RA	P03	11.12.17	Updated to S278 comments	MA	RA	P02	05.12.17	Updated to new build out junction	MA	RA	P01	03.11.17	Issued for Approval	MA	RA		
Rev	Date	Description	By	Chk																							
P04	14.12.17	Kerb line in existing access junction updated	MA	RA																							
P03	11.12.17	Updated to S278 comments	MA	RA																							
P02	05.12.17	Updated to new build out junction	MA	RA																							
P01	03.11.17	Issued for Approval	MA	RA																							

FILENAME: C:\17067\17067_143.RVT