

rec'd 5/4/18

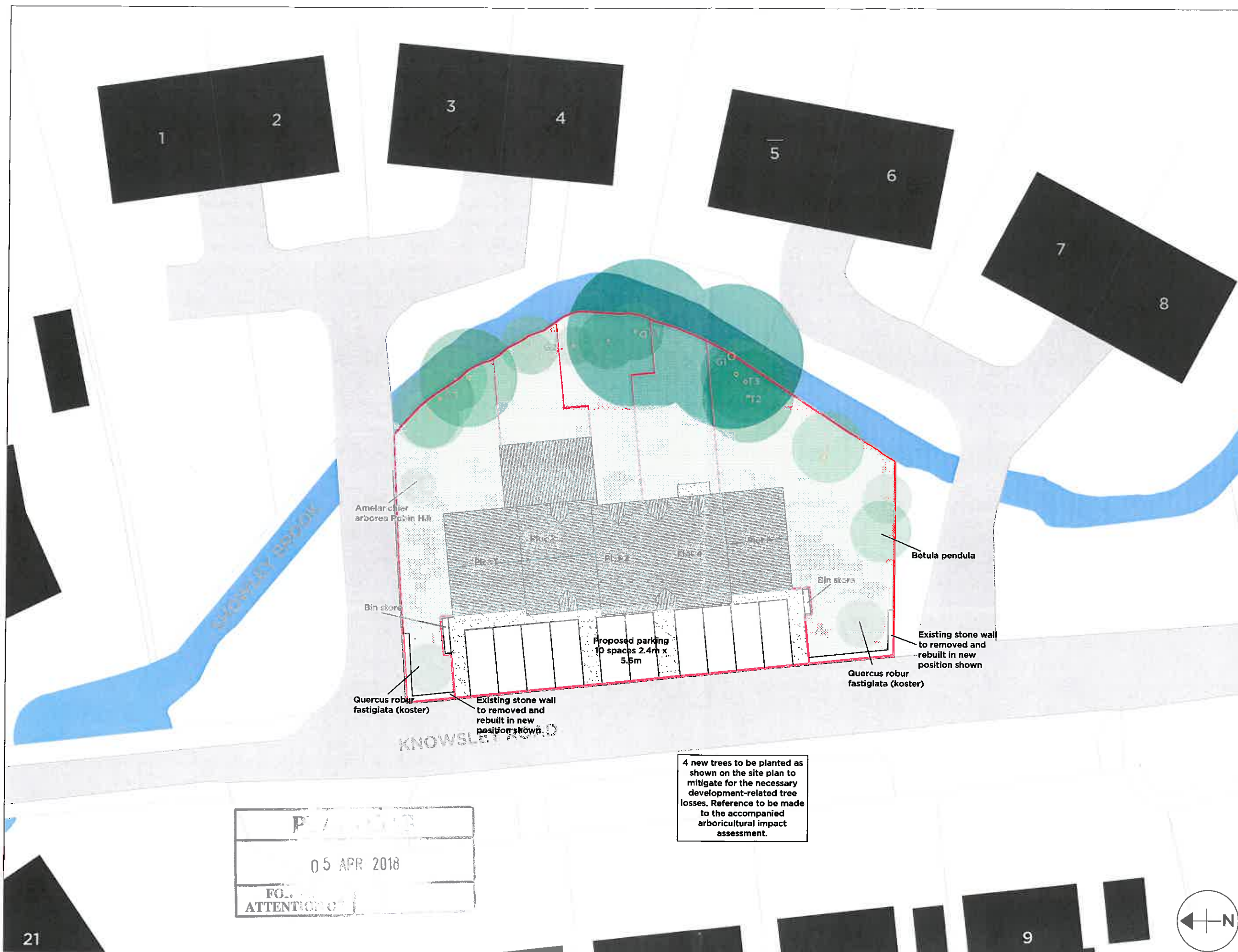

4 new trees to be planted as shown on the site plan to mitigate for the necessary development-related tree losses. Reference to be made to the accompanied arboricultural impact assessment.

05 APR 2018
FO...
ATTENTION...

Notes: THE PROPOSAL IS TO CONVERT THE EXISTING BUILDING INTO THREE SEPARATE DWELLINGS AND EXTEND THE PROPERTY THE NORTH AND SOUTH TO CREATE TWO ADDITIONAL DWELLINGS. TWO PARKING BAYS PER DWELLING TO BE PROVIDED, ALL AT 2.4m x 5.5m. NEW MITIGATION PLANTING SCHEME FOLLOWING THE REMOVAL OF FOUR MODERATE/LOW VALUE TREES AS SHOWN ON THE ARBORICULTURAL IMPACT ASSESSMENT BOTH EXTENSIONS TO BE WHITE RENDERED FINISH AND SLATE ROOF TO MATCH EXISTING, AS WELL AS FULL STONE SURROUNDS TO EACH DOOR AND WINDOW. PLEASE REFER TO THE DESIGN & ACCESS STATEMENT, ARBORICULTURAL IMPACT ASSESSMENT, BAT SURVEY AND ALL OF THE ACCOMPANIED APPENDICES.		
Rev	Date	Revision
Peter Hitchen Architects		
project: PROPOSED CONVERSION AND EXTENSIONS TO THE FORMER CARE HOME, 10 KNOWSLEY ROAD, WILPSHIRE, BLACKBURN, BB1 9PX		
client: MR & MRS COUPLAND		
drawing title: PROPOSED SITE PLAN		
scale: 1:200 @ A2		
drawn: DS	checked: PH	
date: 22/03/18		
project no: PHA/123	fig. no: 200	rev: -