

SOFT LANDSCAPE PROPOSALS
SHEET 4

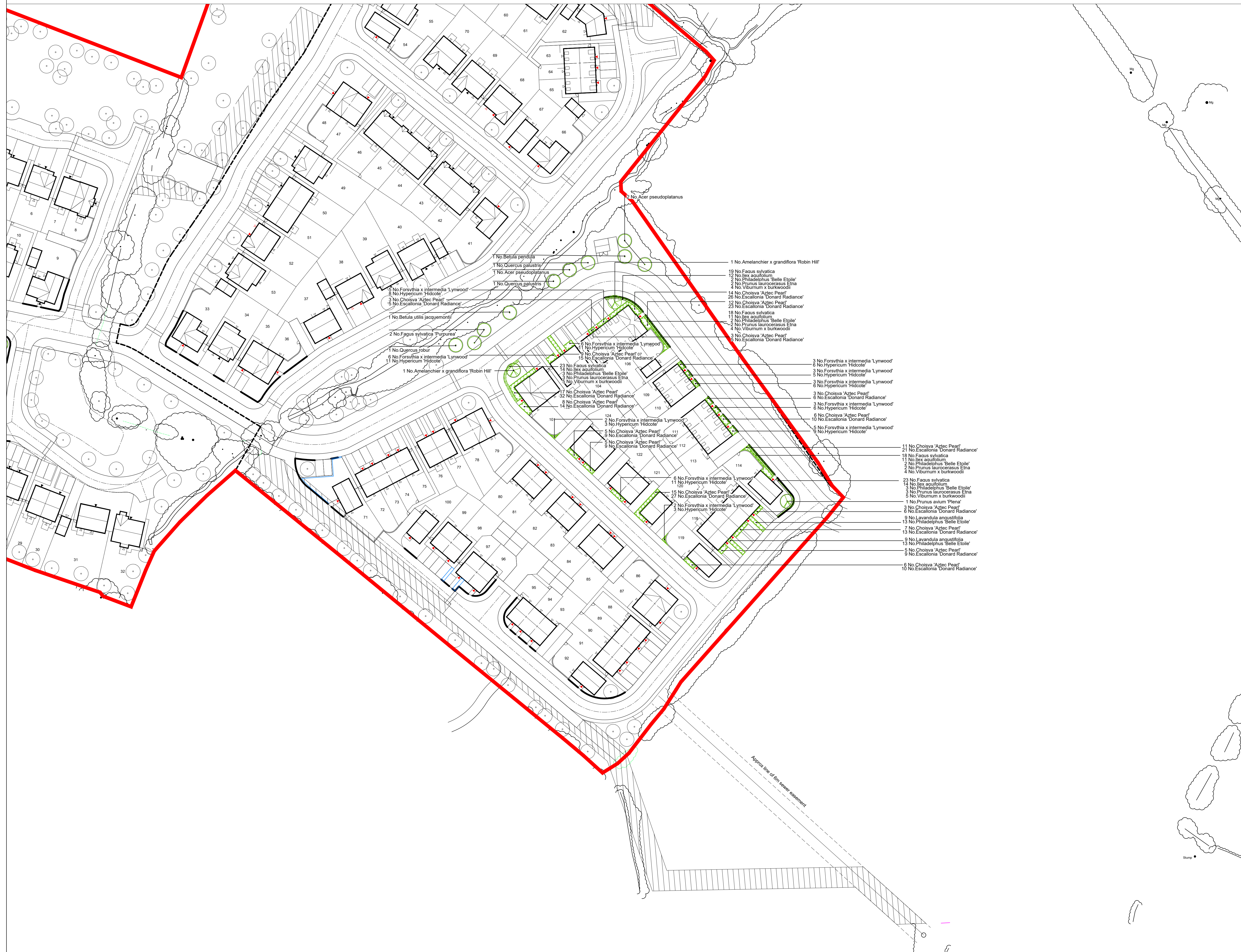

Key:

- Site Boundary
- Existing Vegetation to be retained
- Garden Tree Planting
- Street Tree Planting
- Parkland Tree Planting
- Ornamental Shrub Planting
- Hedgerow
- Bulb Planting

- 1 No. *Betula pendula*
- 1 No. *Quercus galustris*
- 1 No. *Acer pseudoplatanus*
- 1 No. *Quercus palustris*
- 5 No. *Forsythia x intermedia* 'Lynwood'
- 6 No. *Hypericum 'Hidcote'*
- 3 No. *Choisya 'Aztec Pearl'*
- 5 No. *Escallonia 'Donard Radiance'*
- 1 No. *Betula utilis jacquemontii*
- 2 No. *Fagus sylvatica* 'Purpurea'
- 1 No. *Quercus robur*
- 6 No. *Forsythia x intermedia* 'Lynwood'
- 11 No. *Hypericum 'Hidcote'*
- 1 No. *Amelanchier x grandiflora* 'Robin Hill'
- 19 No. *Fagus sylvatica*
- 12 No. *Ilex aquifolium*
- 2 No. *Philadelphus 'Belle Etoile'*
- 2 No. *Prunus laurocerasus* 'Etna'
- 4 No. *Viburnum x burkwoodii*
- 14 No. *Choisya 'Aztec Pearl'*
- 26 No. *Escallonia 'Donard Radiance'*
- 12 No. *Choisya 'Aztec Pearl'*
- 23 No. *Escallonia 'Donard Radiance'*
- 18 No. *Fagus sylvatica*
- 11 No. *Ilex aquifolium*
- 2 No. *Philadelphus 'Belle Etoile'*
- 2 No. *Prunus laurocerasus* 'Etna'
- 4 No. *Viburnum x burkwoodii*
- 3 No. *Choisya 'Aztec Pearl'*
- 3 No. *Escallonia 'Donard Radiance'*
- 3 No. *Forsythia x intermedia* 'Lynwood'
- 6 No. *Hypericum 'Hidcote'*
- 3 No. *Forsythia x intermedia* 'Lynwood'
- 3 No. *Forsythia x intermedia* 'Lynwood'
- 6 No. *Hypericum 'Hidcote'*
- 3 No. *Choisya 'Aztec Pearl'*
- 3 No. *Escallonia 'Donard Radiance'*
- 3 No. *Forsythia x intermedia* 'Lynwood'
- 6 No. *Hypericum 'Hidcote'*
- 6 No. *Choisya 'Aztec Pearl'*
- 10 No. *Escallonia 'Donard Radiance'*
- 5 No. *Forsythia x intermedia* 'Lynwood'
- 9 No. *Hypericum 'Hidcote'*
- 11 No. *Choisya 'Aztec Pearl'*
- 21 No. *Escallonia 'Donard Radiance'*
- 18 No. *Fagus sylvatica*
- 11 No. *Ilex aquifolium*
- 2 No. *Philadelphus 'Belle Etoile'*
- 2 No. *Prunus laurocerasus* 'Etna'
- 4 No. *Viburnum x burkwoodii*
- 23 No. *Fagus sylvatica*
- 14 No. *Ilex aquifolium*
- 3 No. *Philadelphus 'Belle Etoile'*
- 3 No. *Prunus laurocerasus* 'Etna'
- 3 No. *Viburnum x burkwoodii*
- 1 No. *Prunus avium* 'Plena'
- 3 No. *Choisya 'Aztec Pearl'*
- 8 No. *Escallonia 'Donard Radiance'*
- 8 No. *Lavandula angustifolia*
- 13 No. *Philadelphus 'Belle Etoile'*
- 17 No. *Choisya 'Aztec Pearl'*
- 13 No. *Escallonia 'Donard Radiance'*
- 8 No. *Lavandula angustifolia*
- 13 No. *Philadelphus 'Belle Etoile'*
- 5 No. *Choisya 'Aztec Pearl'*
- 9 No. *Escallonia 'Donard Radiance'*
- 6 No. *Choisya 'Aztec Pearl'*
- 10 No. *Escallonia 'Donard Radiance'*

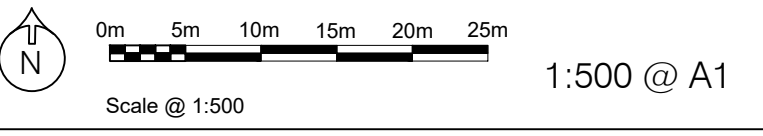

Revision
 A - 17.08.16 AW Revised Layout
 B - 20.06.18 JG Revised Layout

This document should not be relied on or used in circumstances other than those for which it was prepared and for which Tyler Grange was appointed. Tyler Grange accepts no responsibility for this document to any other party other than the person by whom it was appointed.

Copyright © Tyler Grange LLP 2016

TG Tyler Grange

Ladyfield House, Station Road, Wilmslow, Cheshire SK9 1BB
 t: 01625 618 547
 www.tylergrange.co.uk

Drawing Title Soft Landscape Proposals:
 Sheet 4

Project Land at Higgins Brook, East of Chipping Lane, Longridge

Drawing No 11319/P69b

Date August 2016