

Proposed Ground Floor Plan
scale 1:100

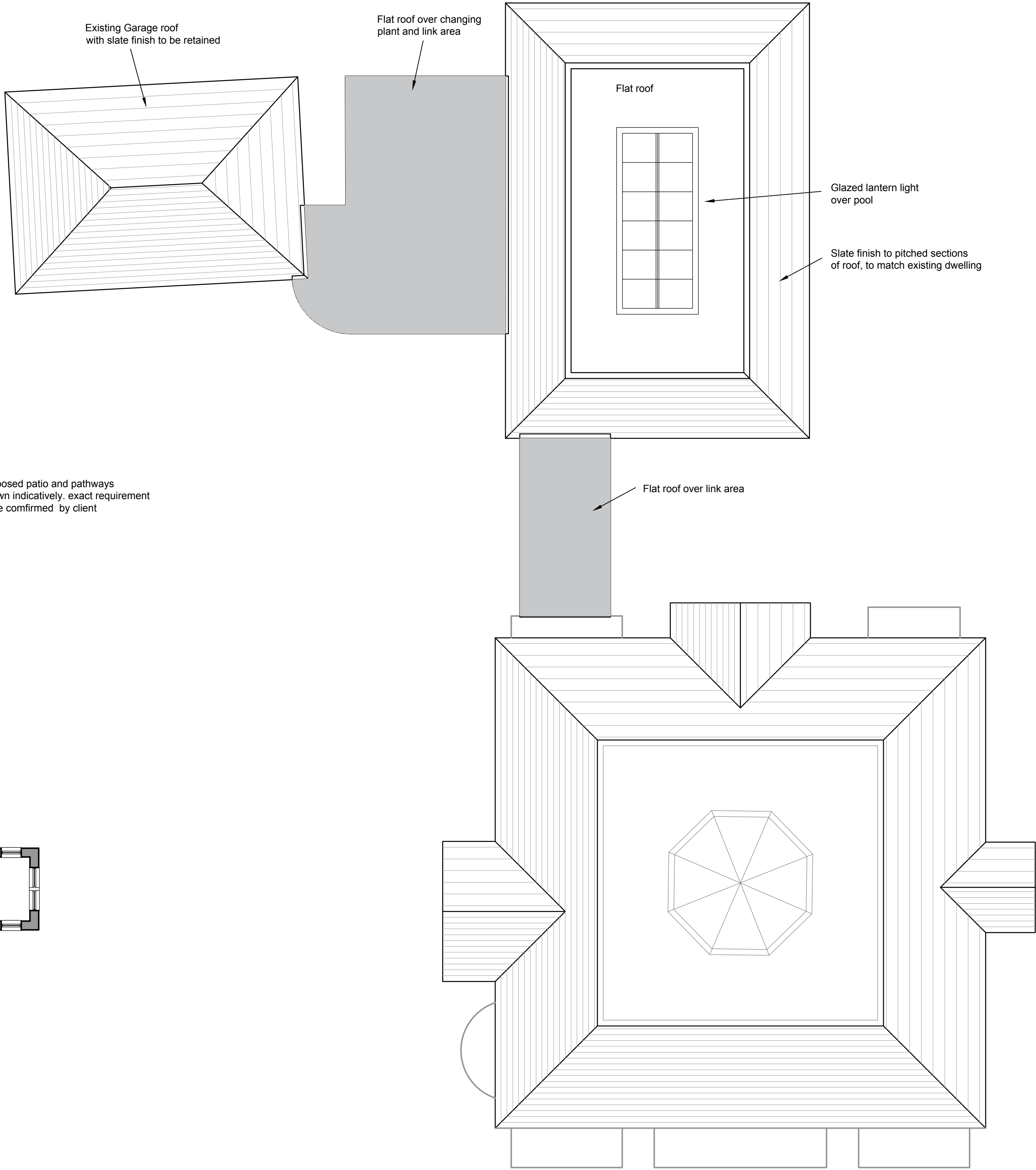

Proposed Roof Plan
scale 1:100

NOTES:
Copyright in all documents prepared by the architect and any works executed from these documents and drawings, shall unless otherwise agreed, remain the property of the architect and must not be reproduced by, lent or disclosed to, a third party without the written consent of Good and Tillotson.

DO NOT SCALE OFF THIS DRAWING.
All dimensions to be checked on site and any discrepancies to be referred to the architect before proceeding.

ALL LEVELS TO BE CHECKED ON SITE.
All discrepancies between information shown on the drawings and the information in the specification to be referred to the architect before proceeding.

All component sizes and references to be checked prior to the ordering of materials.

Positions and designation (i.e. combined, surface water or foul) of existing drain runs on site are to be checked / confirmed by the building contractor prior to commencement of any drainage works. Any existing drains, to which additional connections are to be made, are also to be checked as necessary to ensure they are suitable to accommodate additional capacity and the type of effluent being connected.

All relevant boundary positions are to be checked prior to proceeding.

NOTES:
EXISTING PROPERTY NOT SURVEYED
BY GOOD & TILLOTSON
EXISTING DRAWINGS PREPARED FROM
EXISTING PAPER DRAWINGS PROVIDED
BY CLIENT

A	Updates for planning application	gd	20.04.18
Rev	Revision	Int.	Date

Project:

Proposed Swimming Pool Extension

Location:

Torver House
Osbaldeston Lane
Blackburn
BB2 7LT

Employer:

Mr J Patel

Client:

Mr J Patel

Good & Tillotson Chartered Architects

2 The Studios,
318 Chorley Old Road,
Bolton,
BL1 4JU

Tel: 01204 497700

Email: info@goodandtillotson.co.uk
Web: www.goodandtillotson.co.uk



Drawing Title:

Proposed Ground Floor Plan and Roof Plan

G&T Job No:	Scale:	Drawn:	Checked:	Date:
1731	1:100	gd	RPW	05-10-17

Drawing Purpose: Status: Revision:

Planning A1 A

BIM Project: Origin: Zone: Level: Type: Role: Dwg No:

1731-G&T-Z0-00-DR-A-1003