

TYPICAL EXTERNAL VIEW  
 PROPOSED TYPICAL SASH WINDOW DETAIL-  
 ELEVATION

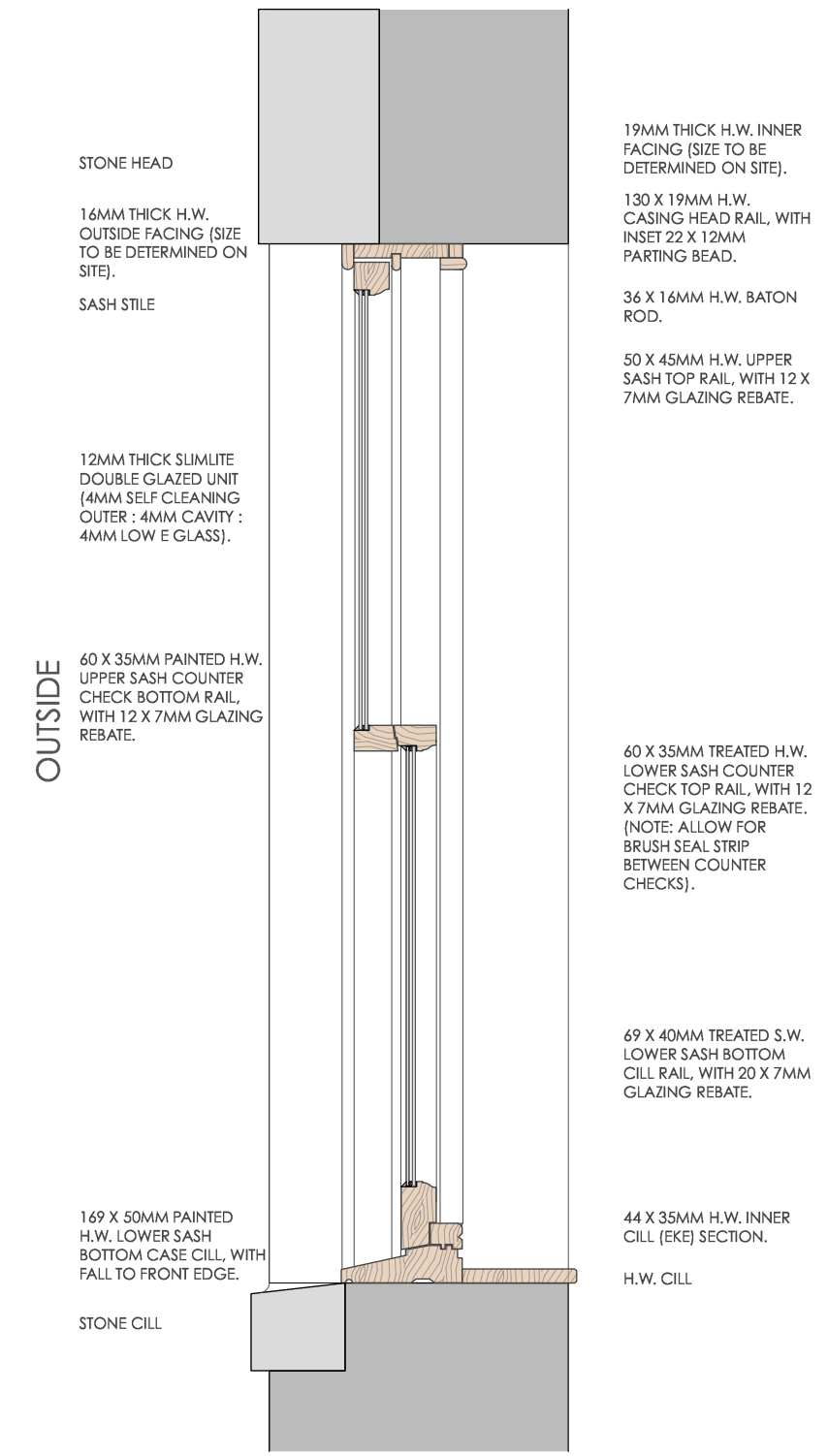

SECTION A - HEAD AND CILL DETAIL

- OUTSIDE**
- STONE HEAD
  - 16MM THICK H.W. OUTSIDE FACING (SIZE TO BE DETERMINED ON SITE).
  - SASH STILE
  - 12MM THICK SLIMLITE DOUBLE GLAZED UNIT (4MM SELF CLEANING OUTER : 4MM CAVITY : 4MM LOW E GLASS).
  - 60 X 35MM PAINTED H.W. UPPER SASH COUNTER CHECK BOTTOM RAIL, WITH 12 X 7MM GLAZING REBATE.
  - 60 X 35MM TREATED H.W. LOWER SASH COUNTER CHECK TOP RAIL, WITH 12 X 7MM GLAZING REBATE. (NOTE: ALLOW FOR BRUSH SEAL STRIP BETWEEN COUNTER CHECKS).
  - 69 X 40MM TREATED S.W. LOWER SASH BOTTOM CILL RAIL, WITH 20 X 7MM GLAZING REBATE.
  - 169 X 50MM PAINTED H.W. LOWER SASH BOTTOM CASE CILL, WITH FALL TO FRONT EDGE.
  - STONE CILL
- INSIDE**
- 19MM THICK H.W. INNER FACING (SIZE TO BE DETERMINED ON SITE).
  - 130 X 19MM H.W. CASING HEAD RAIL, WITH INSET 22 X 12MM PARTING BEAD.
  - 36 X 16MM H.W. BATON ROD.
  - 50 X 45MM H.W. UPPER SASH TOP RAIL, WITH 12 X 7MM GLAZING REBATE.
  - 'SEALMASTER' DRAUGHT STRIP REF: ARK/RCY TO PERIMETER OF OPENING WINDOWS, LET INTO CHASE IN FRAME AND TO MEETING STILES.
  - DOUBLE GLAZED UNIT TO BE 12MM THICK SLIMLITE UNITS, OR SIMILAR, FIXED IN ACCORDANCE WITH MANUFACTURER'S INSTRUCTIONS. (4MM SELF CLEANING OUTER : 4MM CAVITY : 4MM LOW E GLASS).
  - FRAME TO BE DELIVERED TO SITE PRIMED, UNDERCOATED, AND WITH MIN. 1 NO. FINISHING COAT.
  - IRONMONGERY TO WINDOWS TO BE AVAILABLE FROM CARLISLE BRASS (OR EQUIVALENT), TO BE LACQUERED BRASS FINISH.
  - IRONMONGERY TO INCLUDE:-  
 2 NO. BRIGHTON PATTERN SASH FASTENERS REF: AQ43.  
 2 NO. 'VENTLOCK' LOCKING WINDOW STOP.  
 2 NO. RING SASH LIFTS REF: AA42R.
  - 44 X 35MM H.W. INNER CILL (EKE) SECTION.
  - H.W. CILL

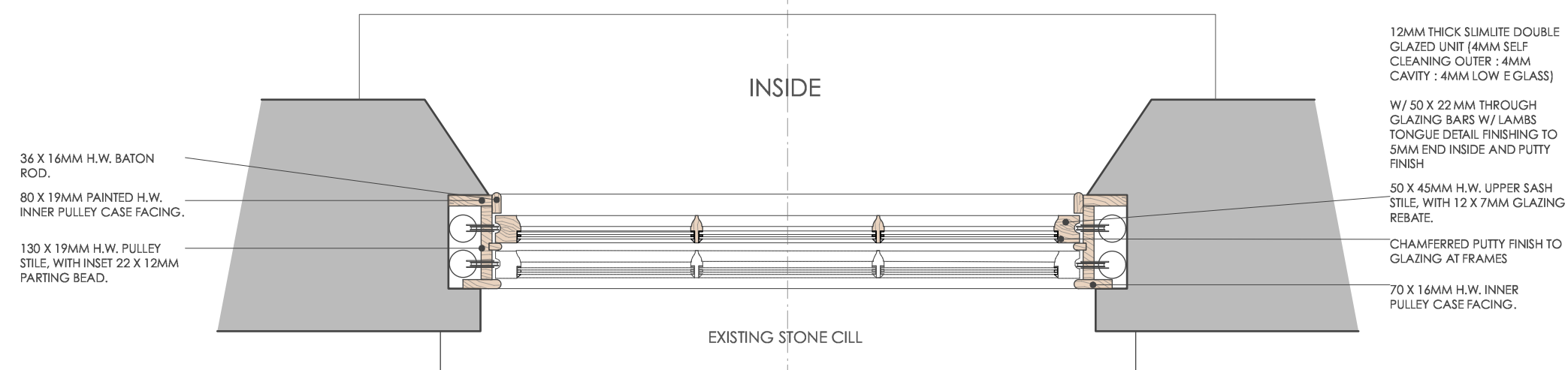

PLAN DETAIL

Rev.	Date	Revision Notes
Project Title		
<b>Windy Street</b>		
<b>Chipping</b>		
Drawing Title		
<b>Proposed Typical</b>		
<b>Window Detail</b>		
Drawing No. Revision		
<b>2501.P02</b>		
Date August.18 Scale 1:10 @ A2		