

This drawing is to be read in conjunction with all relevant Architect, consultants' and specialists' drawings and specifications. The Architect is to be notified of any discrepancies before proceeding. Do not scale from this drawing. All dimensions and levels are to be checked on site. This drawing is subject to copyright. All work carried out before Planning and Building Permission has been granted is at the contractor/clients risk.

55m Continuing Visibility Splay

30m Continuing Visibility Splay

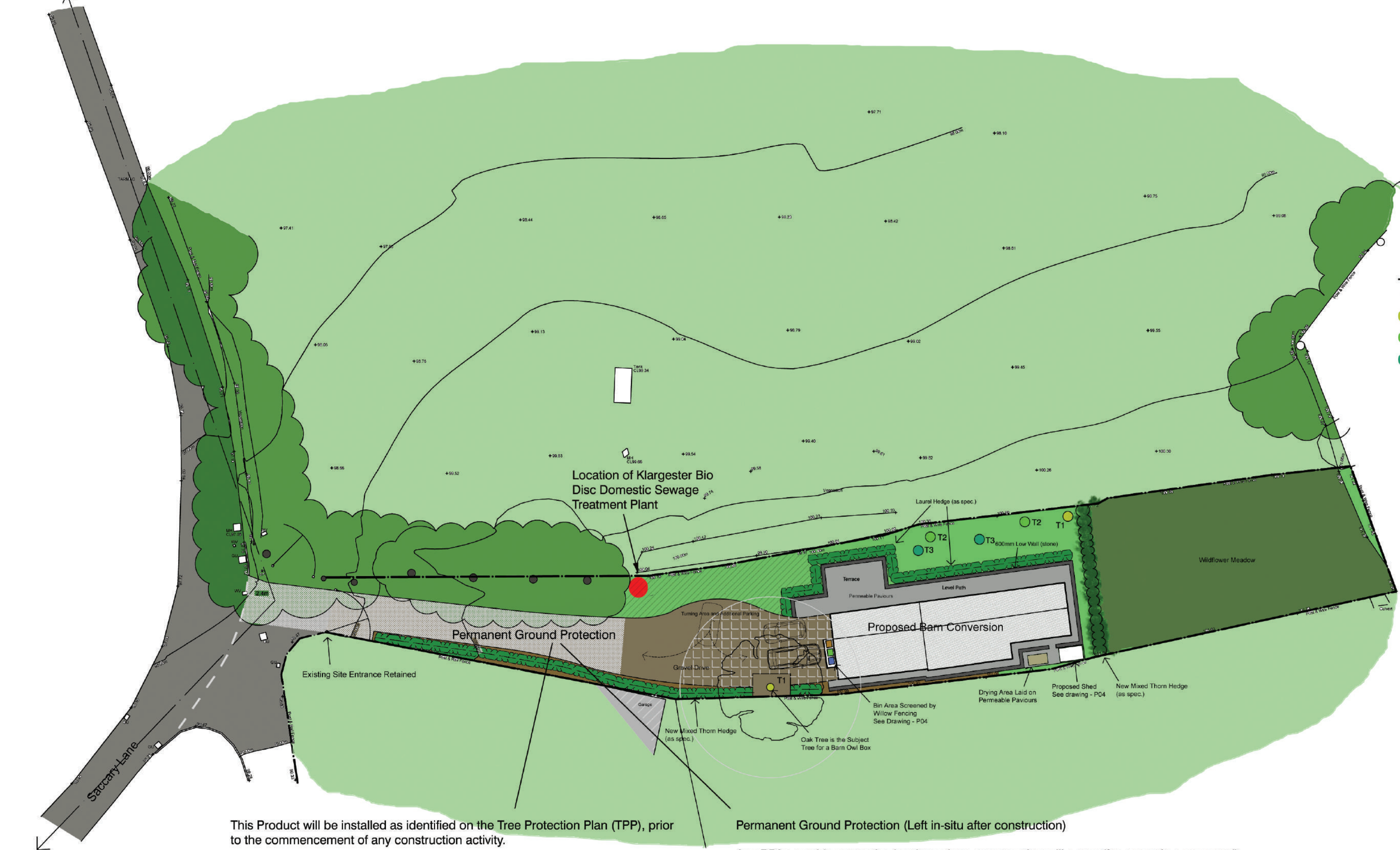

- Area of Woodland whip planted - Oak, Ash and Lime - Surfaced Mulched and area underplanted with Woodland Bulbs - all seasons
- Root Protection Area

Trees:-

- T1 - Oak
- T2 - Mountain Ash
- T3 - Silver

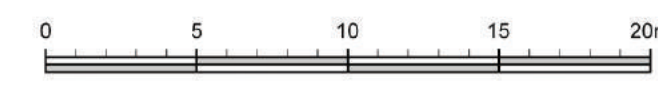

C	JS	Hedges, Trees and Permanent Ground Protection Added	23/08/18
B	JS	Addition of sewage treatment plant	13/07/18
A	JS	Hedges, Trees and Permanent Ground Protection Added	16/05/18
no.	by	revision	date

Client
Mr Z. Collinge

Job Title
Proposed Barn Conversion to Single Dwelling House, Meadow Brook Barn Saccary Lane, Mellor BB1 9DW

Drawing Title PROPOSED SITE LAYOUT PLAN AND LANDSCAPING DETAILS		
Scale 1:250 @ A2	Date Aug 18	Drawn JS

This Product will be installed as identified on the Tree Protection Plan (TPP), prior to the commencement of any construction activity.

- The cellular confinement system will be placed on top of the existing ground levels, (subject to limited clearance of 50mm to remove any spoil) before being filled with 40/20mm angular stone as per the manufactures' specification.
- A geotextile fabric will then be placed in position before a temporary aggregate surface is deployed to act as a wearing course for the construction phase of the project.
- Once all construction activities are complete this temporary wearing course will be removed, to allow for the installation of a permeable final wearing course.
- Edge retention will be custom designed to avoid any significant excavation into existing soil levels either using pre-formed edging or wooden boards secured by metal pins or wooden pegs.

Permanent Ground Protection (Left in-situ after construction)

Any RPAs outside protective barriers where construction will occur (for example a new road) must be covered in ground protection, so that there is no risk of damage from construction activities and movement over the tree roots once the development has finished.

Due to the nature of the site and the intended method of construction, permanent ground protection will need to be established by the use of a three dimensional cellular sub base product or another method designed by an engineer and passed by the local planning authority.

These proposals have been discussed and verbally agreed by the arboricultural officer.

spa
SUNDERLAND PEACOCK ARCHITECTS
SUNDERLAND PEACOCK & ASSOCIATES LTD.
HAZELMERLE, PIMLICO ROAD, CLITHEROE
LANCASHIRE, BB7 2JG
T 01200 423178 F 01200 427328
E info@sunderlandpeacock.com
www.sunderlandpeacock.com

5579 - P01C