

3201808062

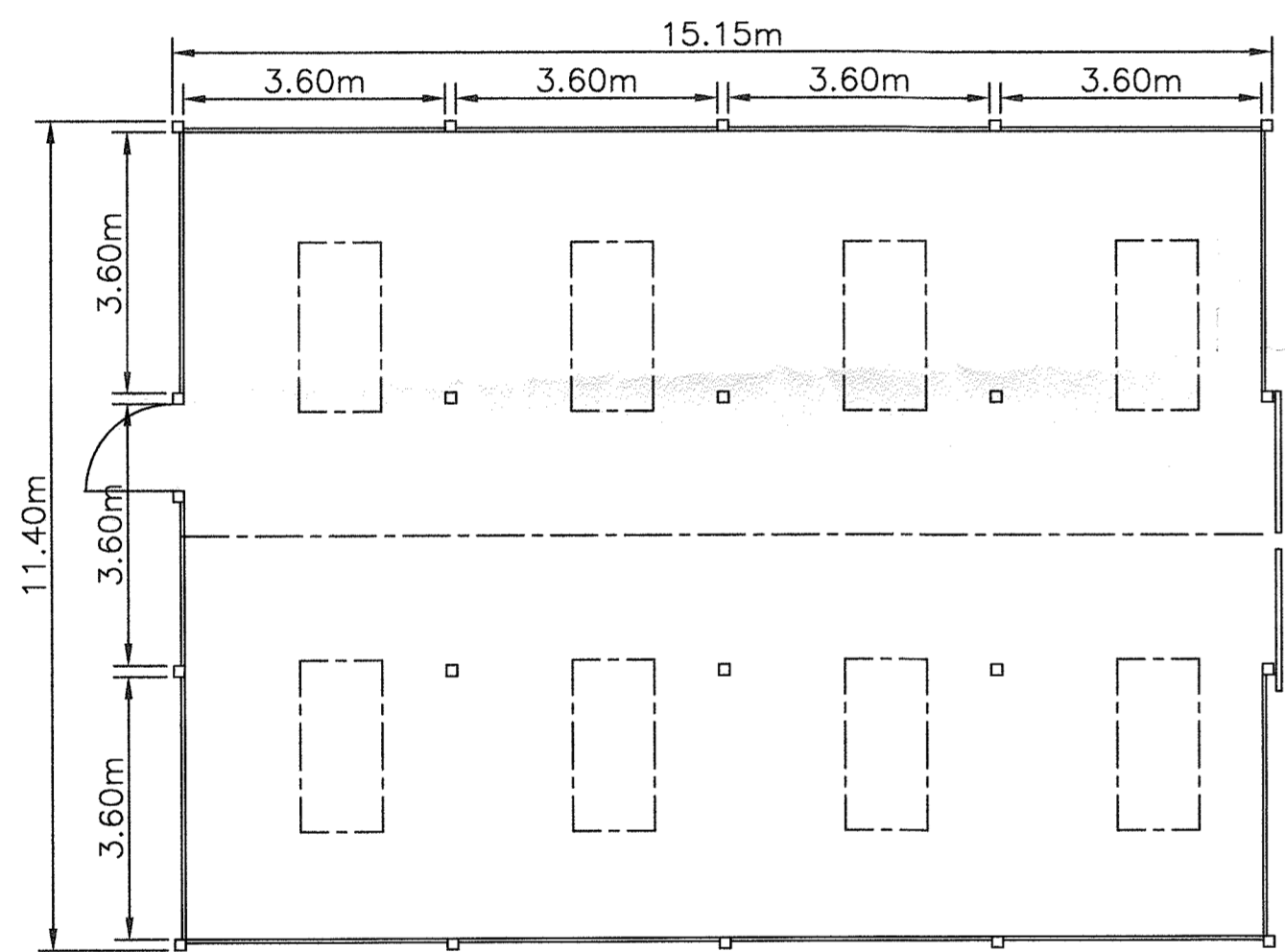

Materials:
 Side and End Claddings,
 Vertical Over-lapped Treated Timber
 Boarding Above 1.40m High Horizontal
 Treated Timber T&G Stock Walling.
Roof:
 P6R Eternit Fibre Cement Sheeting
 Colour Farmscape 'Antracite'.
 1No. GRP. Rooflight Per Bay Slope.
Doors:
 Vertical Boarded PT&G Treated Timber
 Sliding Doors.
 1No. Personnel Door 1200 Wide

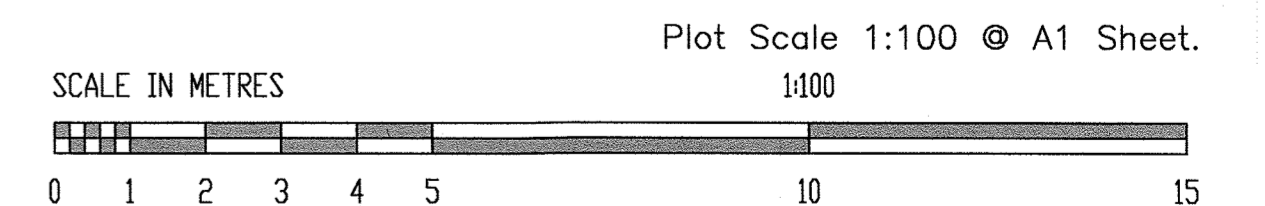
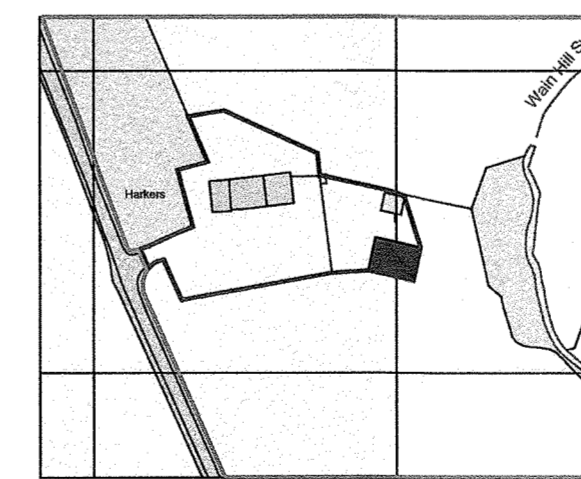
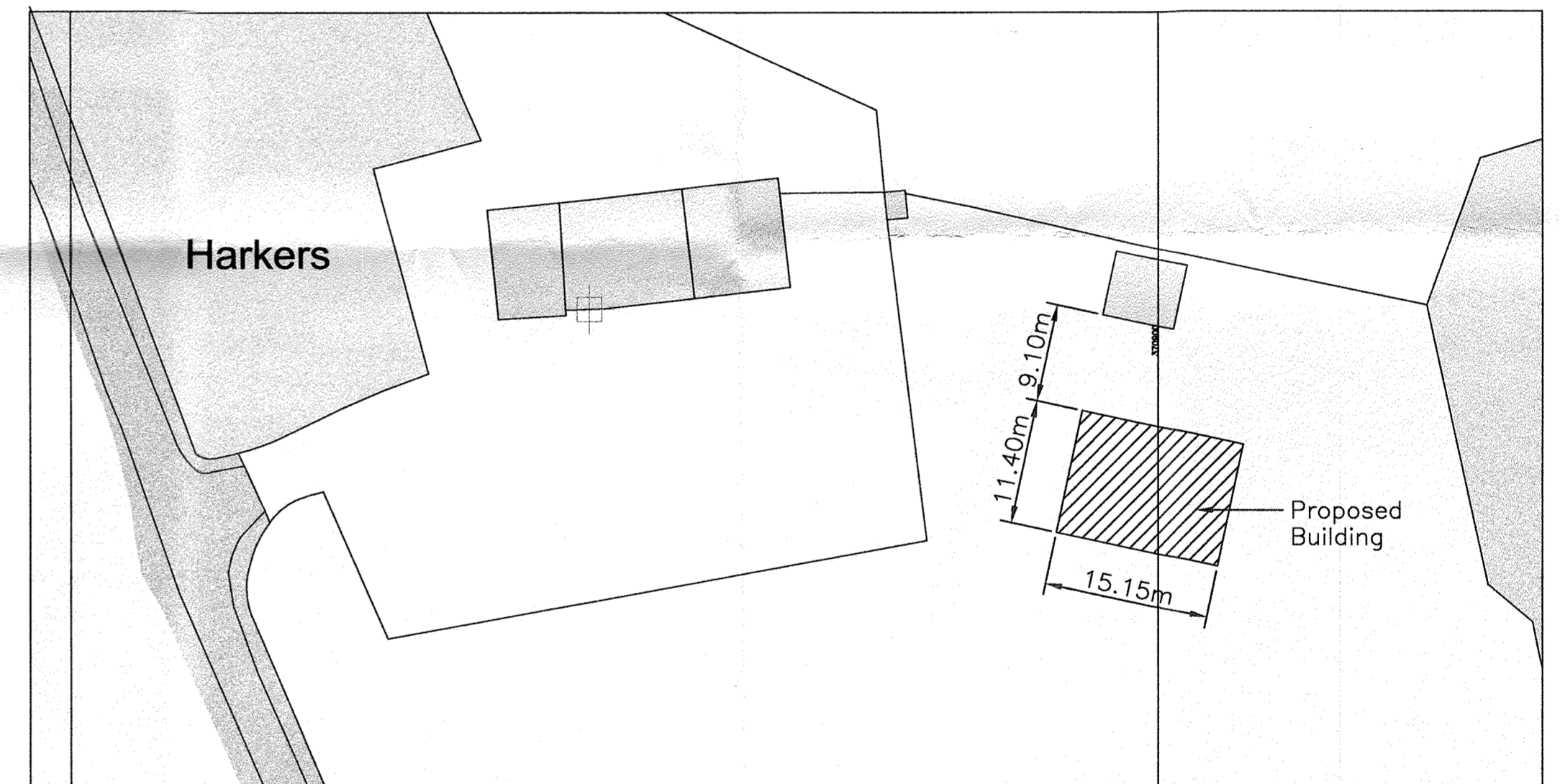

FARMPLUS
 SHAY LANE
 LONGRIDGE
 PRESTON
 LANCS. PR3 3BT
 TEL. 01772 785252

TITLE
**Proposed Elevations And Layout
 For A Timber Framed American Barn**

DO NOT SCALE IF IN DOUBT ASK

File Name 36ftAmericanBarnLowtherPlanning	Issue
Plans prepared for: Harkers Farm Catlow Road. Slaidburn. Clitheroe Lancs. BB7 3AQ	Scale 1:100 & as shown
	Date
	Sept. 2018
	Reference