

NOTES
 This drawing is copyright and must not be reproduced without the written permission of the designer.
 Contractors are to check all sizes and dimensions before setting out any site or shop work. Any errors or discrepancies to be reported to the designer.
 CDM 2015 Designers Risk Assessment
 All works to be carried out under CDM regulations.
 Contractor to ensure all relevant codes of practice and regulations for the proposed works are adhered to. No residual risk within the attached design unless specifically stated with the attached schedule.
 Do not scale off this drawing.
 REVISIONS DATE

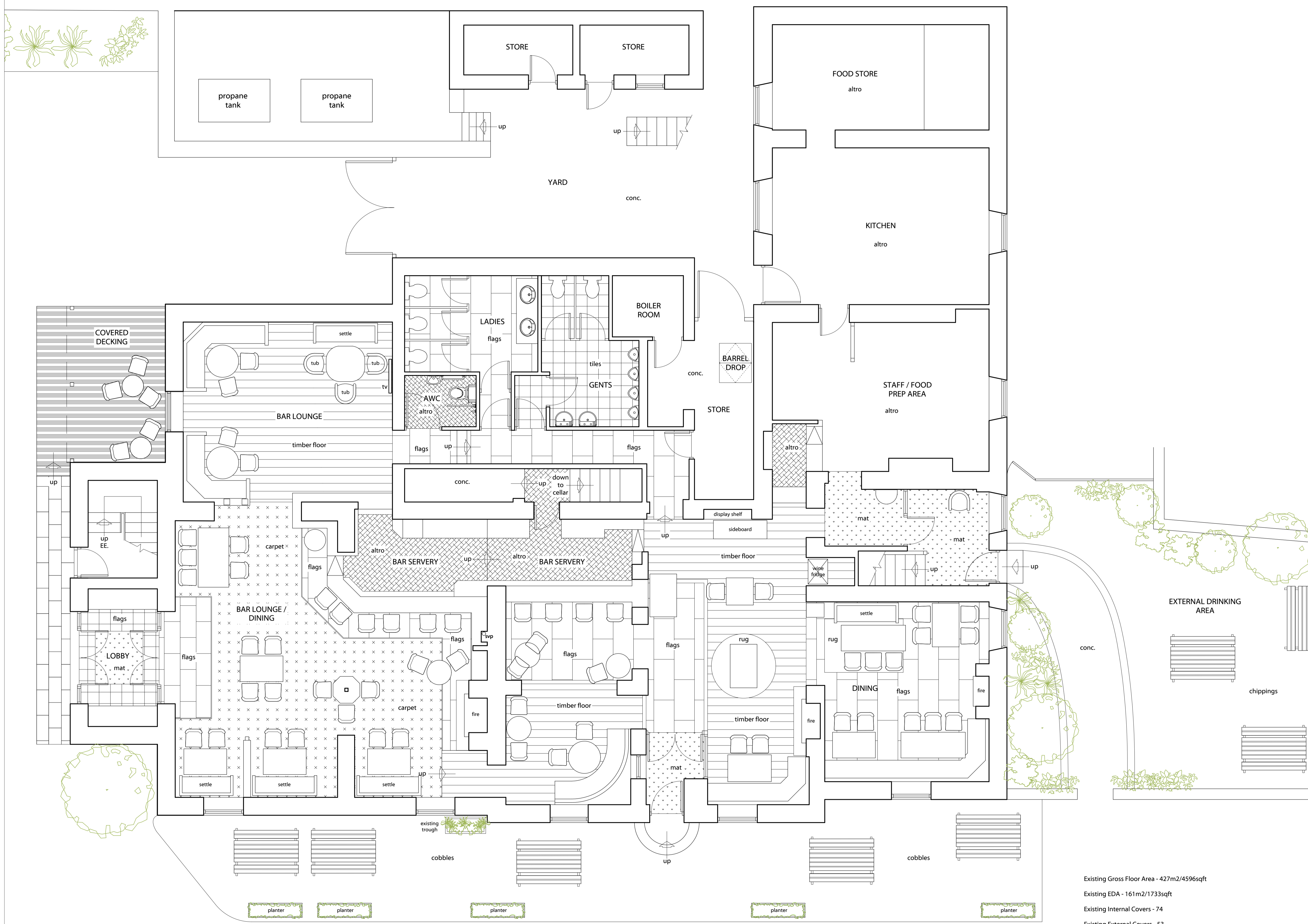

Rev A: single SVP within boxing indicated after exposing on site Nov 2018

TITLE: Existing Ground Floor Plan

PROJECT: Bayley Arms, Avenue Road, Hurst Green, BB7 9QB

CLIENT: Star Pubs & Bars

DRAWN BY: SCALE: 1:50 @ A1
1:100 @ A3

DATE: June 2018 DWG NO: 1312.01 REV: A

Existing Gross Floor Area - 427m2/4596sqft
 Existing EDA - 161m2/1733sqft
 Existing Internal Covers - 74
 Existing External Covers - 53

imd
 AND ASSOCIATES LTD
 1 Sentinel Court, Wilkinson Way
 Blackburn, Lancashire BB1 2EH
 t: 01254 696989 e: info@imdandassociates.co.uk