

This drawing is to be read in conjunction with all relevant Architect, consultants' and specialists' drawings and specifications. The Architect is to be notified of any discrepancies before proceeding. Do not scale from this drawing. All dimensions and levels are to be checked on site. This drawing is subject to copyright. All work carried out before Planning and Building Permission has been granted is at the contractor/clients risk.

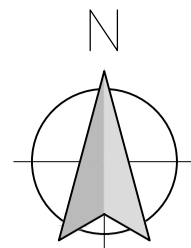

1:500 Scale

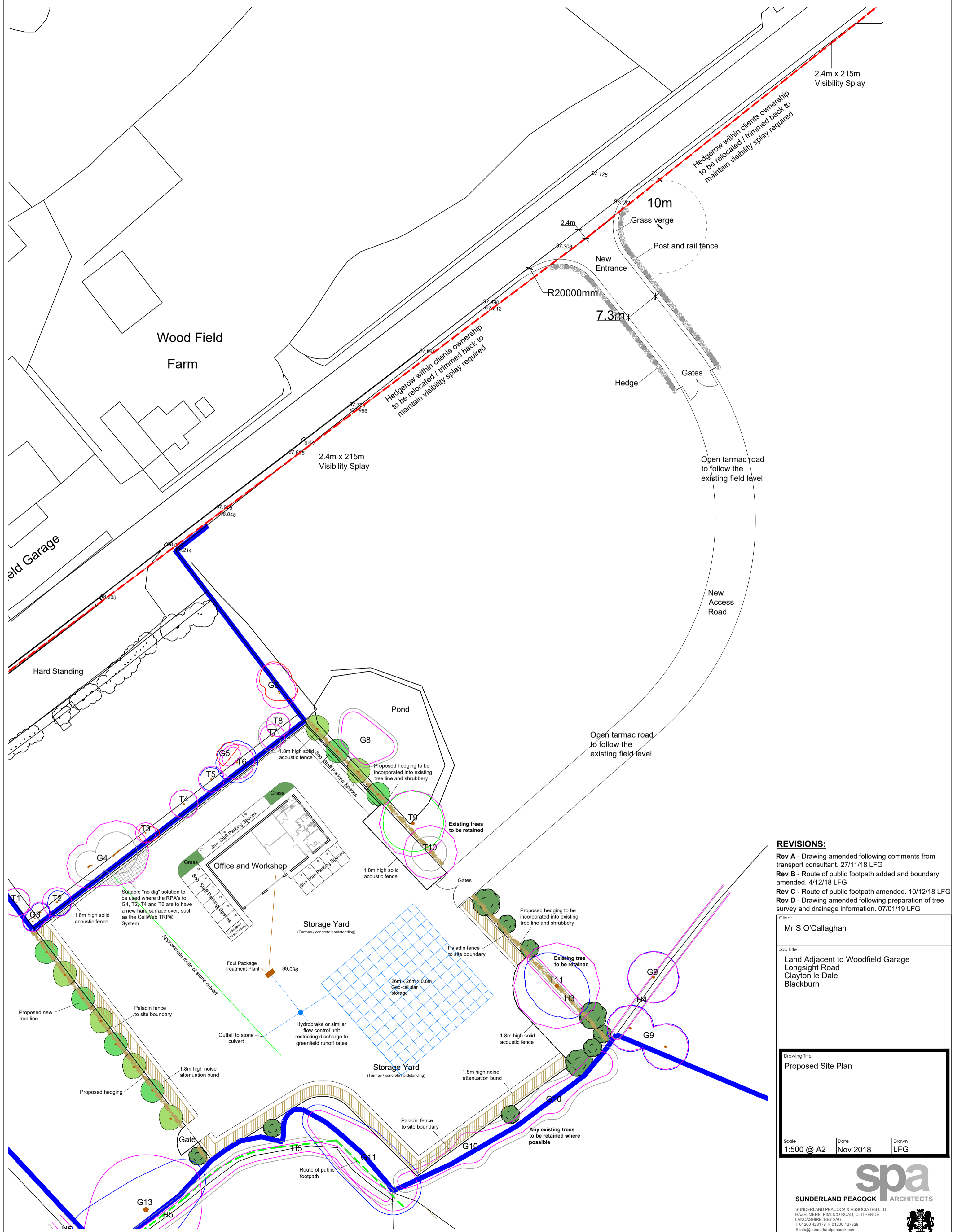

Proposed Site Plan
Scale 1:500

- REVISIONS:**
- Rev A** - Drawing amended following comments from transport consultant. 27/11/18 LFG
 - Rev B** - Route of public footpath added and boundary amended. 4/12/18 LFG
 - Rev C** - Route of public footpath amended. 10/12/18 LFG
 - Rev D** - Drawing amended following preparation of tree survey and drainage information. 07/01/19 LFG

Client
Mr S O'Callaghan

Job Title
**Land Adjacent to Woodfield Garage
Longlight Road
Clayton le Dale
Blackburn**

Drawing Title Proposed Site Plan		
Scale 1:500 @ A2	Date Nov 2018	Drawn LFG

spa
SUNDERLAND PEACOCK ARCHITECTS

SUNDERLAND PEACOCK & ASSOCIATES LTD.
HAZELMERE, PIMLICO ROAD, CLITHEROE
LANCASHIRE, BB7 2AG
T 01200 423178 F 01200 427328
E info@sunderlandpeacock.com
www.sunderlandpeacock.com

5365 -05 D