

CURRENT LAYOUT OF EXISTING GARAGE.

3201900777

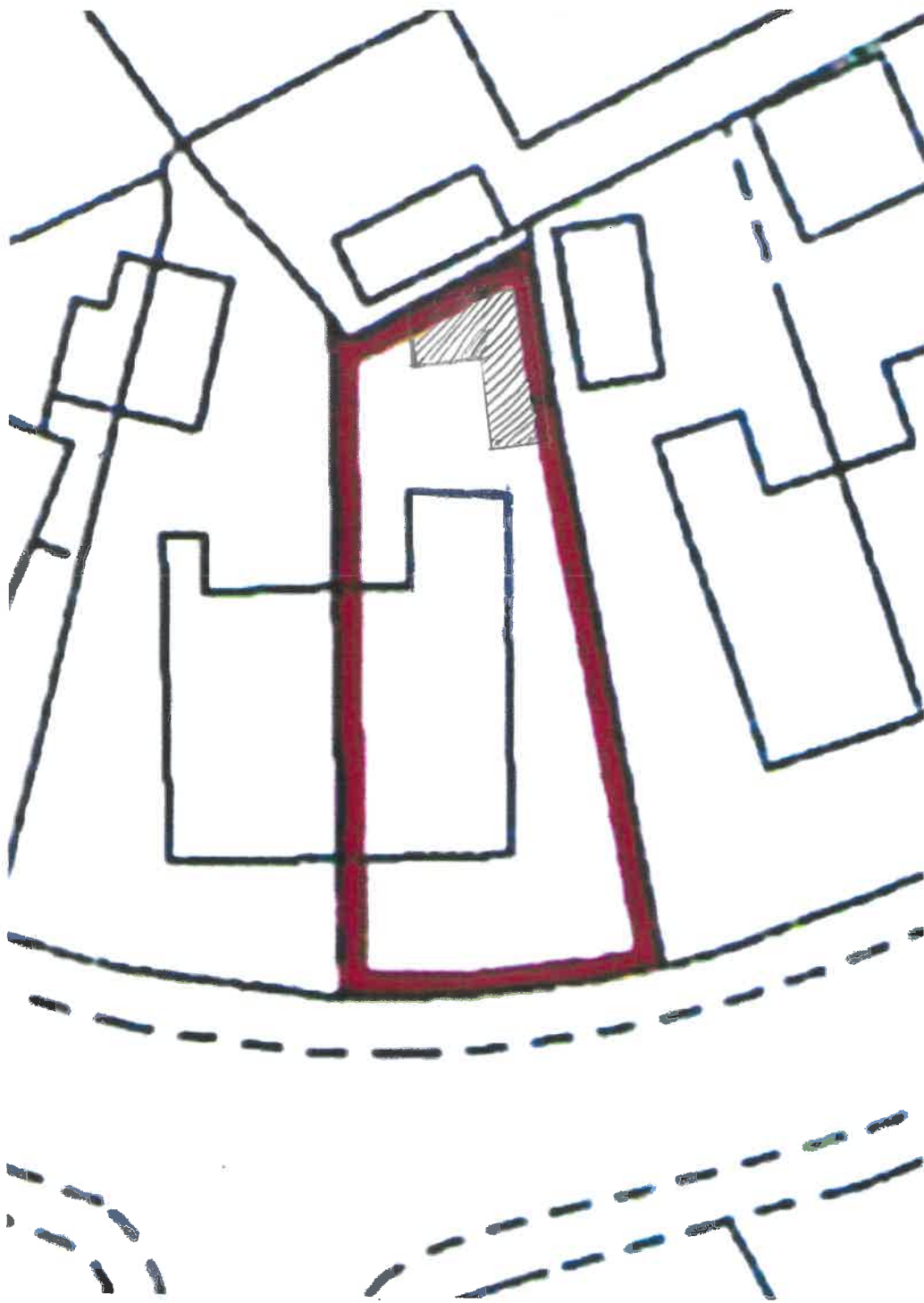

PROPOSED POSITION / OUTLINE OF NEW BUILDING.

3201903775

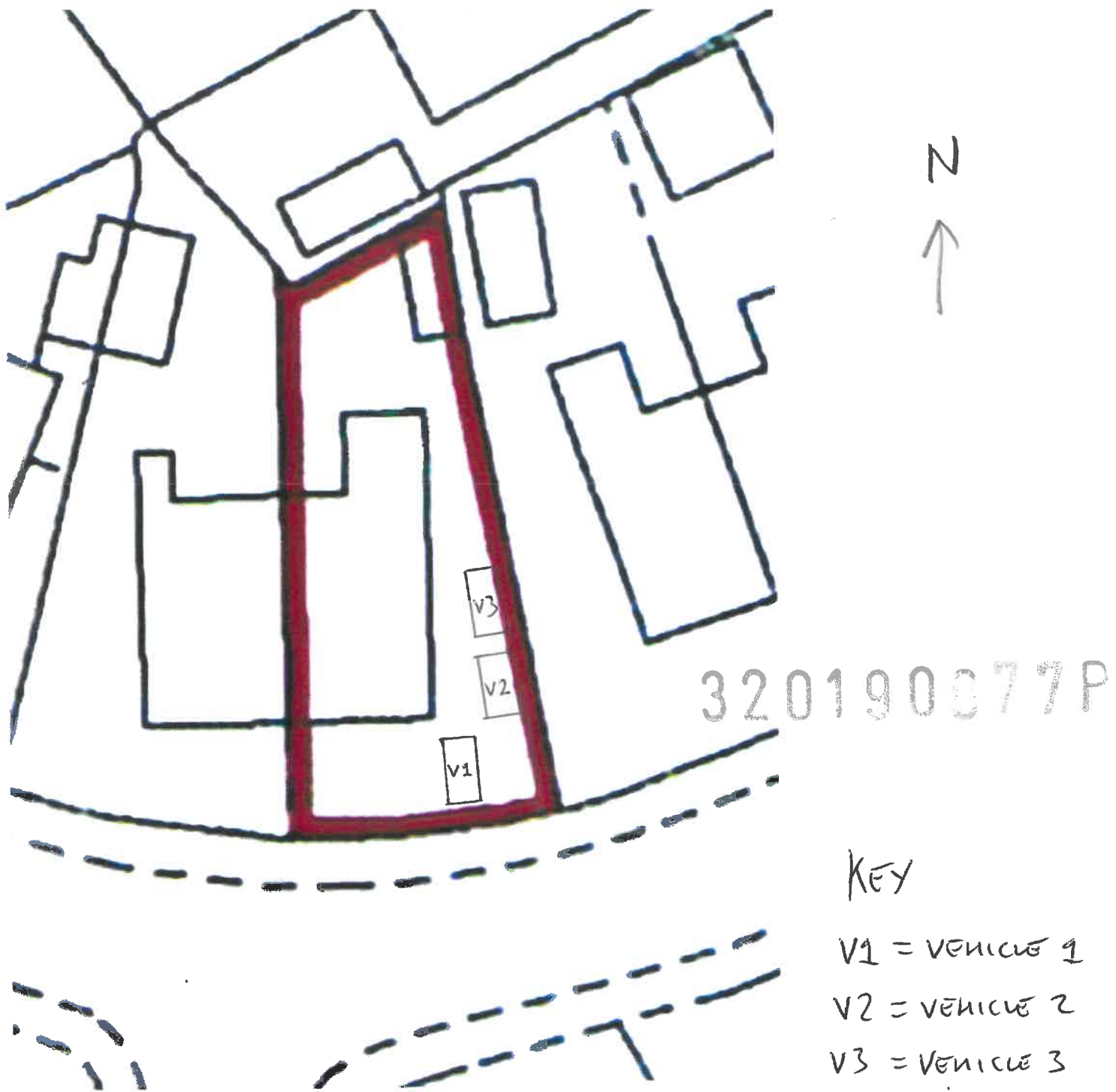

KEY

V1 = VEHICLE 1

V2 = VEHICLE 2

V3 = VEHICLE 3

FOR PURPOSES OF HIGHWAYS AND VEHICLE PARKING,
AS SHOWN ABOVE WE HAVE THREE VEHICLES
PARKED ON THE DRIVEWAY EACH DAY, SO REMOVAL
OF GARAGE TO A SINGLE STOREY BUILDING WILL
NOT AFFECT PARKING OR HIGHWAYS IN RESPECT
OF WHERE VEHICLES ARE TO BE KEPT DAY/NIGHT.