

TROLL MAXI3

FLOOR PLAN

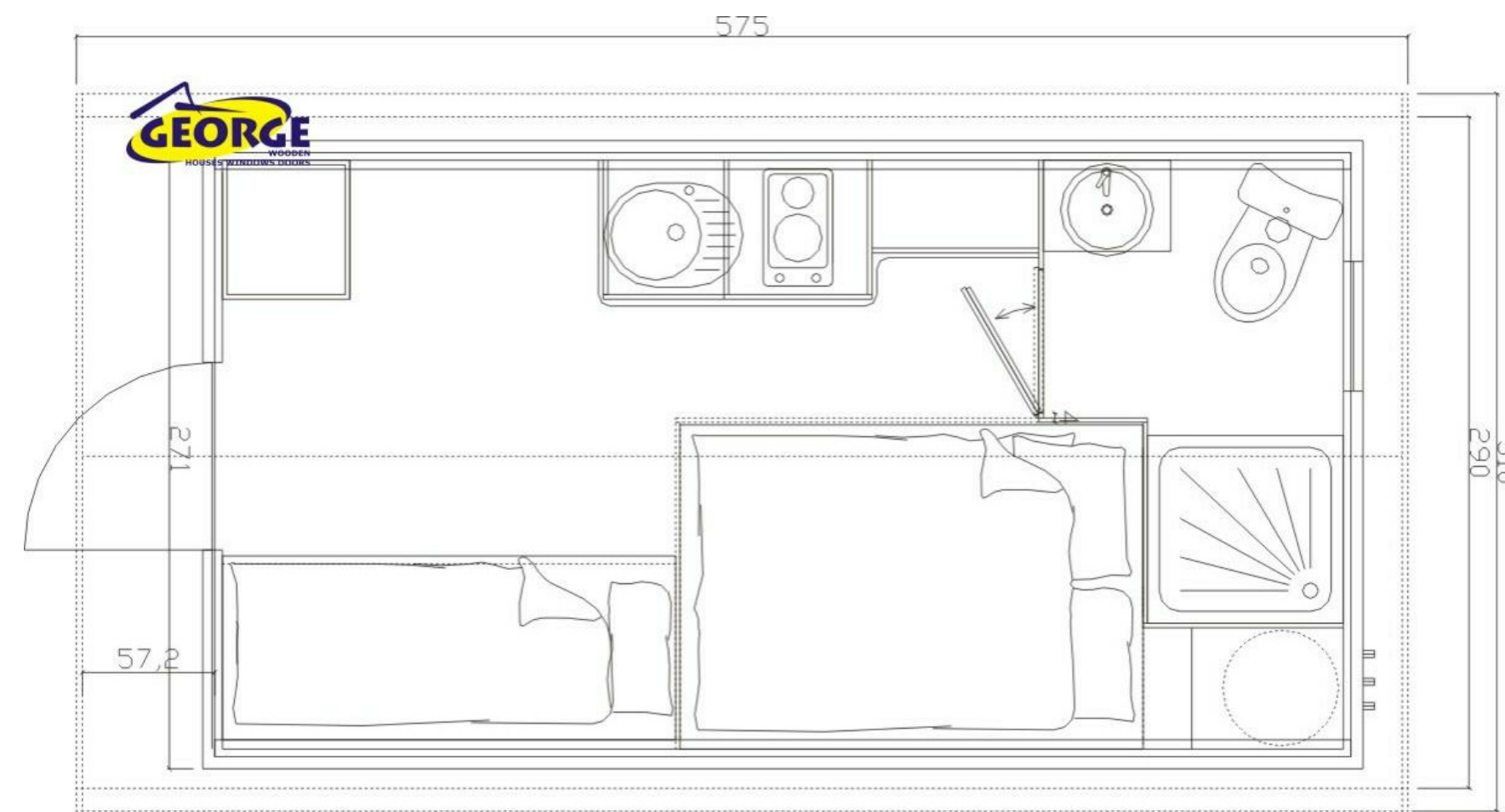

SIDE ELEVATION



Specification:

- Scandinavian withewood 33+28mm
- Painted window and door with double glass
- Varnished outside
- LED lights inside included
- Front wooden terrace included
- 1000W electric heater included
- Floor with AC4 dark oak panels
- Fully fitted electrics (plug and play)
- Internal lamps, switches and plugs
- Insulated roof and floor
- Plumbing installation with 100l water tank included
- Bathroom includes: shower 80cm x 80cm, toilet, sink, VMC
- Kitchen includes: fridge, sink, cooker and cupboards
- Double bed 140cm x 200cm with mattress
- Single bed 80cm x 190cm with drawer bed
- Wardrobe

Peter Hitchen
Architects

www.peterhitchenarchitects.co.uk

No.	Description	Date

CLIENT:
MR & MRS RUTHERFORD

PROJECT:
GREENDALE VIEW,
PROPOSED LOG CABINS &
ACCOMMODATION

SHEET:
TROLL MAXI3

Project number PHA/143

Date 23/01/19

Drawn by RH

Checked by PH

300

Scale