

Vale View Cottage

Burial Ground

Lantern Key

- Proposed tubular steel galvanised Fabrikat column of 6m nominal height with epoxy glass root protection, c/w 5° post top mounted Urbis Axia 3.1 5266 407mA NW LED Luminaire.
- Luminaire code - R3 S5 Axia 3.1 5266 8 Oslon Square Giant 407mA NW 00-56-615 Integrated lenses
- Luminaire to be installed with a Lucy Zodium SS12A Photocell (20/20 Switch Regime, Ratio 1:1) factory set to dim between 19:00 and 07:00.
- Column to be connected directly to Independent Distribution Network Operator (IDNO) underground electricity cables.

ISOLUX Colour Key

0.6 LUX

This drawing is copyright and MUST NOT be reproduced or used for competitive tendering without written permission from E.ON UK PLC. Contravention may result in legal action being taken.
The contractor is responsible for checking dimensions and any discrepancy to be verified with E.ON UK PLC. before proceeding. Figured dimensions only to be worked to, do not scale. IF IN DOUBT ALWAYS ASK

NOTES
THE INFORMATION ON THIS DRAWING DOES NOT ACCOUNT FOR INSTALLATION CONSIDERATIONS, SITE CONDITIONS OR PROVIDE ANY FORM OF RISK ASSESSMENT.

THE CALCULATIONS SHOWN BY THIS DRAWING ASSUMES THAT THE WHOLE AREA BEING CONSIDERED IS IN THE SAME PLANE, I.E. THERE ARE NO CHANGES IN GRADIENT OR ELEVATION.
IT IS THE RESPONSIBILITY OF THE DEVELOPER TO ENSURE ALL NEW LIGHTING EQUIPMENT IS TO BE CONNECTED TO IDNO NETWORK.

THIS DESIGN HAS BEEN PREPARED IN ACCORDANCE WITH THE HEMSA GUIDANCE NOTE - CDM2015 REGULATIONS.

NOTE - WHERE THERE IS CONFLICT WITH ROAD LIGHTING COLUMNS AND PROPOSED TREE PLANTING, THE LIGHTING IS TO TAKE PRIORITY. LANDSCAPE ARCHITECT TO LOOK TO RE-SITE PROPOSED TREES SO AS TO BE A MINIMUM OF 10M FROM LIGHTING COLUMNS.

COLUMNS TO BE INSTALLED AT THE REAR OF THE FOOTWAY, WHERE WITHIN VERGES, COLUMNS TO BE SETBACK A MINIMUM OF 0.8M FROM KERB LINE.

THE EXACT POSITIONS OF THE STREET LIGHTING COLUMNS SHALL BE AGREED ON SITE WITH THE LOCAL AUTHORITY STREET LIGHTING ENGINEER BEFORE ERECTION WORKS COMMENCE.

AFTER ERECTION COLUMNS SHALL BE NUMBERED CLEARLY IN ACCORDANCE WITH LOCAL AUTHORITY REQUIREMENTS.

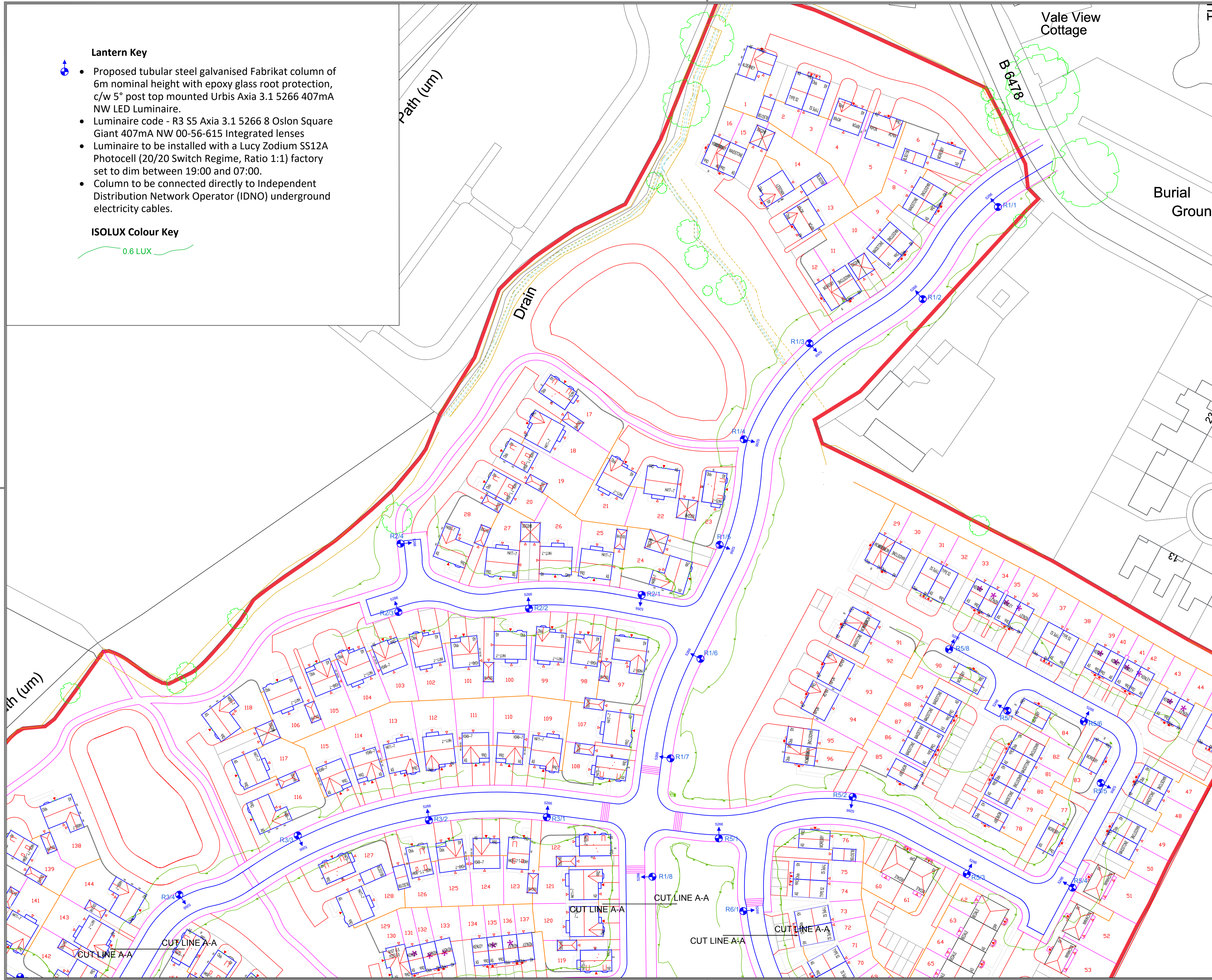

Revisions

Rev	Details	By	Date
-----	---------	----	------



Client	DAVID WILSON HOMES NORTH WEST		
Project	WADDOW VIEW, CLITHEROE		
Title	PROPOSED STREET LIGHTING LOCATIONS (1 of 2) FOR COMMENT/APPROVAL ONLY		
Dwg No.	SE-HL-01538-01	Revision	
Scales	1:500 @ A1	Date	01/02/2019
Drawn	MK	Checked	SDM
		Approved	SDM

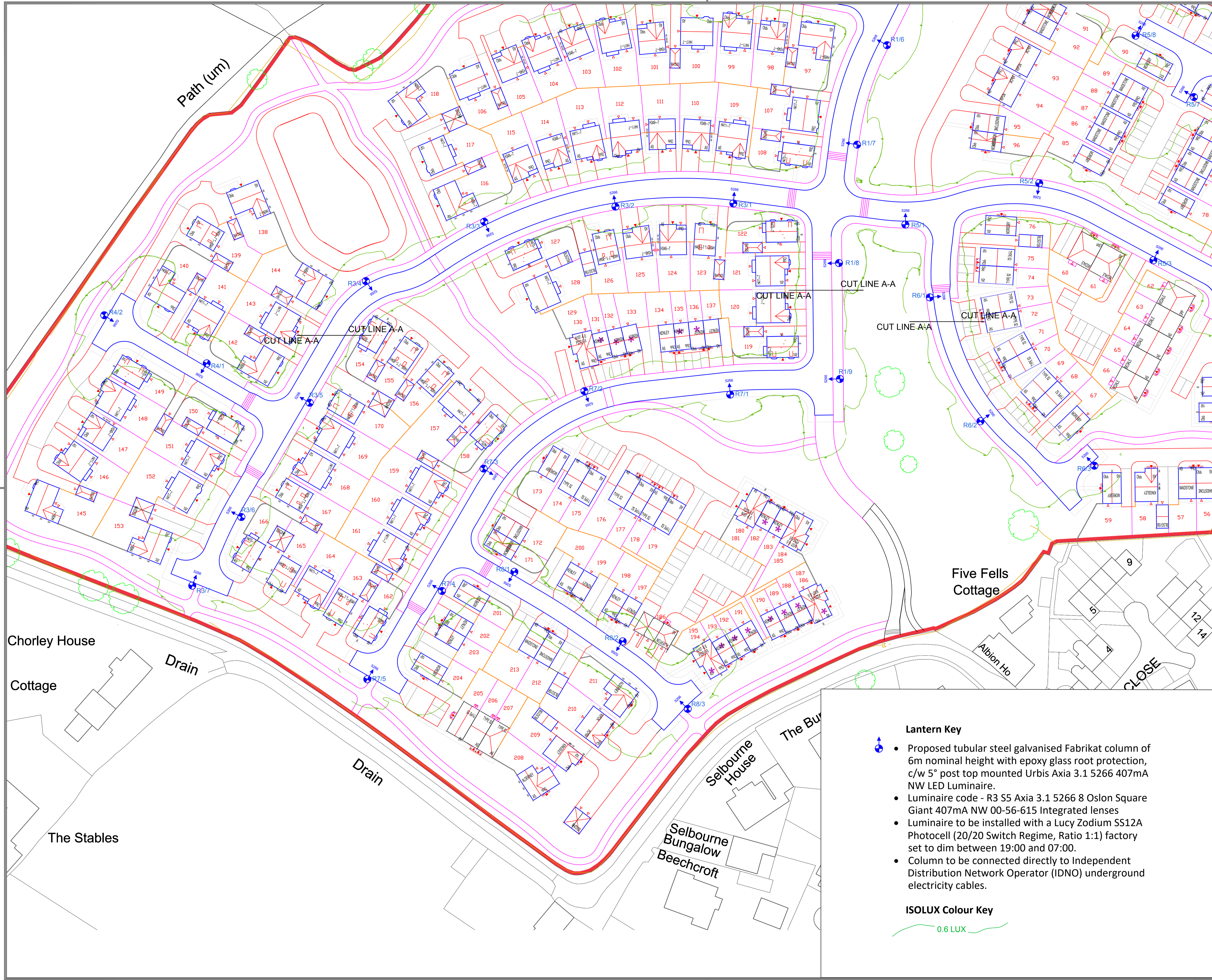

This drawing is copyright and MUST NOT be reproduced or used for competitive tendering without written permission from E.ON UK PLC. Contravention may result in legal action being taken.
The contractor is responsible for checking dimensions and any discrepancy to be verified with E.ON UK PLC. before proceeding. Figured dimensions only to be worked to, do not scale. IF IN DOUBT ALWAYS ASK

NOTES
THE INFORMATION ON THIS DRAWING DOES NOT ACCOUNT FOR INSTALLATION CONSIDERATIONS, SITE CONDITIONS OR PROVIDE ANY FORM OF RISK ASSESSMENT.
THE CALCULATIONS SHOWN BY THIS DRAWING ASSUMES THAT THE WHOLE AREA BEING CONSIDERED IS IN THE SAME PLANE, I.E. THERE ARE NO CHANGES IN GRADIENT OR ELEVATION.
IT IS THE RESPONSIBILITY OF THE DEVELOPER TO ENSURE ALL NEW LIGHTING EQUIPMENT IS TO BE CONNECTED TO IDNO NETWORK.
THIS DESIGN HAS BEEN PREPARED IN ACCORDANCE WITH THE HEMSA GUIDANCE NOTE - CDM2015 REGULATIONS.
NOTE - WHERE THERE IS CONFLICT WITH ROAD LIGHTING COLUMNS AND PROPOSED TREE PLANTING, THE LIGHTING IS TO TAKE PRIORITY. LANDSCAPE ARCHITECT TO LOOK TO RE-SITE PROPOSED TREES SO AS TO BE A MINIMUM OF 10M FROM LIGHTING COLUMNS.
COLUMNS TO BE INSTALLED AT THE REAR OF THE FOOTWAY, WHERE WITHIN VERGES, COLUMNS TO BE SETBACK A MINIMUM OF 0.8M FROM KERB LINE.
THE EXACT POSITIONS OF THE STREET LIGHTING COLUMNS SHALL BE AGREED ON SITE WITH THE LOCAL AUTHORITY STREET LIGHTING ENGINEER BEFORE ERECTION WORKS COMMENCE.
AFTER ERECTION COLUMNS SHALL BE NUMBERED CLEARLY IN ACCORDANCE WITH LOCAL AUTHORITY REQUIREMENTS.

Revisions			
Rev	Details	By	Date

- Lantern Key**
- Proposed tubular steel galvanised Fabrikat column of 6m nominal height with epoxy glass root protection, c/w 5" post top mounted Urbis Axia 3.1 5266 407mA NW LED Luminaire.
 - Luminaire code - R3 S5 Axia 3.1 5266 8 Oslon Square Giant 407mA NW 00-56-615 Integrated lenses
 - Luminaire to be installed with a Lucy Zodiac SS12A Photocell (20/20 Switch Regime, Ratio 1:1) factory set to dim between 19:00 and 07:00.
 - Column to be connected directly to Independent Distribution Network Operator (IDNO) underground electricity cables.

ISOLUX Colour Key
0.6 LUX



Client	DAVID WILSON HOMES NORTH WEST		
Project	WADDOW VIEW, CLITHEROE		
Title	PROPOSED STREET LIGHTING LOCATIONS (2 of 2) FOR COMMENT/APPROVAL ONLY		
Dwg No.	SE-HL-01538-02	Revision	
Scales	1:500 @ A1	Date	01/02/2019
Drawn	MK	Checked	SDM
		Approved	SDM