

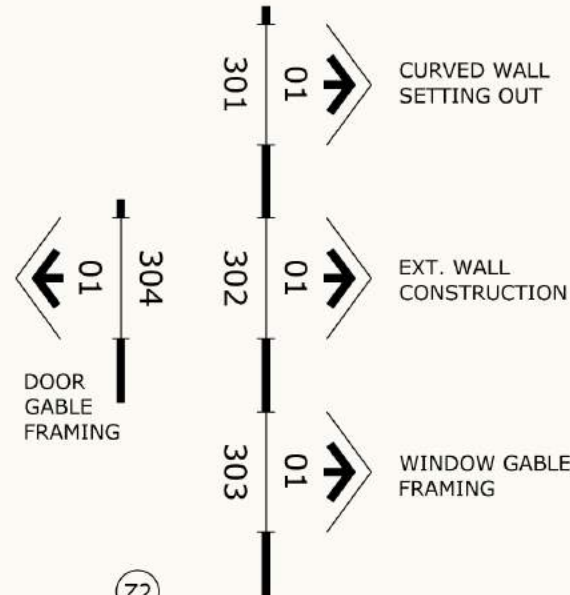

201-04



20-102



30-102



NOTES :

NBS SECTION HEADINGS

- G Structural/ Carcassing metal/timber
- H Cladding/Covering
- K Linings/Sheathing/ Dry partitioning
- L Windows/Doors/Stairs
- M Surface finishes
- N Furniture/Equipment
- P Building fabric sundries
- R Disposal systems
- S Piped supply systems
- T Mechanical heating/Cooling/ Refrigeration systems
- V Electrical supply/power/ lighting systems
- Z Building fabric reference specification

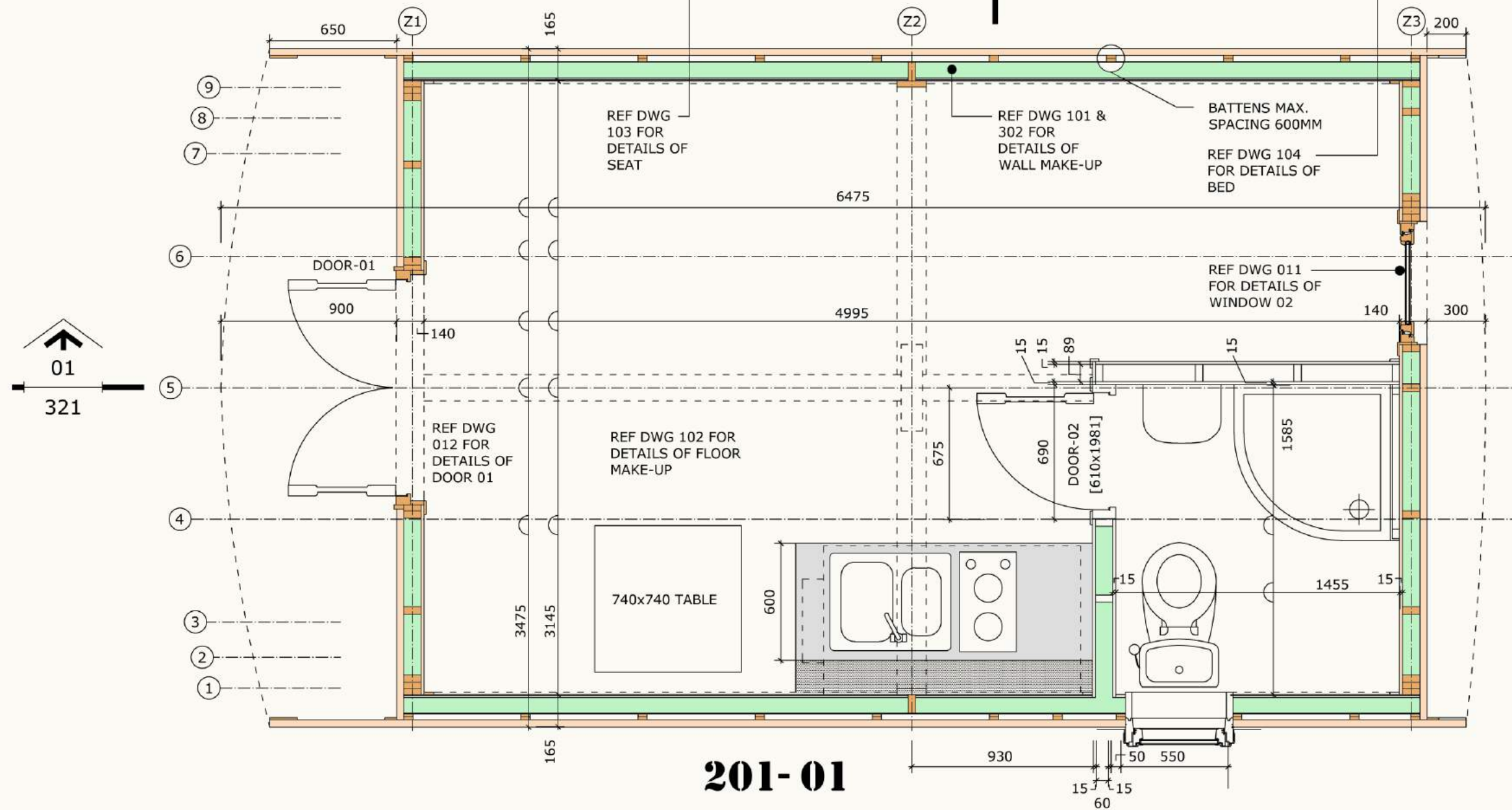

201-01

WIGWAM CABIN COMPANY:
 PO BOX 28610
 CAMMO PARKWAY
 EDINBURGH
 EH4 9BU
 EMAIL : info@wigwamcabins.com
 TEL: 0131 450 7126

NOTES:

PROJECT:
 THE RUNNING WATER WIGWAM DELUXE

DRAWING TITLE:
 FLOOR PLAN

VIVIGWAM[®] cabins		
DATE:	DESCRIPTION	REV:
STATUS: PRELIMINARY		
SCALE AT A3 : 1:25	JOB No: RWW-1.0	DRAWN BY: YTB
DATE: 20-10-13	DWG No: 201	REV: -