

**Ground Floor Plan**  
(Scale at 1:50)

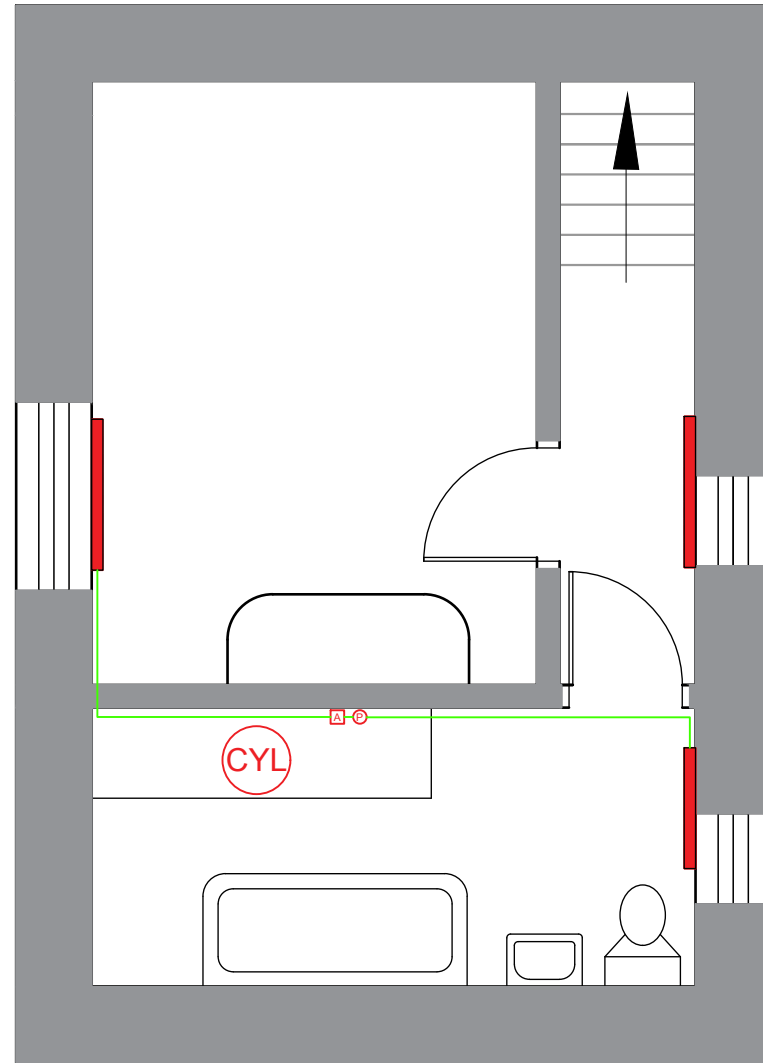

**First Floor Plan**  
(Scale at 1:50)





**NOTES**

Proposal to install Amptek Electrical Boiler heating, located to first floor bathroom with pipework through internal walling from bathroom to bedroom and from kitchen to living room. Electrical boilers do not need flues and are minimally intrusive during installation, therefore making them the most appropriate heating method for Listed Buildings.

It is proposed to use an Amptek Electrical Boiler with 5 no. Radiators. The boiler itself has a 90mm square footprint and is 1m in vertical length once fitted. In performance regulations it follows Building Regulations Part G, Part L and the Water Supply Regulations. It also meets BS7671.

Notes:  
1. This Drawing & Design are copyright and may not be reproduced without the written consent of The J.Y.M. Partnership  
2. DO NOT SCALE - Use Figured Dimensions Only  
3. The CONTRACTOR is to check and verify all Figured Dimensions, Site & Drainage Levels prior to commencement of work and notify The J.Y.M. Partnership of any discrepancies.  
4. The Contractor is to check the drawing against all other relevant drawings, specifications and/or bills of quantities as issued.  
5. IF IN DOUBT - ASK!

**KEY**

-  Pipework
-  Radiator
-  Amptek
-  Pump
-  Cylinder

Rev	Date	Revision

**JYM**  
partnership

Oak House 28 Sceptre Way  
Bamber Bridge Preston PR5 6AW  
Tel : 01772 323666  
Fax : 01772 338611  
Email : jym@jympartnership.co.uk  
www.jympartnership.co.uk

project:  
Brabins Almshouses, 29 Windy Street, Chipping, Lancashire

client:  
Brabins Charitable Trust

drawing title:  
Electrical Boiler Installation

scale:  
As shown at A3

drawn: LM checked: CB

date:  
June 2019

project no.	drg. no.	rev.
1608	09	