

NOTES

This drawing is to be read in conjunction with all related project drawings. Do not scale from this drawing. All dimensions are to be checked and verified on site prior to commencing any works or other detailed drawings. Studio91 Architecture are to be made aware immediately of any discrepancies. This drawing along with all the designs and proposals indicated are copyright and remain the property of Studio91 Architecture.

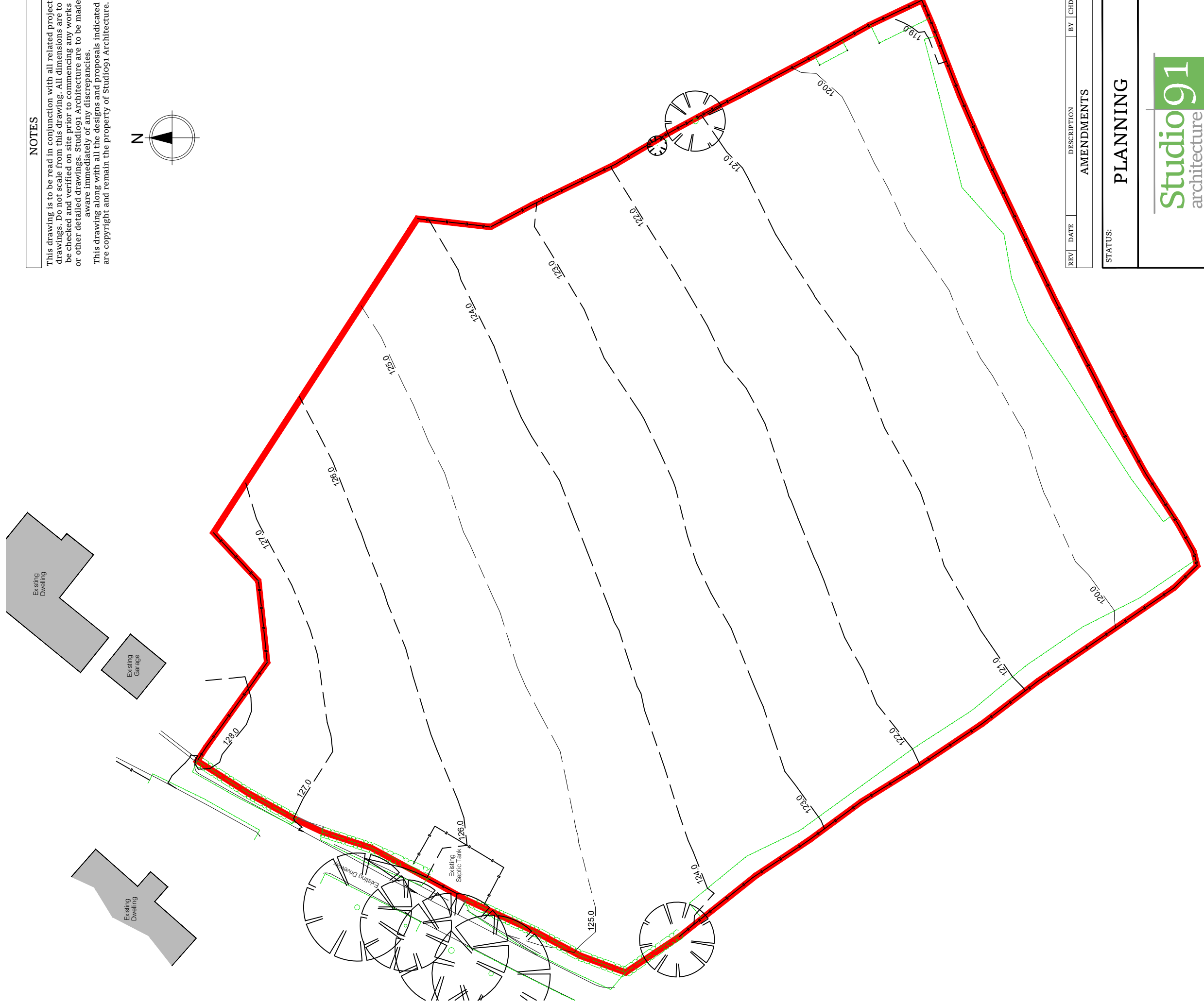
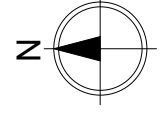

REV	DATE	DESCRIPTION	BY	CHD
AMENDMENTS				

STATUS: PLANNING	
	
T: 01274 974596 E: info@studio91architecture.co.uk W: www.studio91architecture.co.uk	
CLIENT: Mr & Mrs Taylor	
SITE: Elmridge Farm, Elmridge Lane, Chipping, PR3 2NY	
PROPOSAL: Proposed Equestrian/Agricultural Facilities at Elmridge Farm	
TITLE: Existing Site Layout	
PROJECT NO: 2019-1021	DRAWING NO: P-101
SCALE AT A3: 1:500	DATE: July 2019
	DRAWN: SPN
	REVISION: #

