

Existing Site Plan with Topographical Data - 1:500

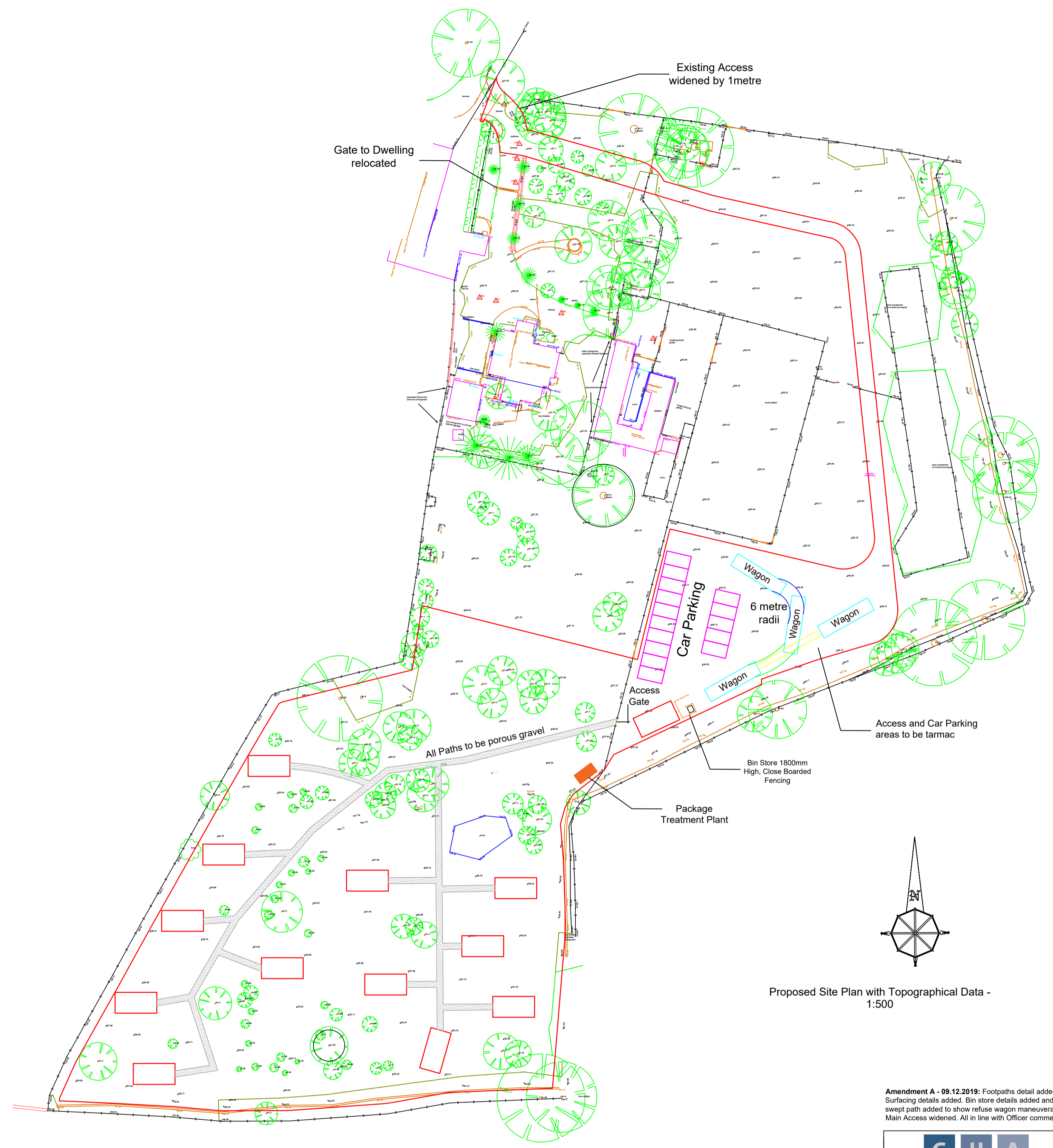

Proposed Site Plan with Topographical Data - 1:500

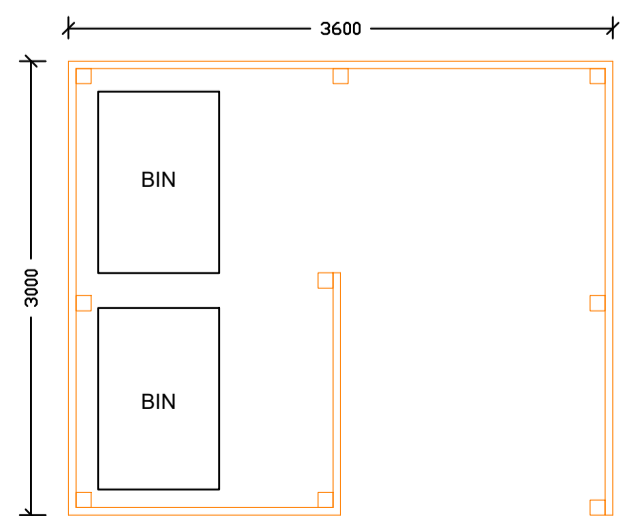

Proposed Floor Plan - 1:50

Post and rail construction.
Close boarded with 100mm boards

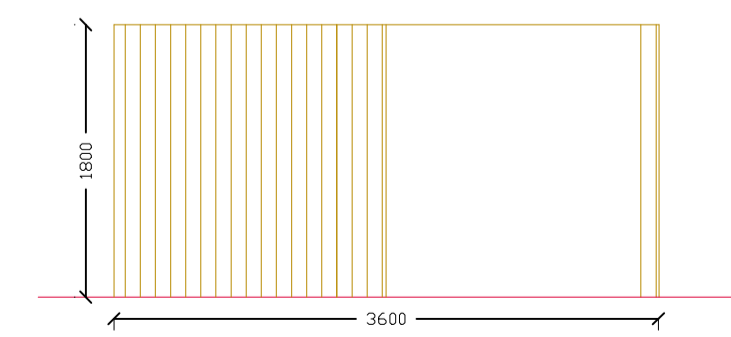

Proposed Easterly Facing Elevation - 1:50

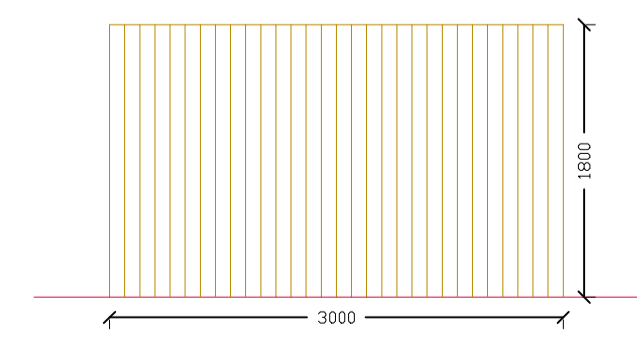

Proposed Northerly Facing Elevation - 1:50

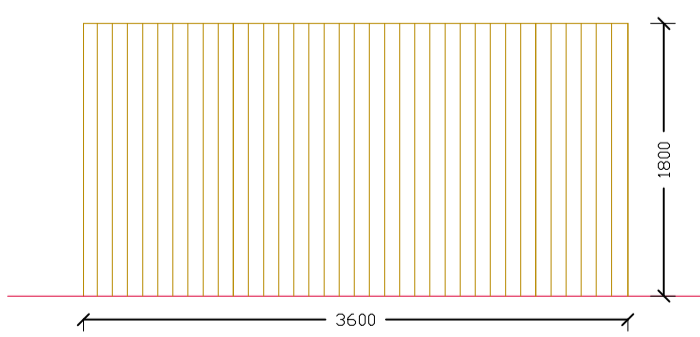

Proposed Westerly Facing Elevation - 1:50

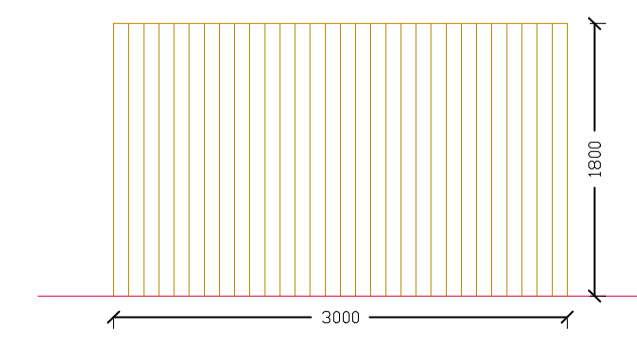

Proposed Southerly Facing Elevation - 1:50

Proposed Bin Storage - 1:50

Notes:
All work is to be carried out to the latest current British standards Codes of Practice and recognised working practices.
All work and materials should comply with Health and Safety legislation.
All dimensions are in millimetres where explicitly shown otherwise.
The contractor should check and certify all dimensions as work proceeds and notify the architect of any discrepancies.
Do not scale off the drawings, if in doubt ask.

Amendment A - 09.12.2019: Footpaths detail added. Surfacing details added. Bin store details added and swept path added to show refuse wagon maneuverability. Main Access widened. All in line with Officer comments.

G H A
Gary Hoerty Associates
Gary Hoerty Associates Chartered Surveyors
Suite 9 - Grindleton Business Centre
The Spinney
Grindleton
Clitheroe
Lancashire BB7 4DH
T: 01200 449700
Email: info@ghaonline.co.uk

Project: (No:Monk/924/2694)
Planning - Proposed planning application for a development of small holiday lodges at
Pendle View,
Primrose Lane,
Mellor BB2 7EQ.

Title: Existing and Proposed Site Plans.
Proposed Bin Store Plan and Elevations.

Drawing No: Monk/924/2694/01 **Drawn:** PF

Client: Mrs L Monk

Date: 25.09.2019 **Scale:** 1:50 & 1:500 @ A1

Amendments: A