



Existing Site Plan

Scale = 1:500



Proposed Site Plan

Scale = 1:500

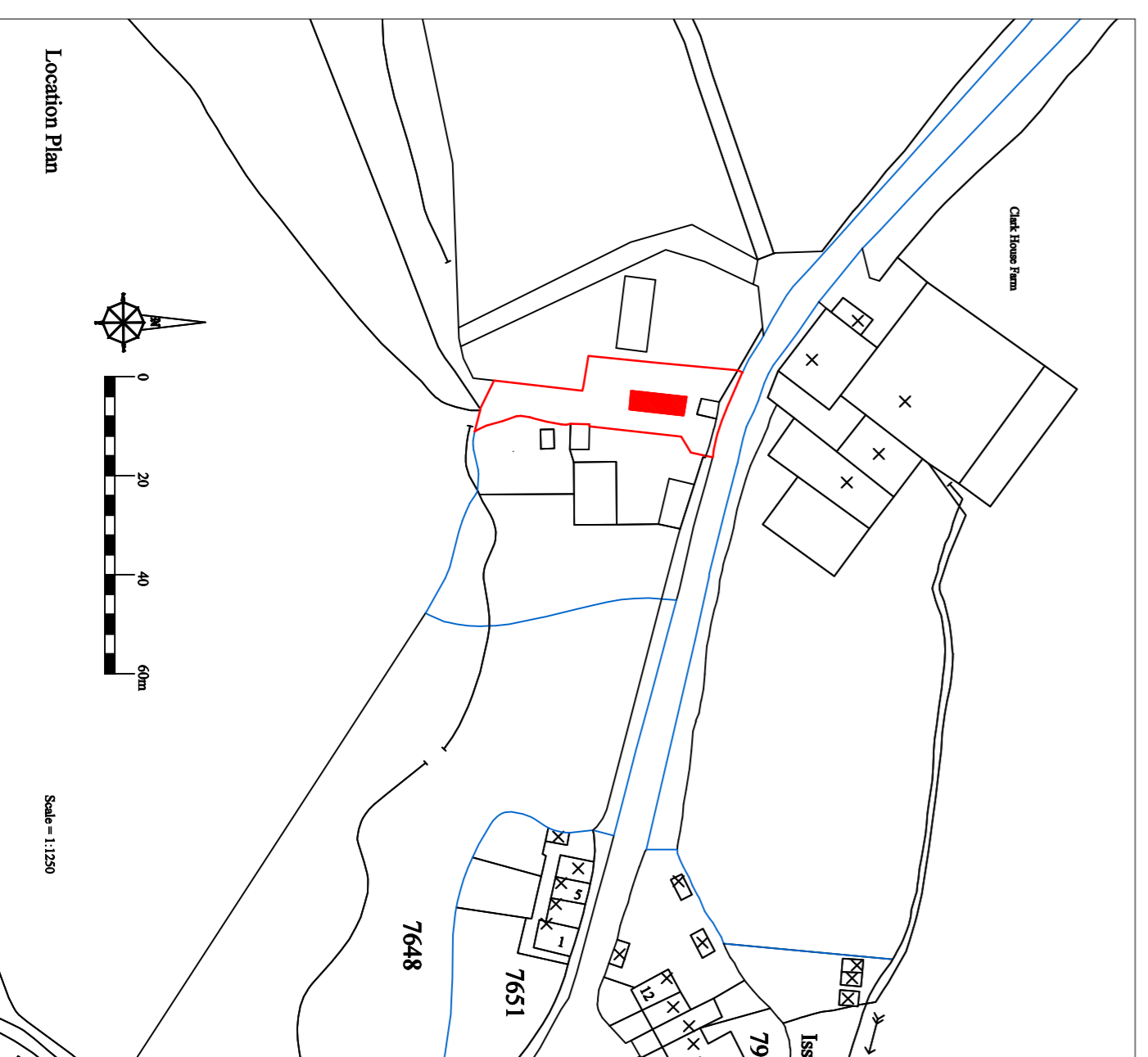

Location Plan

Scale = 1:1250

Amend - A. W. Crank Removed

J. HADFIELD.
ENGINEERING, SURVEYING.

Springer House, Clipping, Laneside, PO3 2DQ.
Tel: 01740 925096, Fax: 01708 502185

Client Details:
Messrs P. Stott & Son

Project Details:

Barn Conversion
Existing & Proposed Site / Location Plans

Project Address:

Clark House Farm

Chipping

Preston

Project Number: 212/202	Date: Oct/19	Scale: 1:500 @ A1	By: JH
----------------------------	-----------------	-------------------------	-----------

DO NOT SCALE THIS DRAWING. CHECK ALL DIMENSIONS ON SITE

THE DRAWING IS PROVIDED BY CLIENT. IT IS NOT TO BE REPRODUCED OR USED IN ANY MANNER WITHOUT THE WRITTEN PERMISSION OF THE ENGINEER. THE ENGINEER ACCEPTS NO LIABILITY FOR ANY DAMAGE OR LOSS OF PROFITS OR BUSINESS ARISING FROM THE USE OF THIS DRAWING.