

This drawing is to be read in conjunction with all other relevant technical information, statutory approvals, specifications and 3rd party information. Do not scale from this drawing. Use only dimensions provided. All dimensions and levels to be checked on site and all discrepancies must be reported to the drawings author immediately. Responsibility cannot be accepted for alteration and/or deviation from this design without the prior acknowledgement of the drawings author. Any commercial decisions relating to this information must make due allowance for dimensional and area variation resulting from the design development and construction processes as well as the requirements of statutory authorities. This drawing is to be used only for the purposes indicated. This drawing is copyright and the property of DBA Architects Ltd (DBA) and must not be reproduced without prior written agreement. Any Intellectual Property Rights (IPR) relating to the design(s) described in this drawing belong to the originating designer and, where it is not DBA's design, no credit for the design or IPR is sought by this drawings author.

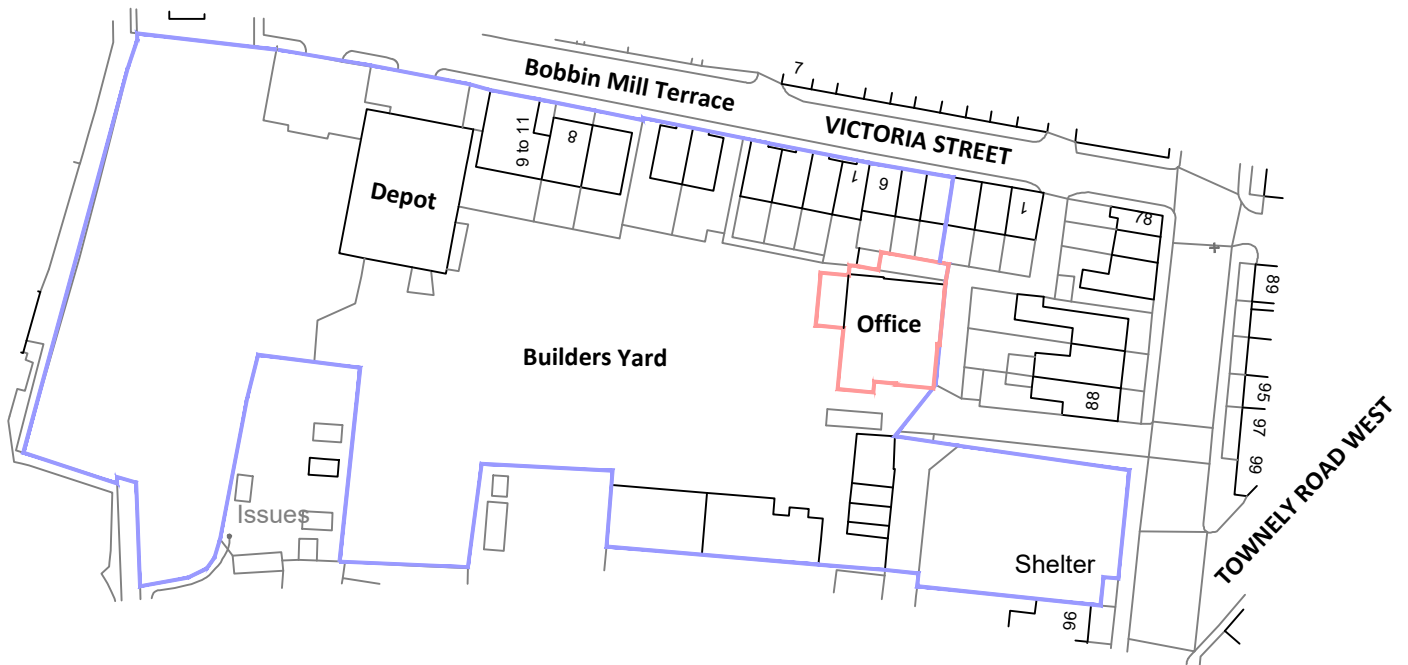

**EXISTING SITE LOCATION PLAN: 1:1250**

Rev	Description	By	Chk	Date



The Office  
Shire House  
Whinney Brow Lane  
Forton  
Preston  
PR3 0AE  
E: studio@dbaarchitects.co.uk  
T: 01524 233701 M: 07763624114

Client: **WALTER CAREFOOT & SONS LTD**  
Project: **Office Redevelopment,  
Blackpool Road. Longridge, Preston, PR3 3AL**  
Drawing Title: **EXISTING SITE LOCATION PLAN**

Project No: **1016** Scale @ A4 **1: 1250**  
Drawn: **DB** Checked:  
Drawing No: **L(00)001**

Date: **SEPT 2019**  
Status: **PLANNING**  
Revision: