

Floor Joist Layout

3201908167

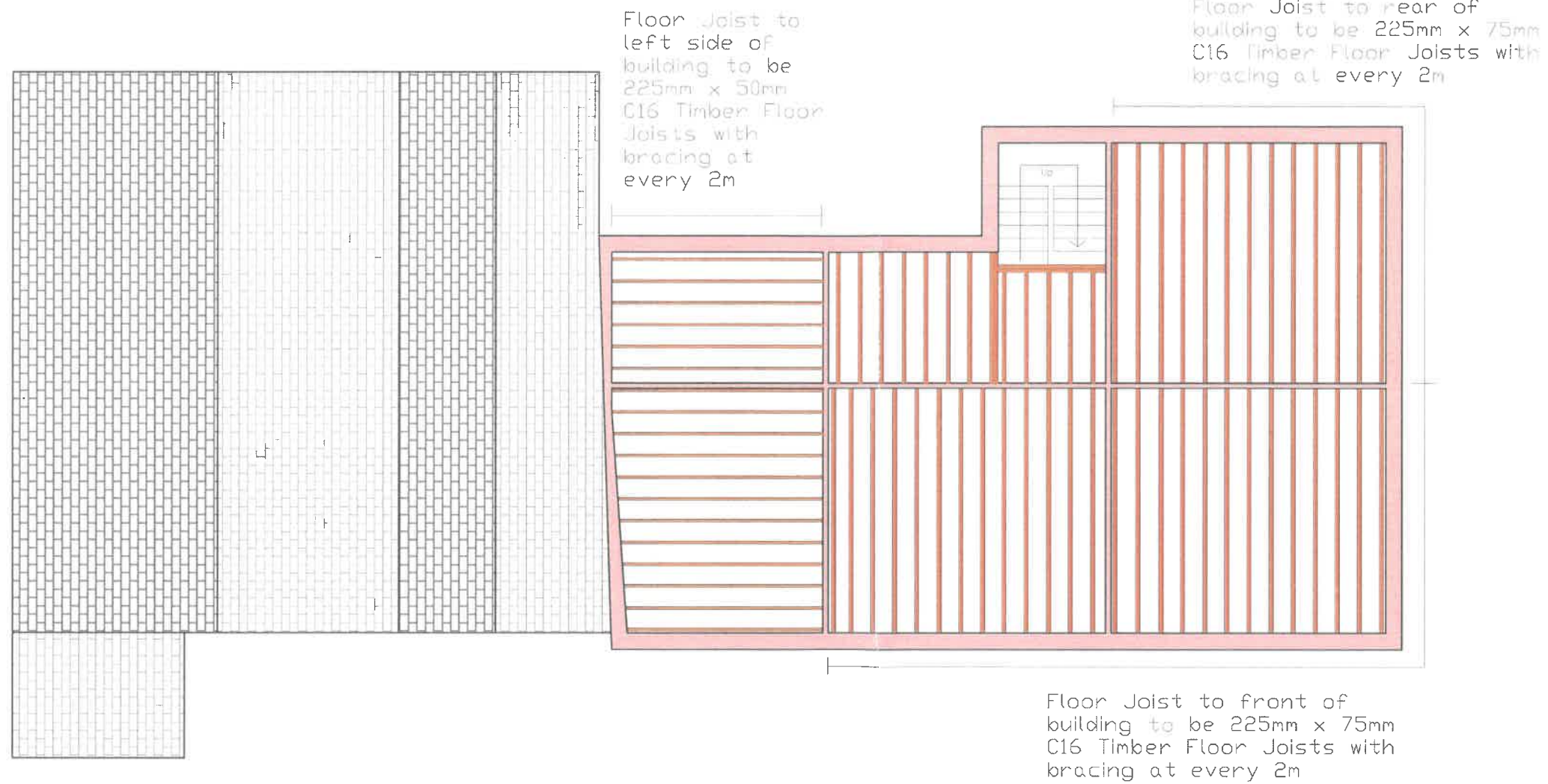

New floor to comprise of 200mm of mineral wool with 15mm soundblock board to topside of joist finished with 22mm T&G chipboard floor boards

Floor Joist Layout

Proposed Development At Waterloo House, Waterloo Road, Clitheroe

Formation of Dormer to rear of property to create 1 x 1 bedroom studio and 1 x 2 bedroom flat.

Client Details

Mr & Mrs Horsfall

Notes

Floor joist to run from wall plates bolted to front and rear wall to load bearing wall in center of property

Plan Drawn

By

Roof-Space Conversions Ltd

267 Halifax Road
Nelson
Lancashire
BB9 0ER