

This drawing is to be read in conjunction with all relevant Architect, consultants' and specialists' drawings and specifications. The Architect is to be notified of any discrepancies before proceeding. Do not scale from this drawing. All dimensions and levels are to be checked on site. This drawing is subject to copyright. All work carried out before Planning and Building Permission has been granted is at the contractors risk.

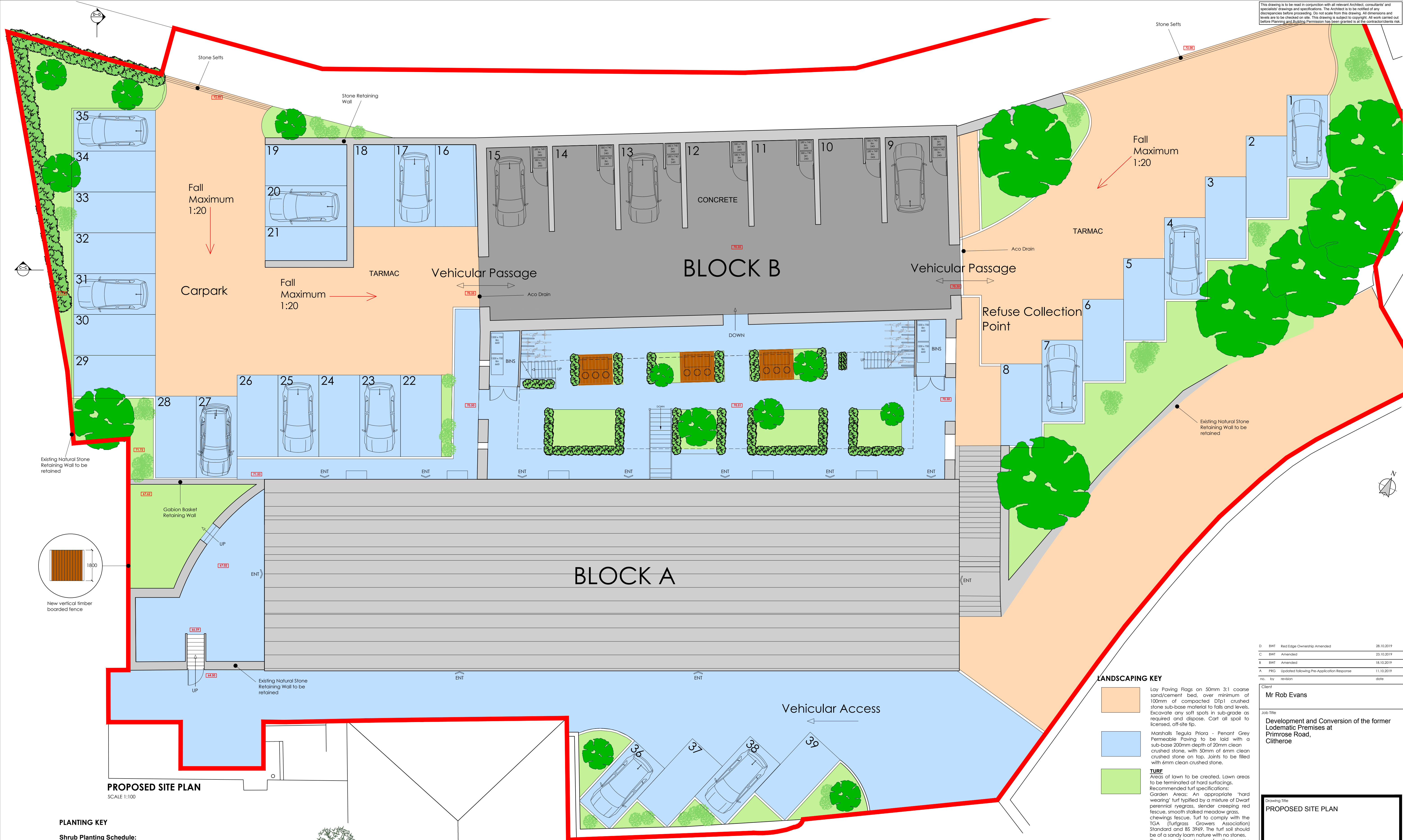

#### PLANTING KEY

##### Shrub Planting Schedule:

Species / size  
Sambucus nigra 'Black Lace' (Black Elderberry) : 3L  
Pittosporum tenuifolium : 3L  
Escallonia Donard Seedling : 3L  
Cornus alba Elegantisima (Dogwood) : 3L  
Viburnum tinus: 3L

##### Tree Planting Schedule:

Species / size  
Sorbus aucuparia 'Sheerwater seedling' : 10 - 12 cm root balled  
Corylus collura (Turkish Hazel) : 10 - 12 cm root balled  
Betula utilis Jacquemontii (Himalayan Birch) : 10 - 12 cm root balled  
Amelanchier lamarckii (snowy mespilus): 10 - 12 cm root balled  
Malus Evereste (White Flowering Crab Apple): 10 - 12 cm bare root

#### SCHEDULE OF APARTMENTS

BLOCK A : 4 X 1 BED APARTMENTS  
BLOCK A : 14 X 2 BED APARTMENTS  
BLOCK B : 7 X 1 BED APARTMENTS  
TOTAL: 25 APARTMENTS

PARKING SPACES: 4  
PARKING SPACES: 28  
PARKING SPACES: 7  
PARKING SPACES: 39

#### LANDSCAPING KEY

- Lay Paving Flags on 50mm 3:1 coarse sand/cement bed, over minimum of 100mm of compacted D1p1 crushed stone sub-base material to falls and levels. Excavate any soft spots in sub-grade as required and dispose. Cart all spoil to licensed, off-site tip.
- Marshall's Tegula Priora - Penant Grey Permeable Paving to be laid with a sub-base 200mm depth of 20mm clean crushed stone, with 50mm of 6mm clean crushed stone on top. Joints to be filled with 6mm clean crushed stone.
- TURF**  
Areas of lawn to be created. Lawn areas to be terminated at hard surfacings. Recommended turf specifications:  
Garden Areas: An appropriate 'hard wearing' turf typified by a mixture of Dwarf perennial ryegrass, slender creeping red fescue, smooth stalked meadow grass, chewings fescue. Turf to comply with the TGA (Turfgrass Growers Association) Standard and BS 3969. The turf soil should be of a sandy loam nature with no stones. The grass will be dense, of uniform green colour, free of broadleaved weeds and not visibly affected by pest or disease. Existing vegetation and stones should be removed and a light fill prepared.  
STORAGE: Turf is liable to deteriorate rapidly and should be laid within 24 hours of receipt.  
LAYING: Turfing shall comply with BS 3969 and be carried out when the weather and soil conditions are suitable.  
Turfing should not be carried out in exceptionally dry or frosty weather or when the ground is waterlogged.  
AFTERCARE: Allowance should be made to keep the turf watered during dry periods encountered throughout the establishment period.

D	BWT	Red Edge Ownership Amended	28.10.2019
C	BWT	Amended	23.10.2019
B	BWT	Amended	18.10.2019
A	PRG	Updated following Pre-Application Response	11.10.2019
no.		by	revision
Client		date	

Mr Rob Evans

Development and Conversion of the former Lodematic Premises at Primrose Road, Clitheroe

PROPOSED SITE PLAN

Scale	Date	Drawn
1:100 @ A1	June 2019	Ben Turner

**spa**  
SUNDERLAND PEACOCK & ASSOCIATES LTD.  
HAZELWIRE, PIMALICO ROAD, CLITHEROE  
LANCASHIRE, BB7 2AG  
T 01200 423178 F 01200 427328  
E info@sunderlandpeacock.com  
www.sunderlandpeacock.com

5857 - 15  
REV D