

floor areas

existing	
ground floor	150 m2
first floor	125 m2
total	275 m2
house	
ground floor	170 m2
first floor	175 m2
total	345 m2
garage	100 m2
gross external floor areas	

this drawing is to be read in conjunction with all relevant consultants and specialists drawings. the architect is to be notified of any discrepancies before proceeding.
do not scale from this drawing. all dimensions are to be checked on site.
this drawing is subject to copyright.

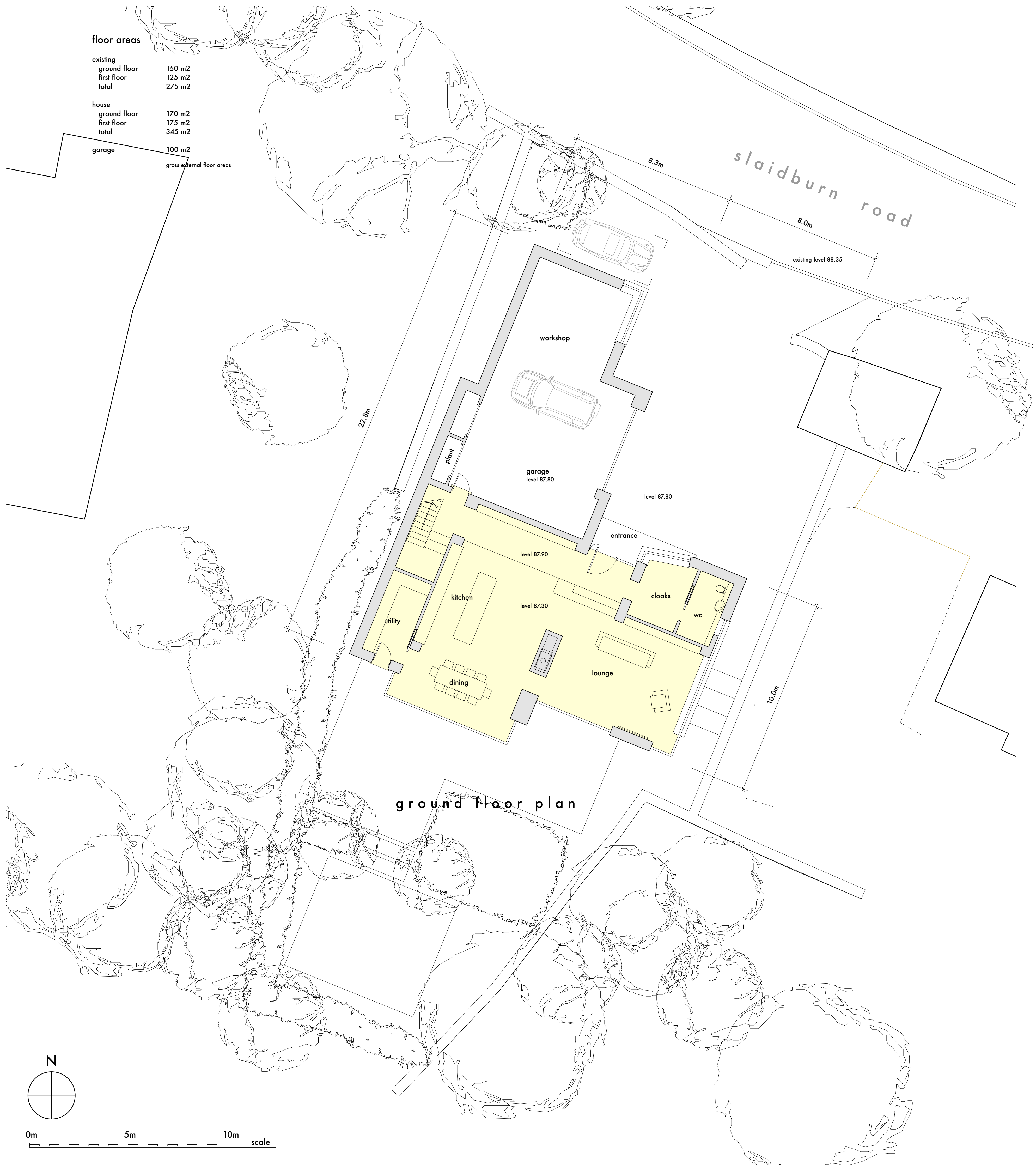

ground floor plan



first floor plan

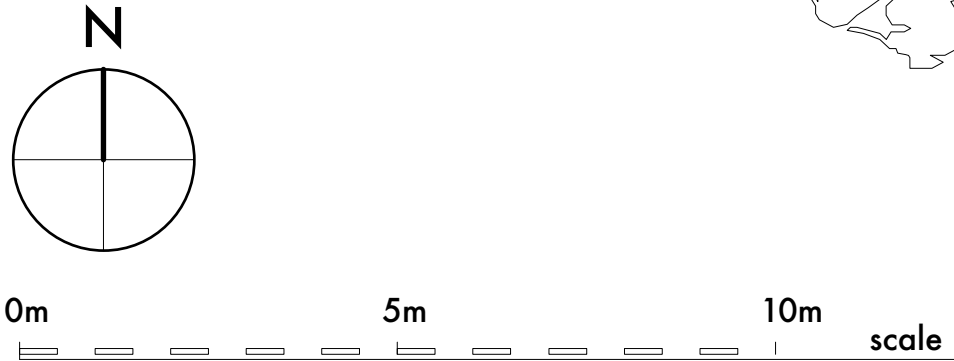

stanton andrews
architects

44 york street
clitheroe
BB7 2DL

t 01200 444490
e mail@stantonandrews.co.uk
w stantonandrews.co.uk

parsons croft
waddington

proposed
floor plans

drg.no.	1833 / PL 11	rev.	-
drawn, na	date, nov.19	scale,	1:100 @ A1