

540 x 540 art. stone cappings with drip mold to piers

End of wall finished with piers

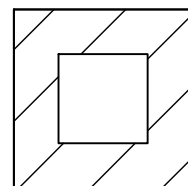

Exposed Site Details
Pillar to be of hollow construction with reinforcement mesh inserted to the full length of the pier and concrete infill to ensure stability and strength.
(Detail to be used on exposed sites only)

Concrete Bricks/ Artificial Stone -
Expansion Joints to be used to the side of every pillar as instructed by structural engineers
(Detail to be used on exposed sites only)

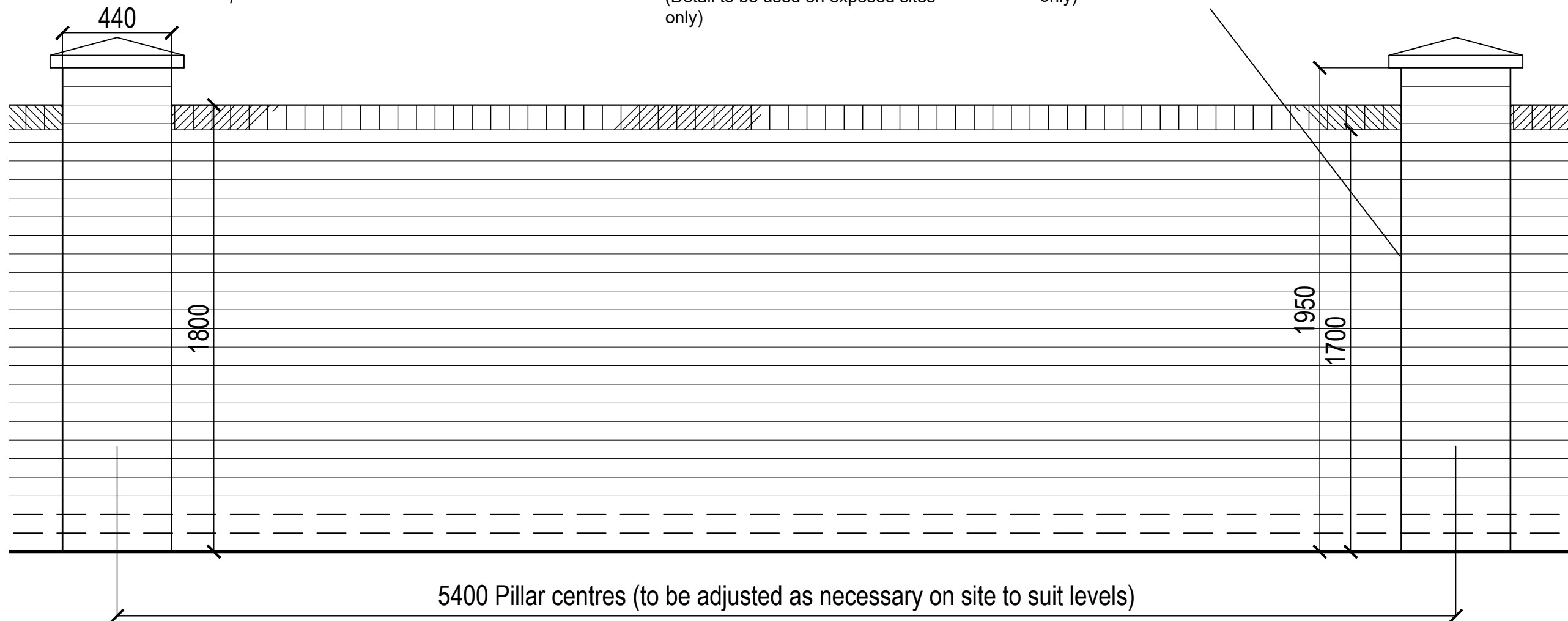

5400 Pillar centres (to be adjusted as necessary on site to suit levels)

ELEVATION 1:20 scale

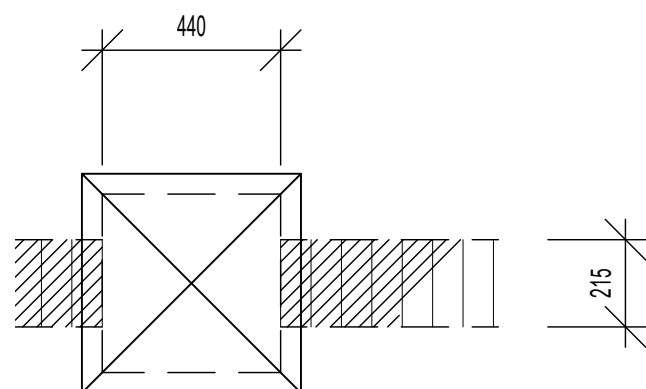

PLAN 1:20 scale

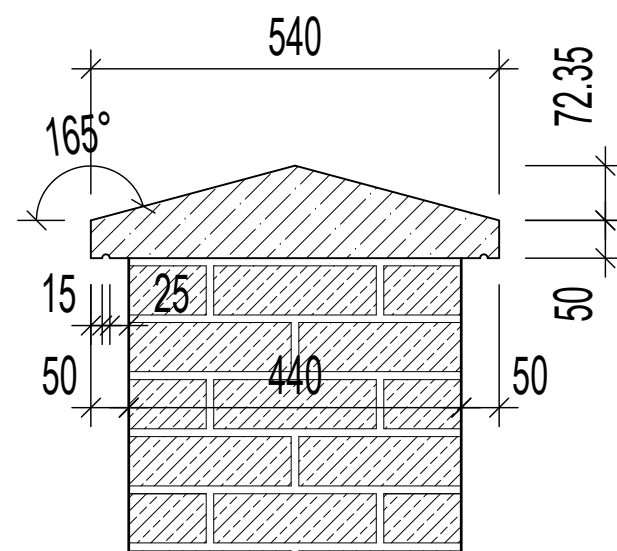

SECTION THRO' PIER
1:10 scale

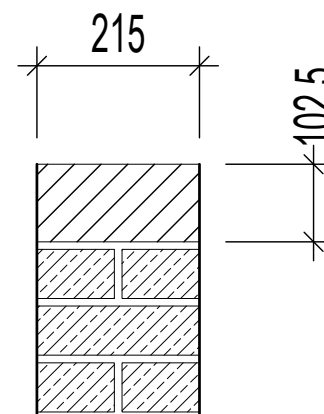

SECTION THRO' WALL
1:10 scale

Rev.	Date	Description	Initials



PERSIMMON

Persimmon Homes Lancashire
Persimmon House
Lancaster Business Park
Caton Road
Lancaster LA1 3RQ
Tel: 01524 542000 Fax: 01524 542001

SITE

TITLE
1.8M HIGH BRICK SCREEN
WALL DETAIL
(Artstone Piers)

SCALE 1:20@A3 DATE MAR 2018

NUMBER SDW08/04 REVISION